

DISCOVERY 4

QUICK START GUIDE

VEHICLE ACCESS	2
DRIVER CONTROLS	3
COMFORT ADJUSTMENTS	4
CLIMATE CONTROL	6
ENGINE START	7
WARNING LAMPS	8
TRANSMISSION	10
CRUISE CONTROL	10
AIR SUSPENSION	11
TERRAIN RESPONSE	11
AUDIO SYSTEM	12
NAVIGATION	14
BLUETOOTH TELEPHONE	15
FILLING STATION INFORMATION	16





SOME OF THE FEATURES DESCRIBED MAY NOT APPLY TO YOUR VEHICLE.
REFER TO THE OWNER'S HANDBOOK FOR FULL OPERATING INSTRUCTIONS.





Discovery 4 Smart Key

-  Press once to lock the vehicle and arm the alarm.
- Press twice to double lock the vehicle.
- Press and hold to close any open windows and lock all doors (Global closing).

-  Multi-point entry - Press once to disarm the alarm, unlock the doors and unlock the luggage compartment.
- Press and hold to unlock all doors and open the windows (Global opening).

-  Press once to switch the headlamps on for 25 seconds. Press again to switch off.

-  Press to disarm the alarm, unlock and release the tailgate.

-  Press and hold for three seconds to activate/cancel the panic alarm.

Unlocking mode alternatives

Single-point entry allows only the driver's door to unlock with a single press. A second press unlocks all other doors and luggage area.

Multi-point entry will unlock all doors and luggage area with a single press.

To change between modes, with the vehicle unlocked, press the lock and unlock buttons simultaneously for three seconds. The hazard warning lamps will flash to confirm the change.

Emergency key access

Press the release button then slide out the side section and pull up the keyblade.



Unlocking with the emergency key

Turn the key in the driver's door lock towards the front of the vehicle to unlock the door and disarm the alarm system. Turn the key a second time to unlock all other doors.

If the vehicle was previously locked using the Smart Key and the door is then unlocked with the emergency key, the alarm will sound when the door is opened. Press the unlock button on the Smart Key to disarm the alarm.

Operating note

If the Smart Key fails to operate, hold it under the steering column in the indicated position to disarm the alarm. Start the engine as normal (see page 7). The Smart Key can now be removed.



Central door locking

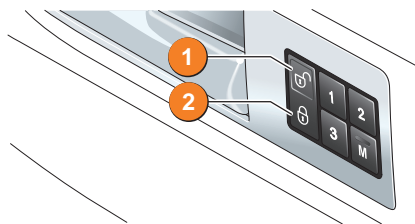

1. Press to unlock all the doors. This will not enable the alarm.
2. Press to lock all doors and tailgate.

Operating note

If the vehicle has already been locked with the Smart Key the master locking switch will not release the locks.

Speed related locking

If enabled, all apertures will automatically lock when the vehicle speed exceeds 8 km/h (5mph).

This feature can be turned on or off in the **Settings** option accessed via the trip computer.

Driver controls

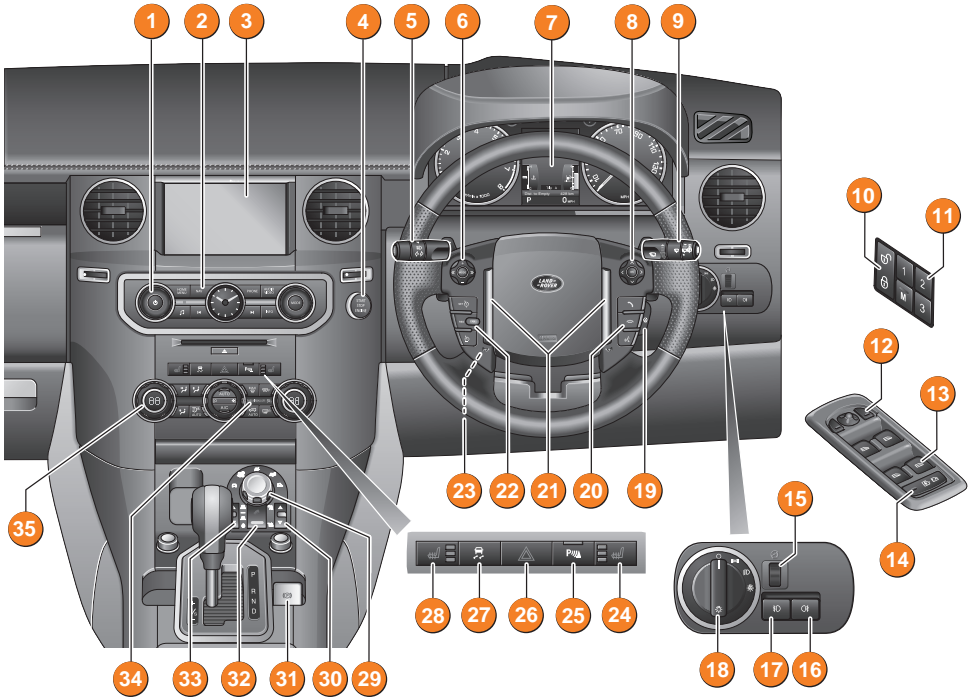

1. Audio system
2. Navigation system
3. Touch screen
4. Starter
5. Headlamps, direction indicators and trip computer
6. Audio controls
7. Instrument pack, warning indicators and message centre
8. Settings menu control
9. Wipers and washers
10. Master locking switches
11. Memory seat controls
12. Mirror controls
13. Window controls
14. Rear window isolator switch
15. Instrument illumination
16. Rear fog lamps
17. Front fog lamps
18. Exterior lamps master switch
19. Heated steering wheel switch
20. Telephone and voice recognition controls
21. Horns
22. Cruise control switches
23. Steering column adjuster
24. Heated seat - right side
25. Parking aids switch
26. Hazard warning switch
27. Dynamic Stability Control
28. Heated seat - left side
29. Terrain Response control
30. Transfer gearbox control
31. Electric parking brake
32. Hill Descent Control
33. Air suspension control
34. Passenger airbag status indicator
35. Climate control

Comfort adjustments

Seat adjustment

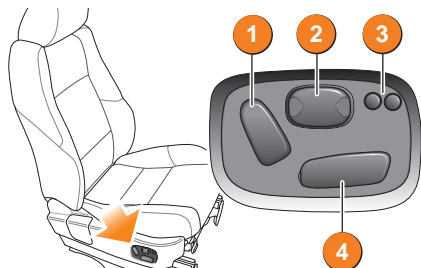

Power seats

1. Seat back angle.
2. Lumbar support.
3. Bolster inflate/deflate.
4. Seat forwards and back, cushion height and cushion angle.

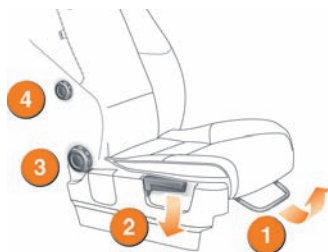

Manual seats

1. Seat forwards and back.
2. Cushion height.
3. Seat back angle.
4. Lower backrest lumbar support.

Steering column adjustment

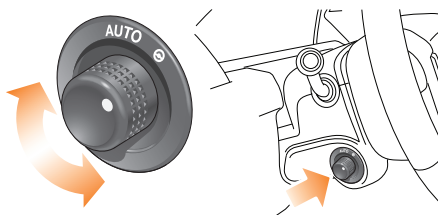

The steering wheel position can be adjusted in four directions, corresponding with the movement of the adjustment control.

With the vehicle stationary, rotate the control clockwise then adjust the steering column to your ideal driving position.

Return the control to the **AUTO** position.

Driving position memory

Your ideal driving positions for driver's seat, steering column and exterior mirrors, can be stored in vehicle memory for future use.

1. Press the **M** button to activate the memory store function. The button will illuminate to indicate that the memory store function is active.
2. Within 5 seconds press button **1**, **2** or **3** to store the current driving position to the chosen number. An existing setting on that button will be overwritten.

A stored memory position can now be recalled with a press of the appropriate button; **1**, **2** or **3**. The seat, steering wheel and mirrors will move to their preset positions.



Operating note

Buttons **1**, **2** or **3** must be pressed within five seconds after pressing the **M** button otherwise the memory store function will cancel.

Electric windows

Firmly press or lift the respective window switch and release it. Movement can be stopped by briefly operating the switch again.

When the rear window isolator switch is pressed an indicator lamp illuminates in the switch.

Resonance with lowered windows

If a resonance/booming sound occurs when a rear window is open, lowering an adjacent front window about 25 mm (1 inch) will eliminate the condition.

Comfort adjustments

Door mirrors

Adjusting the position

1. Press the **L** or **R** button to select the relevant mirror.
2. Use the mirror adjuster to set mirror position.

Powerfold door mirrors

Press the **L** and **R** buttons simultaneously to fold the mirrors back. Press again to return the mirrors to the opened position.

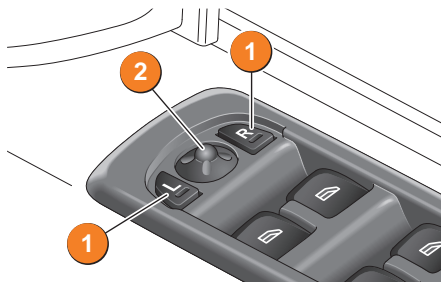

Seat belts and child restraints



A warning indicator on the instrument pack will illuminate if a front seat belt is unbuckled. This may be accompanied by an intermittent chime.

Child seats

It is a child's weight, rather than age, that determines the type of seat that is required.

Refer to **Child Restraints** in the Owner's Handbook to determine the correct seat for your child.

Passenger airbag deactivation

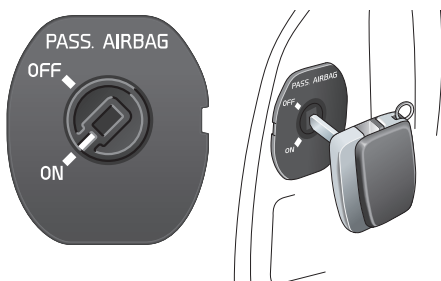

If it becomes necessary to fit a child restraint on the front passenger seat, the passenger airbag must be deactivated.

To deactivate, open the front passenger door and use the emergency key to turn the **PASS.AIRBAG** switch at the end of the fascia to the **OFF** position.

The status indicator in the centre console will be illuminated while the ignition is on.

Operating note

When an adult or a child over 12 years is seated in the front passenger seat, ensure the **PASS.AIRBAG** switch is turned to the **ON** position.

Clock setting

From the **Home** screen, select **System Settings**. Touch the **Clock** icon to access the **Set Clock** screen.

Use the scroll controls to set the time then press **OK**.

All clocks are synchronised.

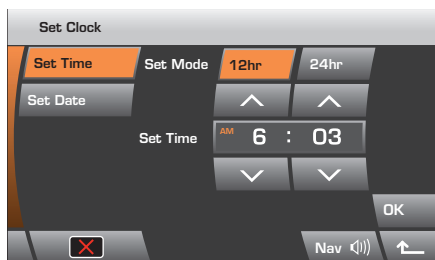

Climate control

AUTO is the recommended operating mode. This will help prevent misting.



AUTO (automatic) mode

Press for automatic operation of the climate control system. The climate control will adjust the air conditioning, blower speed, air intake and airflow distribution to maintain the selected temperature(s).



Temperature control

Rotate the controls to set the required temperature.

Operating note
The automatic system allows a temperature differential of up to 4°C (7°F) between left and right passenger areas.



Blower Control

Rotate clockwise to increase and counterclockwise to decrease airflow from the vents.



A/C

Press to switch air conditioning off.

Air distribution - auto system



1. Face level
2. Front screen and side window vents
3. Foot level

The automatic system allows more than one setting to be selected at once.



Programmed defrost

Fastest method to remove frost or heavy misting from the front screen. Press AUTO to switch off.



Recirculation

- Press once to automatically restrict ingress of traffic fumes.
- Press twice for manual recirculation control. Extended use causes screen misting.
- Press again for normal operation.



Heated front screen



Heated rear screen



Front seat heaters

Press once for high level heat, twice for low level and a third time for off.



Rear environment

- Press once for rear heating and air conditioning.
- Press twice to allow rear passenger control.
- Press again to switch off.

External water deposits
The air conditioning system removes moisture from the air and deposits the excess water beneath the vehicle. Puddles may form but this is normal and no cause for concern.

Engine start and stop

The **START STOP** button is operational only when the Smart Key is inside the vehicle.

Ignition only on:

- A single press of the **START STOP** button will switch on the ignition.
- A second press will switch off the ignition.

Engine start

- The selector lever must be in **P** or **N** position to enable engine starting.
- With the footbrake depressed, press and release the **START STOP** button to start the engine.
- Press again to stop the engine and switch off the ignition.

Diesel engine starting

In extreme low temperatures, there may be a delay of up to 12 seconds between the **START STOP** button being pressed and the engine cranking. Ensure the footbrake remains depressed. Do **NOT** press the **START STOP** button again. Cranking time will be increased.

Operating note

The **START STOP** button must be pressed to stop the engine. If not, it will continue to run even if the Smart Key is removed from the vehicle.

Instrument panel

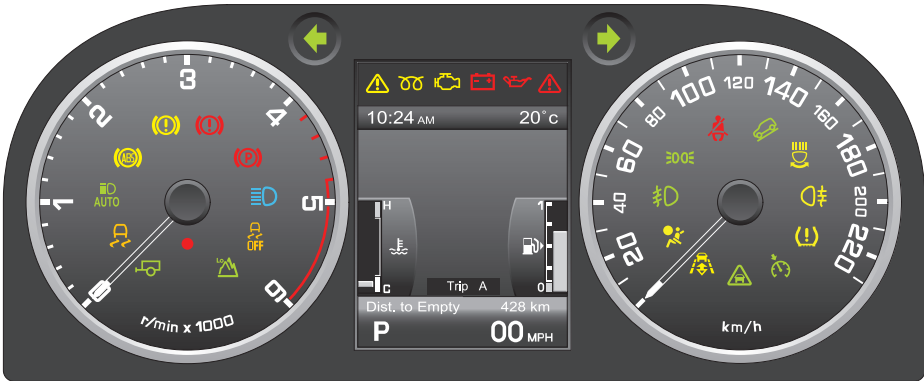

Driver information is displayed on the message centre panel and on the inner sections of the instruments.





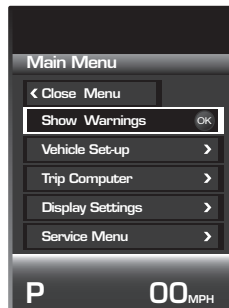





When the ignition is turned on, the instrument panel will progress through the initial start up display. Information symbols will illuminate while system checks are made.

To access the main menu in the instrument panel, press the **OK** button on the steering wheel control. Use the direction controls to move through the menu and subsequent options. Press **OK** to confirm your selections.



Warning lamps

The following will illuminate during normal driving to indicate that a related system or feature is operating. If any other warning lamp illuminates, refer to the Owner's Handbook.

	Seat belt reminder		HDC active		Side lamps on
	EPB on		LOW gear range selected		Headlamps high beam on
	Diesel glow plug		Cruise control active		
	Rear fog lamps on		Front fog lamps on		

Exterior lamps

1. Exterior lamps off.
2. Side lamps.
3. Headlamps.
4. **AUTO.** A sensor monitors the exterior light levels and will switch side lamps and low beam headlamps ON and OFF as required. A related sensor also controls the high beam assist when it is enabled. The high beam/low beam control must be in the low beam position and road speed above 40 km/h (25 mph).
5. Front fog lamps.
6. Rear fog lamps.

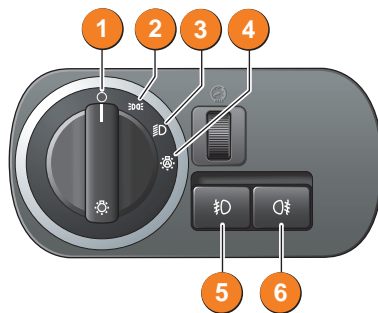

Wipers and washers

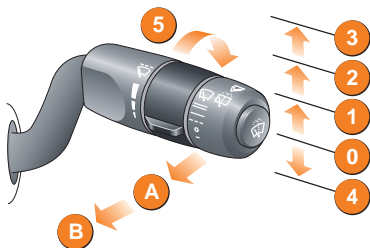

1. Intermittent wipe or rain sensor operation.
2. Normal speed wipe.
3. Fast speed wipe.
4. Single wipe.
5. Rotate collar to adjust speed of the intermittent wipe or sensitivity of the rain sensor.

Care point

Before entering an automatic car wash, turn the wipers off to deactivate the rain sensor. Otherwise, the wipers will operate during the car wash program and may be damaged.

Front screen washer and wiper

Press and release the end button to operate the front screen washer. Press and hold to operate both washer and wipers.

Rear wiper and washer

- A. Pull the lever to first position for intermittent wipe.
- B. Pull and hold the lever in position to operate both wiper and washer.

Headlamps and direction indicators

Headlamp high beam - Push the lever forwards to select headlamp high beam.

To flash headlamps, pull the lever part way towards the steering wheel and release.

Direction indicators flash - Move the lever up or down against spring pressure and then release to flash the indicators three times. Useful for lane changing.

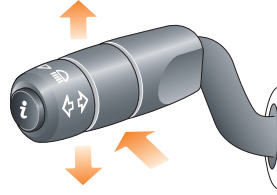

Electric parking brake

Applying

- With the vehicle stationary, pull up the parking brake lever and then release it. The red warning indicator in the instrument pack will illuminate.

The parking brake will apply automatically if the ignition is turned off and vehicle speed is below 3 km/h (2 mph).

Releasing

- With the ignition on, apply the foot brake and press down on the parking brake lever.
- If the vehicle is stationary and either **Drive** or **Reverse** is selected, pressing the accelerator will automatically release the parking brake.
- For manual transmission vehicles, automatic release can be affected in first, second and reverse gears. With low range selected third gear is also included.

Parking aids

With the ignition on, the parking aids are activated whenever reverse gear is selected. A short confirmation tone will sound after one second. If an obstruction is detected by the sensors, an intermittent tone will sound. As the vehicle moves closer to the obstruction the intermittent tone increases in frequency.

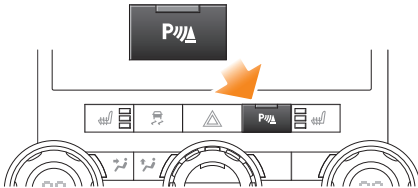

Manual control

Press the fascia switch to activate the front parking aid. The switch will illuminate and a short confirmation tone will sound.

Surround view camera system

The vehicle camera system consists of five cameras strategically located to aid vehicle positioning when manoeuvring at speeds below 18 km/h (11mph). When reverse gear is selected the touch screen displays a wide angle colour view of the area behind the vehicle. Guide lines are displayed to aid reverse turning.



Transmission

Gearshift interlock

To move the gear selector from **Park** position, the engine must be running, the foot brake applied and the selector release button 1 pressed in.

Automatic gear selection

Select **Drive** for fully automatic gear changes.

Sport mode

This is an automatic gear change mode, however, change points are modified to make full use of engine power.

Move the gear selector from **Drive** to the left side. The **M/S** LED, 2 will illuminate and the message centre will display **SPORT**.

To return to automatic gear selection, move the gear selector back to the **Drive** position.

CommandShift gear selection

This is an alternative to the fully automatic modes and is effective when rapid acceleration and engine braking are required.

With Sport mode selected, move the selector lever forward or back for manual gear selection. After each gear change the selector returns to the central position. The message centre will display the selected gear.

Transfer gearbox

Hi Use **HIGH** range for all normal road driving and also for off-road when driving across dry level terrain.

Lo **LOW** range should be used in situations where low speed manoeuvring is necessary, or in extreme off-road conditions.

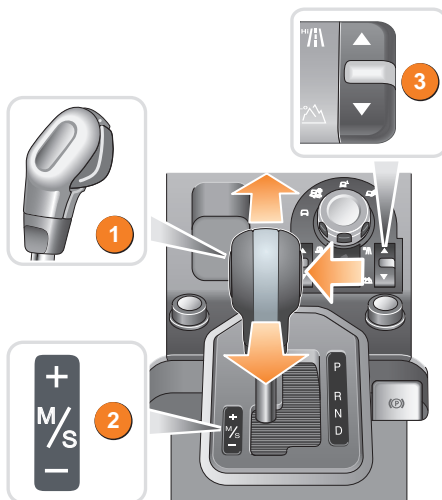

Range changing

The recommended method for range changing is with the vehicle stationary. With the engine running and the main gearbox in **Neutral**, move the rocker switch 3 to the required position and then release. The switch and instrument indicators will flash during a range change. When range changing is complete a chime will sound and a message will be displayed on the message centre.

Cruise control

1. Press to activate cruise control and to set a speed or increase the speed in 2 km/h (1mph) increments.
2. Press to resume previous set speed retained in memory. Set speeds are cleared at ignition off.
3. Press to cancel cruise control.
4. Press to decrease the speed in 2 km/h (1mph) increments.

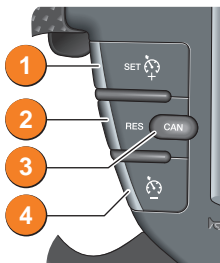

Cruise control override

Cruise control will disengage if the brake or clutch pedal is pressed or when vehicle speed falls below 30 km/h (18 mph).

Suspension height

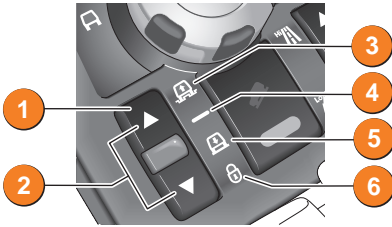

1. Raise/lower rocker switch. A height rise can be made only when the engine is running and all doors are closed.
2. Will illuminate while a height change is in progress.
3. Off-road height. Provides increased ground clearance.
4. On-road height. Normal ride height.

5. Access height. Lowers the vehicle to provide easier entry, exit and loading of the vehicle. This position may be selected up to 40 seconds after the starter switch is turned off. Can also be selected when slowing to a halt. When speed slows to 20 km/h (12 mph) the vehicle will begin to lower. Indicator lamps will extinguish when access height is reached.
6. Crawl(locked at Access height). Allows the vehicle to be driven at low speeds at access height, to give increased roof clearance.

Vehicle height will automatically adjust according to road speed to maintain optimum driveability and handling.

Some Terrain Response programs will adjust suspension height automatically.





Terrain Response system



Terrain Response is always active and cannot be switched off. When the vehicle is started the system will normally start in its **General** program.

Rotate the control to select a program. This will adjust vehicle systems, including drive and suspension, to enhance driveability and traction on specific surface conditions and terrains.

We recommend that a special program be engaged whenever driving conditions are difficult and cancelled once those conditions are no longer present.

-  **General** - Use for typical road surfaces.
-  **Grass-Gravel-Snow** - Suitable for surfaces which are firm but have a slippery surface, e.g. grass, snow, loose gravel, pebbles or icy conditions.
-  **Mud-Ruts** - Suitable for soft, muddy, uneven or deeply rutted ground. LOW range selection in the Transfer gearbox is recommended.
-  **Sand** - Suitable for soft, predominantly dry, yielding sandy ground, e.g. sand dunes and deserts. If the sand is damp or wet, the Mud-Ruts program may be more beneficial.
-  **Rock Crawl** - Only selectable when the transfer gearbox is in LOW range. Suitable for crossing wet or dry, solid unyielding ground requiring high levels of wheel displacement, e.g. clusters of boulders or rocky river beds.

Wading

Select the program most suitable for the surface beneath the water. DO NOT exceed 600 mm (24 inches) water depth.

In car entertainment system

The touch-screen requires only light touches. Excess pressure could result in damage.

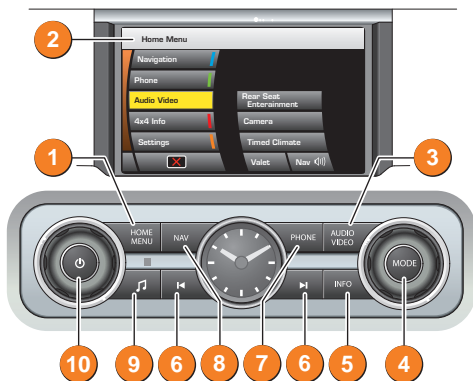

1. Press **HOME MENU** to display menu.
2. Touch screen Home Menu display.
3. Press for **AUDIO VIDEO** menu.
4. **MODE**. Press then rotate to select the required media.
5. Briefly press **INFO** to set Traffic information on or off. Press and hold to set News Information.
6. Press the search buttons to scroll through preset radio stations or to skip CD/MP3 tracks.
7. Press for **TELEPHONE** menu.
8. Press for **NAVIGATION** menu.
9. Short press to access sound settings. Long press to access volume offsets.
10. On/off and rotary volume control.

Steering wheel control

1. Press **MODE** repeatedly to access the Radio, DAB, CD, TV, DVD or AUX menu.
2. Press to increase volume.
3. Press and release to scroll forward through preset radio stations or CD/MP3 tracks. For DVD movies and TV it will move up to the next chapter or preset channel. Press and hold for two seconds to search up for the next radio station or to advance through the CD/MP3 track. For DVD movies it will fast forward the movie.
4. Press to decrease volume.
5. Has the same action as 3 but moves in the opposite direction.

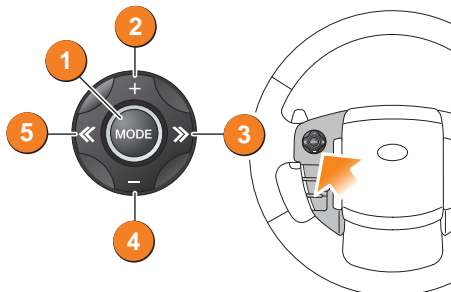

Radio operation



1. Turn on the audio system.
2. Press the **AUDIO VIDEO** button to display the menu or if the **Home** menu is active, touch the **Audio Video** screen button.
3. Touch the **Radio** screen button.

4. To change between AM, FM and LW, touch the **Band** screen button.
5. Use the autostore button **FMA** or **AMA** to find stations with the strongest signals or use the search buttons to find particular stations.
6. Press the **Settings** button to access the sound settings screen.

Storing radio stations

Autostore will automatically store the 9 strongest signals. Repeat this process for all wavebands.

To manually store a radio station, first tune to the required station. Decide which of the pre-set buttons the station is to be stored on and press that button for two seconds. The audio will mute and the selected button will display either the channel name or its frequency. The selected station will resume play.

In car entertainment system

DAB (Digital Audio Broadcasting) radio

DAB radio offers a greater range of channels than analogue radio. Because of this much greater choice, channels are grouped into categories called 'Ensembles'. Each channel may also have associated subchannels but these tend to be available only at certain times of the day.

Selecting DAB radio

1. Touch the **DAB** screen button.
2. To build a new list of available digital ensembles and channels, first touch the **DAB search** button then **Auto-tune**. The search may take up to a minute to find all available frequencies.



3. Available channels will be displayed. Use the vertical scroll feature to view further choices down the alphabetical list.
4. Select a channel to begin play. If the channel has subchannels, the **Subchannel list** button will become available.
5. To view those subchannels, touch the **Subchannel list** button. If desired, touch a subchannel button to begin play.

Note: Subchannels are temporary channels and may be discontinued at any time.

At any time you can return to previous screens by using the back button at the bottom right of the screen.

Storing a channel

Select a DAB channel. Return to the preset buttons screen. Decide which button the channel is to be stored on and press it for two seconds. Audio will mute and the selected button will display the channel name. The selected channel will resume play.

Up to six channels can be stored on each of **DAB1**, **2** and **3**.

CD operation

Incompatible disc types

The use of discs with paper labels or dual format discs (Dual Discs or DVD Plus) should be avoided as they could become jammed inside the player.

Playing CD/MP3 discs

Select **CD** from the **Audio Video** menu. The system will prepare the loaded disc for play. Playback can be paused by touching the **||** button. Press again to resume playback.

When an MP3 disc is selected, the folder information is displayed in an additional information window. To scroll through a folder, touch the movement icons either side of the window.



CD selection

Touch the appropriate CD icon **1** to **6** to select the disc. Once selected, play will commence.

Touch-screen navigation

The screen requires only a light touch to operate the function. Excess pressure could result in damage. On initial activation, ensure that both the correct country and area have been selected. For more information refer to the Owner's Handbook.

Setting a destination

1. From the navigation **Menu** screen, select **Destination Entry**.
2. Touch either **Address** or **Postcode**.
3. With **Address** selected, touch **Town** then use the on-screen keypad to enter address details. As each part of the address is displayed, select from the list to confirm. With **Postcode** selected, use the keypad to enter a postcode. Use the long spacebar to enter any required spaces.
4. When entry is complete, touch **OK**.
5. Touch **Destination** to begin calculation of the route options.
6. The screen displays **Route 1**. To view alternative routes touch **3 Route**. To use an alternative route, touch one of the selections.
7. Touch **Start** to commence guidance.

The selected route will be displayed and guidance will begin. When your destination is reached, voice and visual confirmation is given.

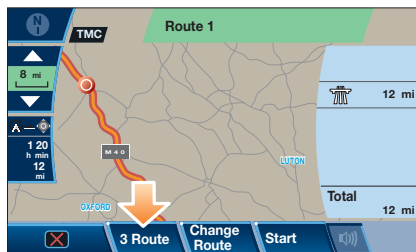
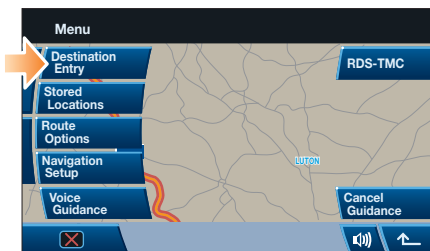

 If the map is moved away from your current location, the position icon will be replaced by a touch button in the top left of the screen. Touch to bring the current location map back into view.

 Touch this icon to repeat the last voice instruction. To deselect voice guidance go to the navigation **Menu** screen then select **Voice Guidance**. Touch the same softkey to turn voice guidance on again.

Cancelling guidance

To cancel guidance, touch **Menu** then **Cancel Guidance**.

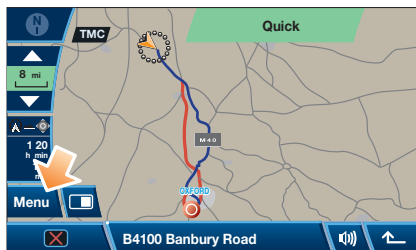

Bluetooth® phones

Compatible Bluetooth phones can communicate with the vehicle's inbuilt telephone system. Connection must be made with ignition on or engine running.

Use the following procedure in conjunction with your Bluetooth phone manufacturer's instructions.

Operating note

'Docking' and 'docked' are terms used in relation to a paired phone that is fully linked to the vehicle system and can be used for calls. The phone is not physically docked in a cradle.

Bluetooth selection

When the starter is turned on, the vehicle searches for up to 5 previously paired phones, starting with the most recent pairing.

Before attempting anew pairing, wait for 30 seconds for this process to complete.

Pairing a mobile phone to the vehicle

With the ignition on, touch-screen active and no phone currently docked:

1. Start the Bluetooth search function on your mobile phone.
2. The phone will list any Bluetooth devices found. Select **Land Rover** from the list.
3. Now enter the Bluetooth PIN **2121** into the mobile phone.

The phone will pair and dock to the vehicle system.

Mobile phone auto connect

The phone may request 'set authorisation' or 'always allow'. If this is set the phone will subsequently connect automatically.

Downloading phonebook entries

When a phone with phonebook download capability is paired and docked, its phonebook directory will automatically download to the vehicle system.

The vehicle phonebook will be updated each time a mobile phone is docked to the system.



Bluetooth phone compatibility

For the latest list of compatible phones and their software, refer to <http://www.landrover.com>. Select **OWNERSHIP** then **Bluetooth**.

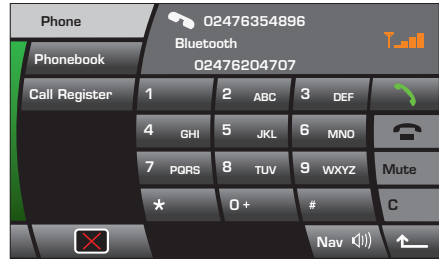
Calls via the touch-screen



Making a call

1. With a paired and active phone press the **PHONE** button on the screen surround.
2. Enter the number using the on-screen keypad.
3. Touch  icon on the screen to make the call.
4. To end a call touch .

Calls via the steering wheel controls



1. Use a short press to redial the last number. A long press will access phonebook information in the instrument pack menu.
- 2 and 3. Use the toggle controls to scroll through the phonebook until the required contact is highlighted. Press **1** again to dial the selection.
4. Press to end a call.

Telephone echo

If echo is experienced when using the phone, reduce the audio system volume during the call.

Filling station information

Fuel filler cap location



A small arrow on the fuel gauge indicates which side the fuel filler flap is located.

Fuel filler flap opening



The fuel filler flap can be opened only when the vehicle is unlocked. Press the fuel filler flap to open.

Operating note

The fuel flap has a spring loaded self release mechanism. Do not pull it open.

Operating the filler cap

Twist the cap counter-clockwise to undo.

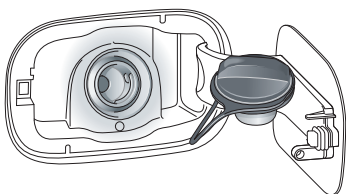

A hook is provided on the flap hinge to hold the cap whilst refuelling. After refuelling, tighten the cap until it clicks three times.

Fuel specification

The correct fuel specification for your vehicle is shown on the inside of the fuel filler flap.

Incorrect fuelling

Do not use E85 fuels (85% Ethanol content). Equipment necessary for the use of fuels containing more than 10% Ethanol is not fitted to this vehicle. If E85 fuels are used serious engine and fuel system damage will occur.

Do not use RME (bio-diesel) except in the case of those proprietary diesel fuels which contain a mix of up to 5%. Land Rover can accept no responsibility for damage caused by using RME in concentrations greater than 5%.

For diesel vehicles, use diesel fuel to specification EN 590 with a maximum bio diesel mix of 5%.

Filling with the wrong fuel

If the vehicle is filled with the wrong type of fuel:

- DO NOT start the engine!
- Call for qualified assistance!

Diesel misfuelling prevention

To help protect against a diesel fuel tank being accidentally filled with petrol, a prevention device is fitted in the filler neck. It will activate if the wrong type of fuel nozzle is fully inserted. The narrow fuel nozzle associated with unleaded petrol pumps will cause a flap to close and so interrupt fuel flow.

The yellow flap will be visible in the filler neck and must be reset with the correct tool, stored with the vehicle tool kit. Refer to the **Fuel and refuelling** section in your Owner's Handbook for further details.

Bonnet release

The bonnet release is located in the left hand side footwell.

Tyre pressure label location



Tyre pressures are shown on a label attached to the pillar behind the driver's door or to the rear of the driver's door.