

# SALEM HEMISPHERE LITE

TRAVEL TRAILERS AND FIFTH WHEELS



**SETTING THE BAR ON VALUE WITHOUT COMPROMISE**





SALEM  
HEMISPHERE  
LITE

*"We didn't realize we were making memories, we just knew we were having fun."  
Will, age 11*



---

HEMISPHERE RECREATIONAL VEHICLES ARE ABOUT  
INTELLIGENT DESIGN, SUPERIOR CRAFTSMANSHIP,  
QUALITY COMPONENTS AND RESIDENTIAL FINISHES.  
**BUT MOST IMPORTANTLY THEY ARE  
ABOUT FAMILY FUN.**

---





# HEMISPHERE TRAVEL TRAILERS

# 272RL



AMARETTO DECOR



272RL Kitchen and Entertainment Center (Shown with optional residential refer)



272RL Bedroom (Shown with optional TV)



311QB Exterior Kitchen (Optional)

## OUTDOOR COOKING

THE EXTERIOR KITCHEN OPTION IS AVAILABLE ON SELECT MODELS OF BOTH FIFTH WHEELS AND TRAVEL TRAILERS AND FEATURES:

- PRESSED METAL COUNTERTOP AT LOW, WORKABLE HEIGHT
- HUGE CABINETS FOR STORAGE
- LARGE MINI FRIDGE
- HIGH RISE FAUCET WITH HOT AND COLD WATER
- DEEP BOWL SINK WITH PLUMBING TO ADDITIONAL ENCLOSED GREY TANK
- CONVENIENT 110V OUTLET
- BUMPER MOUNTED, SWING ARM GAS GRILL WITH LP HOOK UP





# HEMISPHERE TRAVEL TRAILERS

# 312QBUD



AMARETTO DECOR

312QBUD Back to Front View (Shown with optional residential refer)



312QBUD 74" Jumbo Dinette



312QBUD Bunkroom (Shown with optional TV and jiffy sofa)

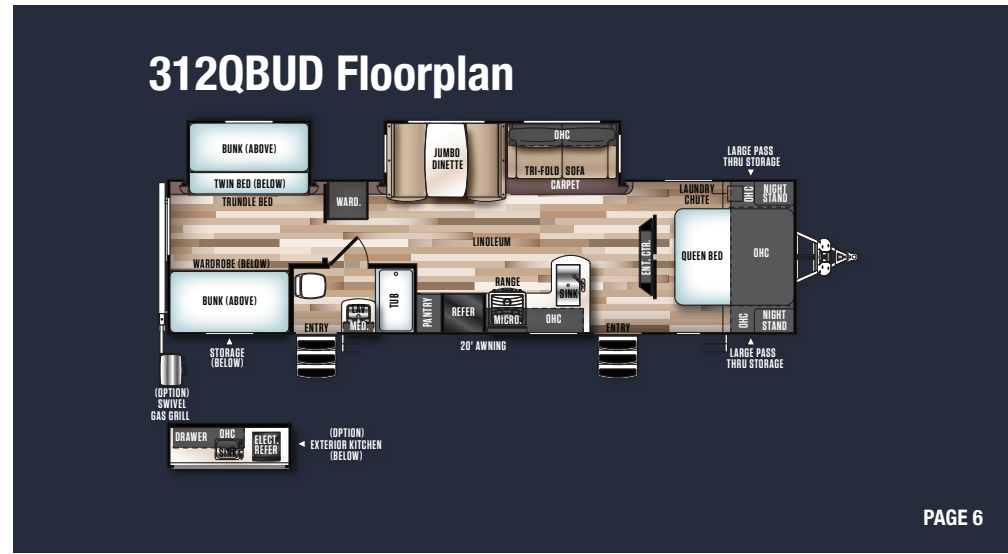



# HEMISPHERE FIFTH WHEEL SERIES

# 356QB



AMARETTO DECOR

356QB Front to Back View







HEMISPHERE FIFTH WHEEL SERIES

337BAR



STERLING DECOR

337BAR Front to Back View



337BAR Master Suite (Shown with optional TV)

## 337BAR Floorplan



337BAR Kitchen Area (Shown with optional residential refer)



337BAR Bathroom

# 15 FANTASTIC FEATURES



High rise faucet with pullout sprayer



Radius edge LG® solid surface kitchen countertops with LED lighting



Jumbo booth dinette with real wood top

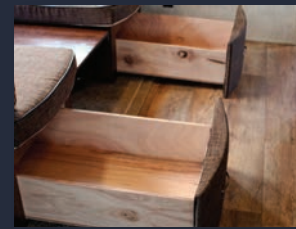

Extra large pot and pan drawers at the dinette base



Convenient laundry chute directly to pass thru storage



Residential curtain rods with premium window treatments



Residential bedding collection



Tri-fold, E-Z set up sleeper sofa



Painted gel coat fiberglass front cap with light strips on Life Series Travel Trailers and Fifth Wheels, won't fade, chalk or crack



Standard exterior TV bracket on every Hemisphere



Wide track suspension (travel trailers only) with aluminum rims



Docking station with quick winterization feature (fifth wheels only)



Blue LED lighted marine grade exterior speakers



One touch electric awning with "Quick Pitch"



Heated and enclosed underbelly



# LIMITED EDITION PACKAGE



**FURRION BACK UP CAMERA PREP**



**FURRION SOLAR PANEL PREP**



**FURRION CD/DVD/FM/USB PLAYER W/ BLUETOOTH**



**STAINLESS STEEL, SINGLE BOWL, UNDERMOUNT SINK**

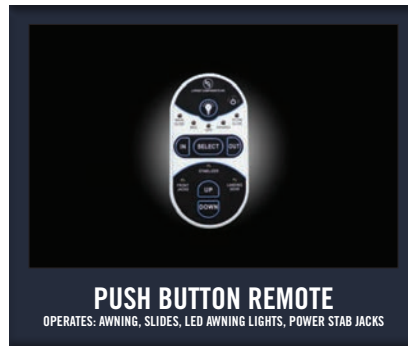

**PUSH BUTTON REMOTE**  
OPERATES: AWNING, SLIDES, LED AWNING LIGHTS, POWER STAB JACKS

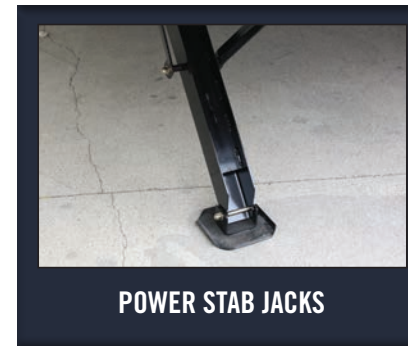

**POWER STAB JACKS**



**RECESSED STOVE WITH GLASS STOVE COVER**

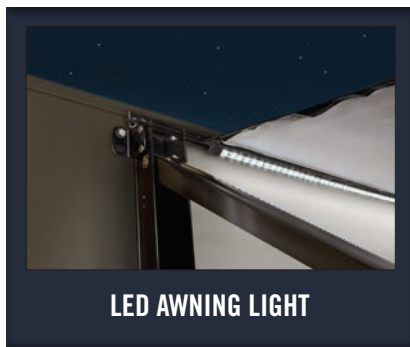

**LED AWNING LIGHT**



**LED INTERIOR LIGHTS**



**POWER TONGUE JACK**  
POWER TONGUE JACK IS NOT INCLUDED ON 5TH WHEELS



**LED COUNTERTOP LIGHTS**



The Salem Hemisphere has a Welded Aluminum Superstructure that is regarded as the Industry's finest,



# HYPER-LYTE CONSTRUCTION

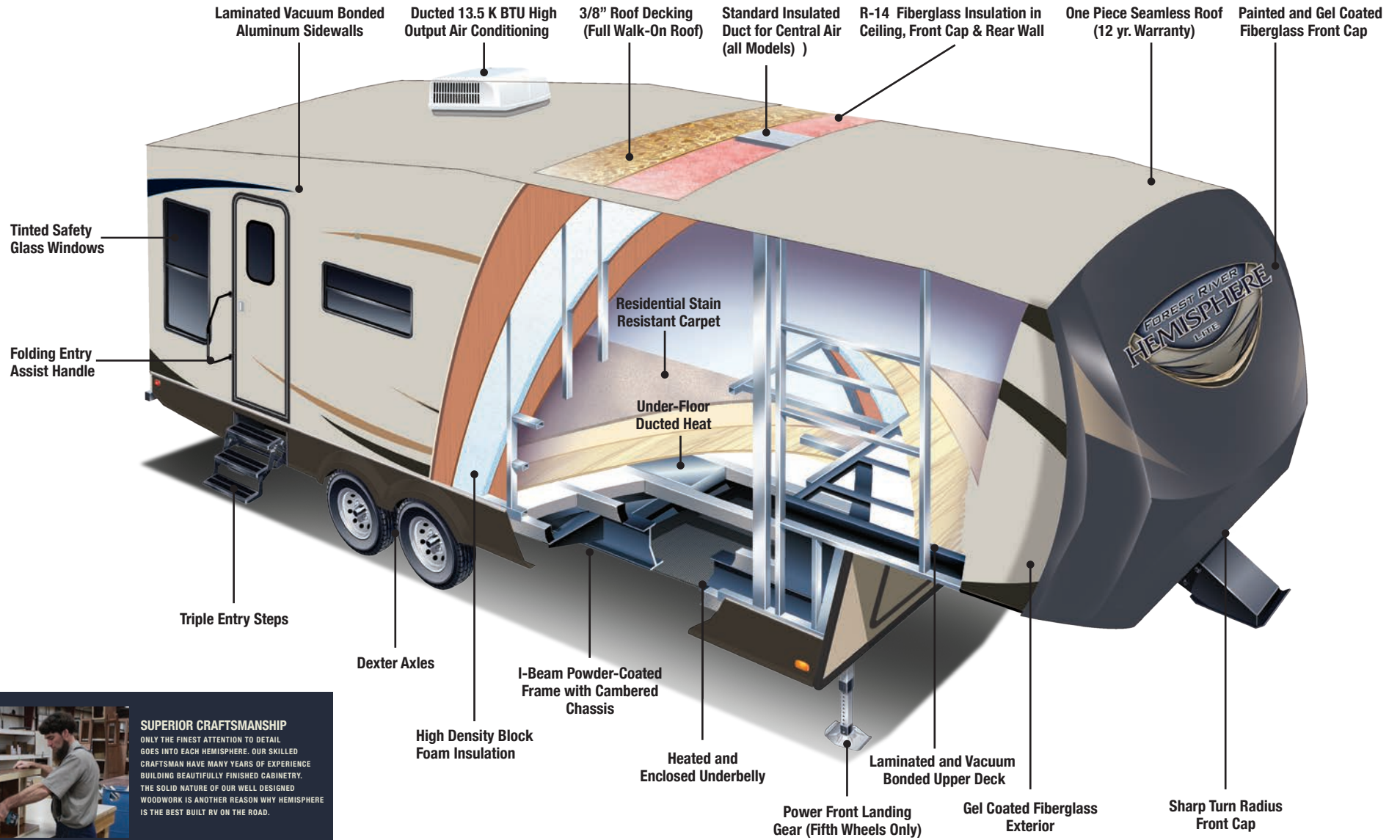

**SUPERIOR CRAFTSMANSHIP**  
 ONLY THE FINEST ATTENTION TO DETAIL GOES INTO EACH HEMISPHERE. OUR SKILLED CRAFTSMAN HAVE MANY YEARS OF EXPERIENCE BUILDING BEAUTIFULLY FINISHED CABINETRY. THE SOLID NATURE OF OUR WELL DESIGNED WOODWORK IS ANOTHER REASON WHY HEMISPHERE IS THE BEST BUILT RV ON THE ROAD.

# HEMISPHERE SERIES STANDARDS AND OPTIONS

## HEMISPHERE CONSTRUCTION/ EXTERIOR FEATURES

- Dexter Axles (5 yr. warranty) w/ 15" Radial Tires (16" on Select Models) & Aluminum Wheels
- Painted Fiberglass Front Cap
- Aerodynamic Travel Trailer & Fifth Wheel Front Cap w/ LED Light Strip(s)
- Wide Track Suspension (Travel Trailers)
- 3 Sided Aluminum-Framed Vacuum-Bonded Construction
- Gel Coated Fiberglass Exterior
- Laminated Sidewalls
- Laminated Floor w/ In-Floor Heat
- 6'5" Full Walk-In 5th Wheel Slide-Outs (N/A bed slides)
- One Level, Full Stand-Up Height 5th Wheel Upper Decks
- 30" Smooth Fiberglass Radius Main Entry Door (26" secondary)
- Swing Arm Entry Assist Handle
- Extra Large Full Pass-Thru Storage (per floorplan)
- One Touch Electric Awning w/ Adjustable Legs (1 year warranty)
- Marine Grade Exterior Speakers w/Blue LED Light
- Exterior TV Bracket w/Cable and Power Outlet
- Upgraded ABS Fender Skirts
- Grab Handle at 5th Wheel Interior Steps
- Interior Grab Handle at Entry Door
- Powder Coated I-Beam Frame
- Cambered Chassis
- Water Heater By-Pass
- Fifth Wheel Docking Station
- Power Flush Floor Slide-Out Systems
- 16 Gal. per hour G/E Quick Recovery DSI Water Heater (2 year warranty)
- Stabilizer Jacks
- Backer for Rear Ladder
- One Piece Seamless Roof (12 Year Warranty)
- Full Walk-on Roof
- Power Front Landing Gear (5th Wheels)
- Tinted Safety Glass Windows
- Black Tank Flush

## KITCHEN

- LG® Solid Surface Countertops
- Stainless Steel Dometic® Double Door Refrigerator (2 Year Warranty)
- Residential, Under Mount Sink
- Decorative Slate Kitchen Backsplash
- Stainless Steel Microwave w/ Carousel (1 Year Warranty)
- High Rise, Pull-Out Sprayer Faucet
- Stainless Steel Vented Range Hood w/ Light
- Beau® Plank Wood Linoleum
- Solid Wood Drawer Fronts w/ Full Extension Ball Bearing Guides
- Solid Wood Raised Upper Panel Cabinet Doors

- Large Overhead Cabinets
- Wall-Mounted Systems Monitor Panel
- Satin Nickel Hardware
- Large Residential Pantry (Select Models)

## LIVING ROOM

- 13,500 BTU Ducted Roof Air Conditioner w/ Quick Cool (2 Year Warranty)
- Residential Stain Resistant Carpet
- Pushback Recliners (Per Floorplan)
- Theatre Seating w/ Built-In Recliners (Per Floorplan)
- Oversized Dinette w/ Large Pot and Pan Drawers (Per Floorplan)
- Deluxe Dinette Tabletop
- Solid Wood Drawer Fronts
- Jumbo 74" Dinette (Per Floorplan)
- Large Dinette Picture Window
- Winegard Digital TV Antenna
- Cable TV and Satellite Prep
- Extra Large Overhead Cabinets w/ Glass Inserts
- Decorative Dinette and Wall Light
- 30 or 35K BTU Suburban Forced Air DSI Furnace (2 Year Warranty) w/ Digital Thermostat
- Under Floor Heat Ducting
- Night Shades
- E-Z Setup Sleeper Sofa w/ Storage and X-Large Throw Pillows
- Laundry Hamper (Most Travel Trailers)
- 32" HD TV and CD/DVD/AM/FM w/ MP3 Hookup and Surround Sound
- Electric Fireplace (Most Floorplans)

## BEDROOM

- Custom King Bed in All Bedroom Slide Travel Trailers and Fifth Wheels
- Strut Lifted Storage Area Under Bed
- Huge Storage Drawers in Travel Trailer Bed Base (Most Models)
- Oversized Bunks w/Teddy Bear Bunk Mats (Per Floorplan)
- Solid Bedroom Privacy Doors
- Mirrored Wardrobes w/ Two Nightstands and Outlets (Most Travel Trailers)
- Full Length Wall Mirror (5th Wheel Bedrooms)
- Swing Arm TV Bracket (5th Wheel Bedrooms)
- Tall, 6 Drawer Dressers (Most 5th Wheels)

## BATHROOM

- 30" x 50" Walk-in Shower w/ Sliding Glass Door (5th Wheels)
- 12-Volt Power Bath Roof Exhaust Vent
- Wooden Medicine Cabinet w/ Mirrored Door
- Dometic® Foot Flush Toilet
- Tooth Brush Holder and Towel Ring
- Vinyl Tub Surround

## SECURITY AND SAFETY

- LP Leak Detector
- Smoke Detector
- Carbon Monoxide Detector
- Fire Extinguisher
- LED Hitch Light
- Welded Heavy Duty Safety Chains (Travel Trailers)
- Electric Brakes (all wheels)
- GFI Receptacles
- ANSI 119.2
- Certified to Meet National Highway Traffic Safety Administration Specifications

## HEMISPHERE OPTIONS

- Free-Standing Dinette w/ 4 Chairs
- Swivel Rocker Recliner (2)
- Living Room Ceiling Paddle Fan (5th wheels)
- Whirlpool® Residential Refrigerator w/ Inverter (All Models)
- Roof Ladder
- 15,000 BTU Ducted A/C w/ Quick Cool
- Outside Shower (Travel Trailers)
- 50 Amp Service
- Washer/Dryer Prep (5th Wheels)

Contact your Hemisphere dealer for a complete list of options.

## DECOR OPTIONS



AMARETTO DECOR

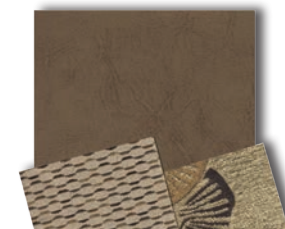

STERLING DECOR



## PREPARED FOR THE SEASONS

- HEATED AND ENCLOSED UNDERBELLY WITH UNDER-FLOOR DUCTED HEATING
- HIGH DENSITY, BLOCK FOAM INSULATION (SIDEWALL AND FLOOR)
- DOUBLE LAYERED FIBERGLASS INSULATION (ROOF, FRONT AND REAR WALL)
- HIGH EFFICIENCY AIR CONDITIONING SYSTEM WITH THICK, INSULATED DUCTING



# HEMISPHERE TRAVEL TRAILER SERIES FLOORPLANS

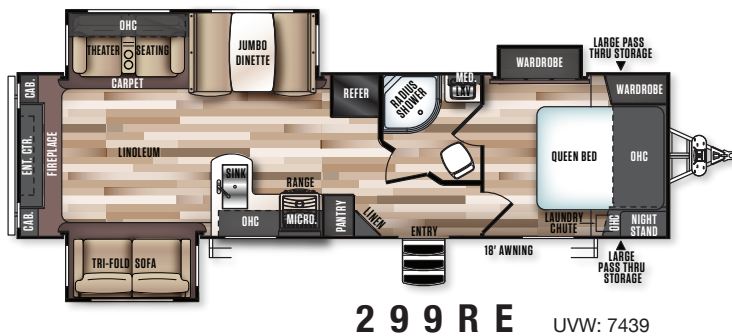
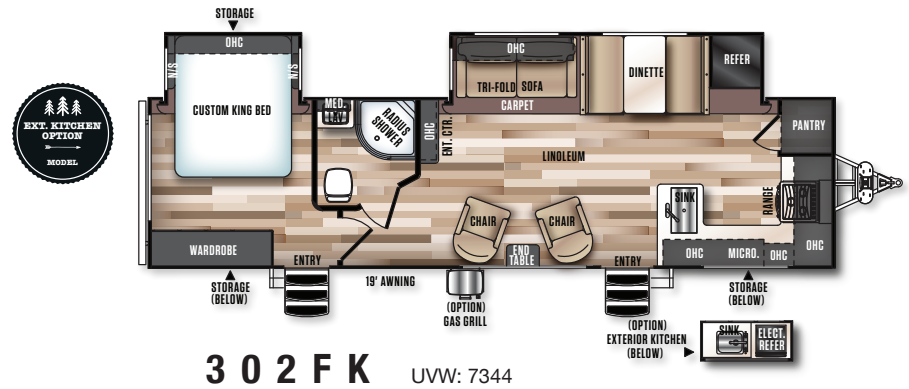
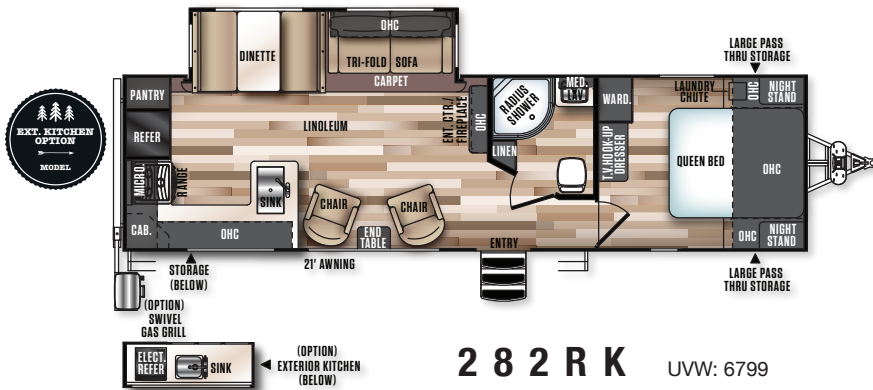
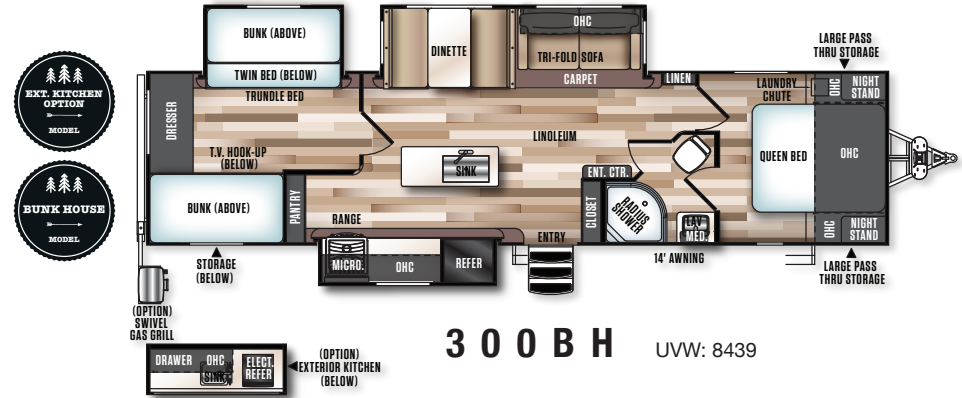
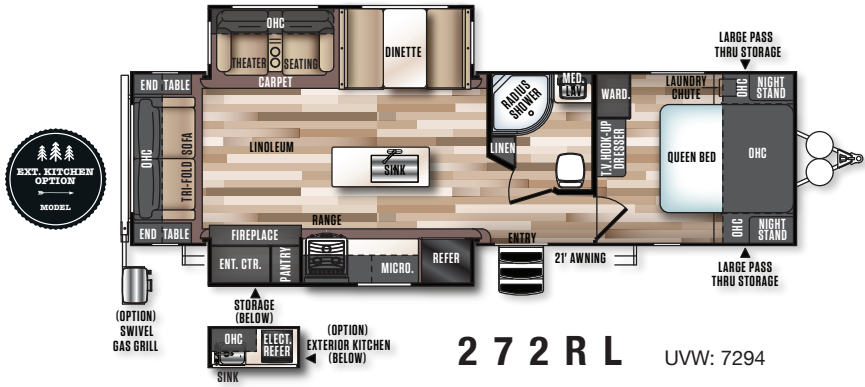



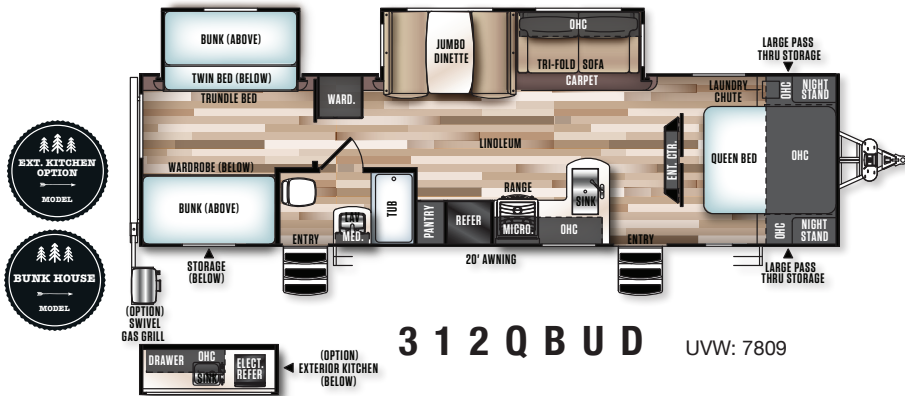
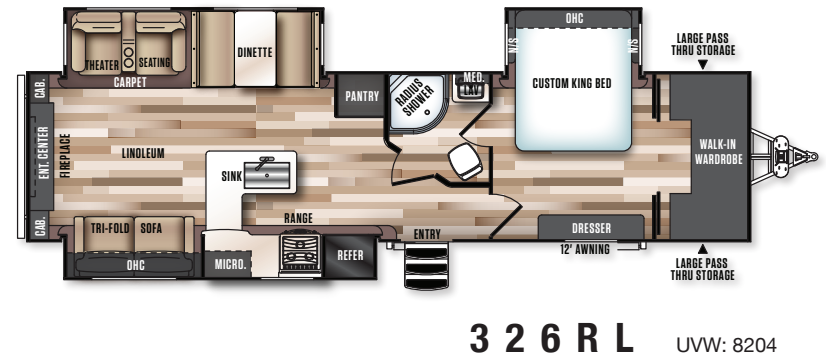
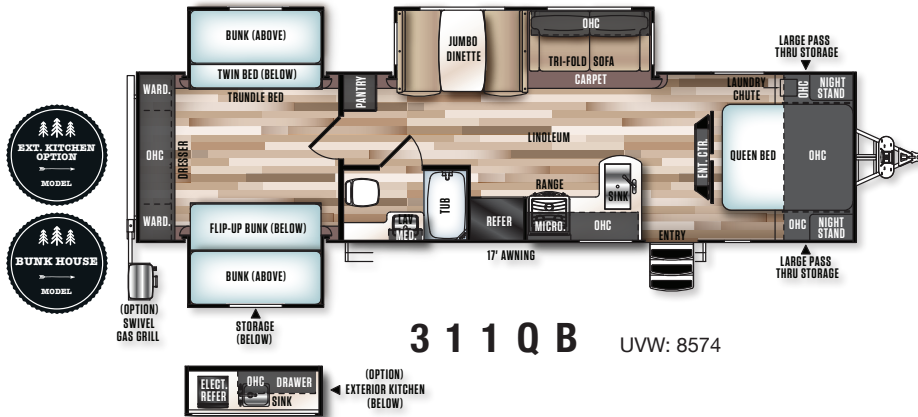

**S P E C I F I C A T I O N S**

MODEL	272RL	282RK	299RE	300BH	302FK	311QB	312QBUD	326RL
Hitch Weight (lbs)	845	700	730	570	1060	936	870	977
Axle Weight	6390	6040	6650	7810	6225	7579	6880	7277
UVW	7294	6799	7439	8439	7344	8574	7809	8204
CCC (cargo cap)	2351	2701	2091	2291	2516	2522	1861	2933
Ext Length	34'4"	35'	35'1"	37'5"	35'6"	37'6"	35'10"	37'10"
Ext Height	11'	11'	11'	11'	11'2"	11'	11'	11'
Fresh Water Cap (gal)*	54	54	54	54	54	54	54	54
Black Water Cap (gal)	30	30	30	30	30	30	31	30
Grey Water Cap (gal)	48	60	30	78	60	48	50	30
Tire Size (in)	15"	15"	15"	15"	15"	15"	15"	15"
Awning Size (ft)	20'	21'	18'	20'	20'	18'	18'	12'

See back cover for more information on weights. \*Includes water heater.

# HEMISPHERE FIFTH WHEEL SERIES FLOORPLANS

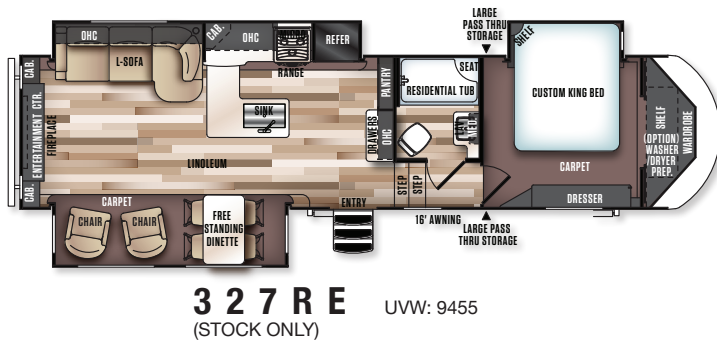
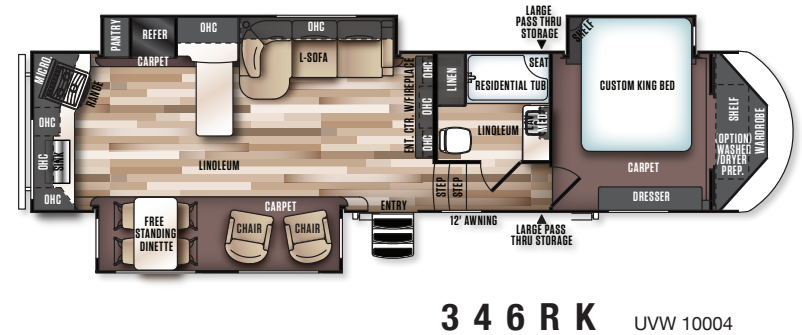
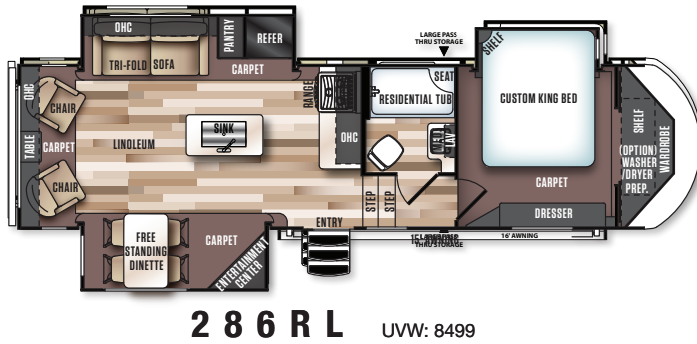
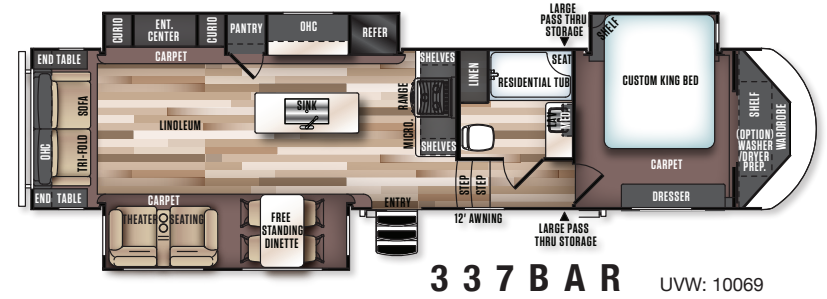
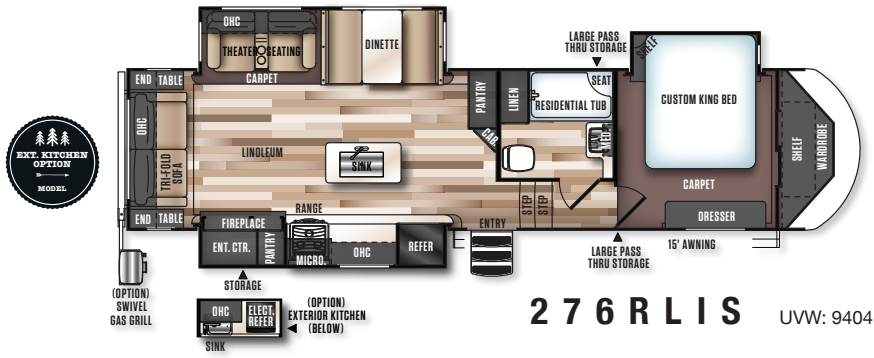

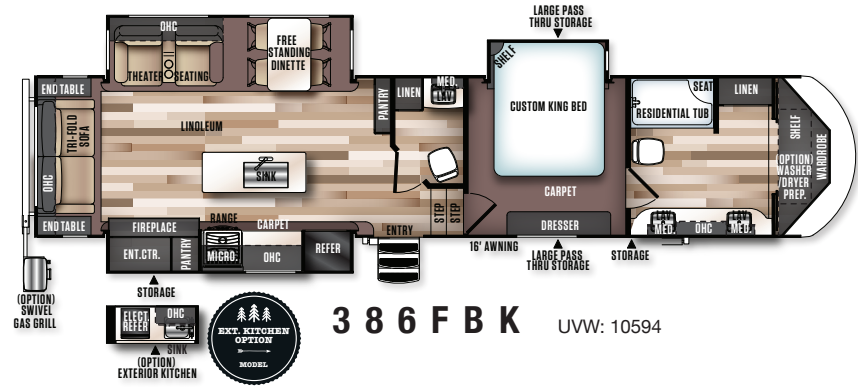
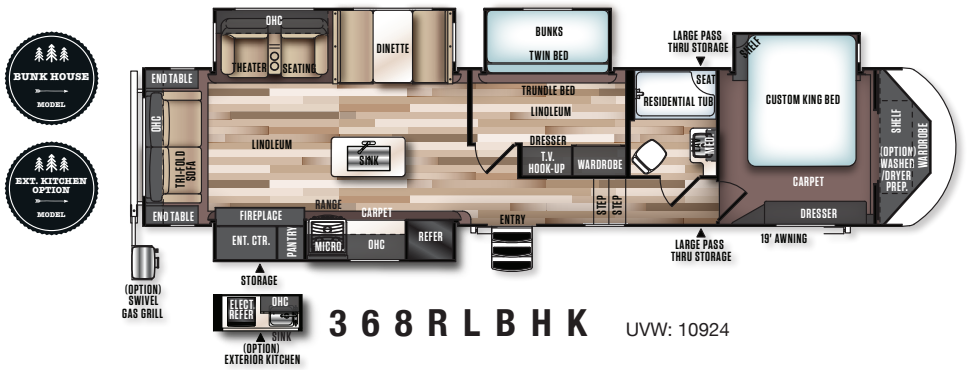
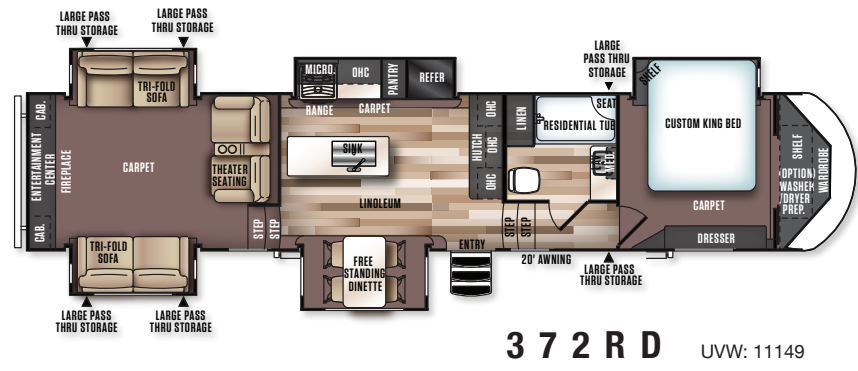
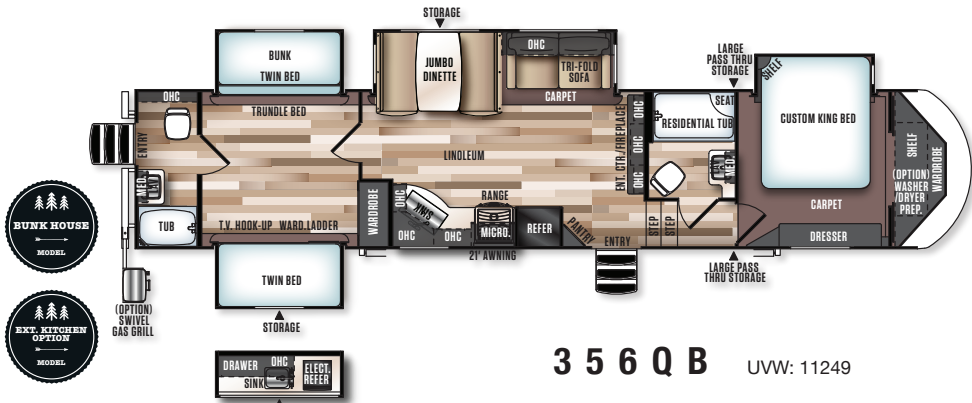

**SPECIFICATIONS**

MODEL	276RLIS	286RL	327RE	337BAR	346RK	356QB	368RLBHK	372RD	386FBK
Hitch Weight (lbs)	1795	1625	1795	1990	1840	1790	2080	2125	2040
Axle Weight	7550	6815	7690	8020	8105	9400	8785	8965	8495
UWW	9404	8499	9544	10069	10004	11249	10924	11149	10594
CCC (cargo cap)	2791	3286	2651	2321	2236	2541	3156	2976	3446
Ext Length	36'3"	34'1"	36'5"	39'7"	38'6"	42'3"	42'	43'0"	40'8"
Ext Height	12'10"	12'10"	13'	13'2"	13'2"	13'2"	13'2"	13'2"	13'2"
Fresh Water Cap (gal)*	54	54	54	54	54	54	54	54	54
Black Water Cap (gal)	30	30	30	30	30	60	30	30	60
Grey Water Cap (gal)	62	60	60	60	60	90	60	60	60
Tire Size (in)	16"	15"	16"	16"	16"	16"	16"	16"	16"
Awning Size (ft)	15'	16'	16'	13'	17'	21'	19'	20'	18'

See back cover for more information on weights. \*Includes water heater.



### PRE-DELIVERY INSPECTION FACILITY

20,000 square feet of quality assurance. The bare essentials for a premium product. This state-of-the-art facility gives immediate daily feedback to production for quality assurance in every unit built.



Forest River, Inc. encourages our customers to purchase their Forest River products from a local dealership whenever possible for the following reasons:

It is the goal of Forest River, Inc. that all of our RV owners fully enjoy the RV experience and that customer satisfaction meets or exceeds their expectations!

- 1) Forest River, Inc. dealers are independently owned and operated businesses so priority service and scheduling is at their discretion and is often provided to customers that purchased their unit at that dealership.
- 2) Purchasing locally allows customers to establish meaningful relationships with a dealer, enhancing the RV experience through assistance with product questions, user tips or RV regulations for your state or country, and much more!
- 3) Canadian customers must meet requirements to bring an RV purchased out of the country to their home. These requirements may involve additional inspections and certifications, taxes and fees. Your local Canadian Dealer is a professional at meeting these requirements.
- 4) Scheduling timely warranty repairs and adjustments through a local dealership provides far greater flexibility and convenience to you, the customer!

### 24/7 EMERGENCY ROADSIDE ASSISTANCE

For a worry-free ownership experience

Forest River includes one

year of Coach-Net RV Technical & Roadside

Assistance with each RV purchase. Whether

new to the RV lifestyle or an experienced RV enthusiast,

Forest River owners have 24/7 access to technical,

operational and emergency road service

coverage throughout the US & Canada.

Coach-Net's fast, dependable

service is just a phone

call away.

## Coach-Net®

RV Technical & Roadside Assistance

**FREE MEMBERSHIP**  
to Forest River Owners' Group



**GVWR (Gross Vehicle Weight Rating)** - is the maximum permissible weight of the unit when fully loaded. It includes all weights, inclusive of all fluids, cargo, optional equipment and accessories. For safety and product performance do NOT exceed the GVWR.

**GAWR (Gross Axle Weight Rating)** - is the maximum permissible weight, including cargo, fluids, optional equipment and accessories that can be safely supported by a combination of all axles.

**UVW (Unloaded Vehicle Weight)\*** - is the typical weight of the unit as manufactured at the factory. It includes all weight at the unit's axle(s) and tongue or pin and LP Gas. The UVW does not include cargo, fresh potable water, additional optional equipment or dealer installed accessories.

\*Estimated Average based on standard build optional equipment.

**CCC (Cargo Carrying Capacity)\*\*** - is the amount of weight available for fresh potable water, cargo, additional optional equipment and accessories. CCC is equal to GVWR minus UVW. Available CCC should accommodate fresh potable water (8.3 lbs per gallon). Before filling the fresh water tank, empty the black and gray tanks to provide for more cargo capacity.

\*\* Estimated average based on standard build optional equipment

Each Forest River RV is weighed at the manufacturing facility prior to shipping. A label identifying the unloaded vehicle weight of the actual unit and the cargo carrying capacity is applied to every Forest River RV prior to leaving our facilities.

The load capacity of your unit is designated by weight, not by volume, so you cannot necessarily use all available space when loading your unit.

All information contained in this brochure is believed to be accurate at the time of publication. However, during the model year, it may be necessary to make revisions and Forest River, Inc., reserves the right to make all such changes without notice, including prices, colors, materials, equipment and specifications as well as the addition of new models and the discontinuance of models shown in this brochure. Therefore, please consult with your Forest River dealer and confirm the existence of any materials, design or specifications that are material to your purchase decision.



#### Learn More

Scan this barcode using a QR Reader on your smart phone to learn more about Forest River.



A Berkshire Hathaway company.

Forest River, Inc.  
55470 C.R. 1, Elkhart, IN 46515  
(574) 389-4600  
[www.forestriverinc.com/hemisphere](http://www.forestriverinc.com/hemisphere)  
[www.forestriveraccessories.com](http://www.forestriveraccessories.com)

YOUR LOCAL HEMISPHERE DEALER