

17TH ANNUAL MOPARS AT JUNCTION



SHOW & SWAP MEET Sunday, June 9, 2024 at Junction Auto Sales

(RAIN DATE: Sunday, June 16th)
Special Event T-shirt to 1st 200 participants

WE'RE BACK FOR
OUR MONSTER 17TH
ANNUAL SHOW!!

- Over 300 Participants Annually
- Trophies to Class Winners
- Return of the Burn-Out
- DJ Spinning the Tunes
- Free Food to All Participants
- Special Door Prizes All Day
- See Last Years Show at www.junctionperformance.com



Registration 8:00a.m. 12:00p.m.
Judging of Entries 12:00p.m. 2:00p.m.
FOR SHOW INFORMATION CALL MIKE AT
(440) 946-5577 • (440) 286-6161
After Hours (440) 221-2523

JUNCTION AUTO SALES, INC.

2006 DEALER OF THE YEAR "Dependability since 1931"

Junction of U.S. 322 & Ohio 44
P.O. Box 110 Chardon, Ohio 44024
Phones: (440) 286-6161 • Cleveland (440) 946-5577
www.moparsatjunction.com



AUTHORIZED AUTO METAL DIRECT RESTORATION DEALER

CELEBRATING 17 YEARS OF MOPAR SHOW PARTICIPATION!!

CLASSES

- | | |
|---|---|
| #1 AMC
#2 Pre-1962 - Original
#3 1962-1969 - Original
#4 1970-1974 - Original
#5 1975-Present - Original
#6 Convertible
#7 Front Wheel Drive - Original
#8 Front Wheel Drive - Custom
#9 Pre-1965 - Custom
#10 1966-1969 - Custom
#11 1970-Present - Custom
#12 1962-1969 - Factory Muscle
#13 1970-1971 - Factory Muscle | #14 1972-2002 - Factory Muscle
#15 2003-Present - Factory Muscle <i>(except Challenger)</i>
#16 2008-2014 - Challenger Original
#17 2015-Present - Challenger Original
#18 2008-2014 - Challenger Custom
#19 2015-Present - Challenger Custom
#20 Original Trucks/Vans
#21 Modified Trucks/Vans
#22 Best Wing Car / Multi-Carb Cars
#23 Survivor
#24 Jeep
#25 Race Car
#26 Best of Show |
|---|---|

SHOW CARS (PER VEHICLE)	SWAP SPACE
Day of Show, \$30.00	20' X 20' - \$30.00
Advance (by 6/01/24) \$25.00	
(Participant Event T-Shirt Included w/Pre-registered Entry) ** XXL & XXXL Add \$5.00 * Must Be Pre-registered Before 6/1/24	

FROM CLEVELAND: TAKE I-90 EAST TO THE ROUTE 44 EXIT. TURN LEFT FOLLOW 44 SOUTH THRU CHARDON SQUARE; CONTINUE SOUTH ON 44 APPROX. 3 MILES ON LEFT.

FROM THE SOUTH: TAKE I-271 NORTH TO THE MAYFIELD RD. EAST (RTE 322) EXIT. TAKE MAYFIELD RD. (RTE 322 EAST APPROX. 14 MILES.

FROM THE EAST: TAKE I-90 WEST TO THE ROUTE 44 EXIT. TURN LEFT FOLLOW 44 SOUTH THRU CHARDON SQUARE; CONTINUE SOUTH ON 44 APPROX. 3 MILES ON LEFT.

FROM THE NORTH: TAKE ROUTE 44 SOUTH THRU CHARDON SQUARE. FOLLOW 44 SOUTH APPROX. 3 MILES ON LEFT.

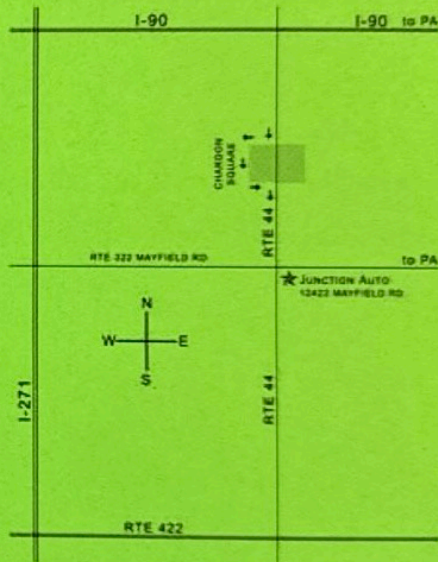

JUNCTION AUTO SALES, INC.

2006 DEALER OF THE YEAR "Dependability since 1931"

Junction of U.S. 322 & Ohio 44
 P.O. Box 110 Chardon, Ohio 44024
 Phones: (440) 286-6161 • Cleveland (440) 946-5577



REGISTRATION

NAME / TELEPHONE:

ADDRESS:

CITY / STATE / ZIP:

EMAIL:

CAR YEAR	CAR MAKE	CAR MODEL	CLASS ENTERED	T-SHIRT SIZE
			#	

Make Checks Payable to: Junction Auto