

2017 Lexus
BOUTIQUE
COLLECTION



BEBO



OLD



Apparel	5
Headwear	14
Timepieces	16
Drinkware	18
Golf.....	22
Bags	24
Technology.....	26
Lifestyle.....	28
Writing Instruments.....	30
Keyrings.....	32
Accessories	34
Licence Plate Frames.....	36
<i>F SPORT</i>	38
F	44
Youth.....	48



LEXUS brings the passion that's been the very genesis behind the style and performance of every Lexus vehicle. A passion for driving with intuitive technology and expressive design. The Lexus Boutique Collection offers exclusive branded merchandise with that same passion. Quality branded apparel, accessories and gifts to complement your lifestyle. Style and performance for your everyday driving enjoyment.



A & B. MEN'S AND LADIES' SOFT SHELL JACKET

A. Ladies' 267373

B. Men's 267369

100% polyester, this style offers a perfect combination of style and comfort. From the contoured cuffs and dropped back hem to the articulated elbows and ergonomic sleeves, it provides a superior fit for all seasons. Lexus logo on back neck.

Men's M-2XL

Ladies' S-L

MSRP: \$99.95

**LEXUS OUTERWEAR
FOR THE STYLISH
IN MIND.**

UNSPOKEN STYLE. COMMANDING POWER.

Lexus NX is a bold, expertly crafted take on the Luxury Compact SUV. A harmonious pairing of style and power. NX is the embodiment of progressive luxury, commanding attention without saying a word.







**A. MEN'S BONDED
STORMTECH JACKET**

267374

100% polyester. Sleek and stylish jacket features a twill body with ultra-soft softshell sleeves and side panels. Lexus logo on right bicep. M-2XL

MSRP: \$199.95



**B. MEN'S FULL ZIP
STORMTECH HOODY**

227291

Corded fleece exterior, high collar with chin saver. Adjustable hood, thumb hold cuffs and zippered pockets. Lexus logo embroidered on left chest. S-XL

MSRP: \$155.75



**C. LADIES' FULL ZIP
STORMTECH HOODY**

227294

100% Polyester. Teflon® water repellent and stain resistant fabric. Attached hood with drawstrings. Lexus logo heat transferred on front left hip. S-L

MSRP: \$89.95



D



E



F



G

D & E. MEN'S AND LADIES' STORMTECH 1/4 ZIP

6. Men's 267402
7. Ladies' 267403

Performance-inspired H2X-DRY® moisture wicking spandex fleece offers incredible freedom of movement and breathability. This 1/4-zip top features contrast flatlock stitching, thumb holes, and convertible hand warmer cuffs.

Men's M-2XL
Ladies' S - L

MSRP: \$109.75

F. MEN'S ROOTS73 1/4 ZIP

227310

100% Cotton sueded washed jersey knit. Rib knit collar and sleeve cuffs incorporating a cotton/spandex blend to offer a comfortably sleek fit. Lexus logo embroidered on left bicep. S-XL

MSRP: \$89.95

G. LADIES' ROOTS73 FULL ZIP

227311

100% Cotton sueded washed jersey knit. Rib knit collar and sleeve cuffs incorporating a cotton/spandex blend to offer a comfortably sleek fit. Lexus logo embroidered on left bicep. S-XL

MSRP: \$89.95

CELEBRATE THE JOURNEY



2017 RX 350

The daring 2017 Lexus RX is redefining luxury in motion, with a full range of captivating features fit to inspire every ride. As bold as they are elegant, it's the added touches that make the RX a stylish force to reckon with. No matter which angle you approach from, the finely crafted heated and ventilated front seats, available Head-Up Display or groundbreaking 15-speaker Mark Levinson® Surround Sound Audio System will take every one of your senses for a ride. For even more exhilaration, the RX is also available in *F SPORT*.





A. MEN'S OGIO® OPTIC POLO

267380

100% double knit polyester mesh with stay-cool wicking technology. 3-snap placket with signature "O" badge on left sleeve. Lexus logo on right sleeve. M-2XL

MSRP: \$75.95

B. MEN'S OGIO® OPTIC POLO

267397

100% double knit polyester mesh with stay-cool wicking technology. 3-snap placket with signature "O" badge on left sleeve. Lexus logo on right sleeve. M-2XL

MSRP: \$75.95

C. MEN'S FILA® STRIPED POLO

267400

100% Polyester. Tech-Dry & Anti-Bacterial vertical striped polo. Lexus logo on back neck. M-2XL

MSRP: \$85.50



A. LADIES' OGIO® POLO

267398

100% polyester jersey knit with stay-cool wicking technology. 5-button placket. Pintuck detail at tops of sleeves and back yoke. Curved front and back hem. S-L

MSRP: \$75.95

B. LADIES' RHINESTONE T-SHIRT

206309

Add a little bling to your wardrobe with this custom rhinestone fitted t-shirt. 95% ringspun cotton, 5% spandex. S-L

MSRP: \$36.50

LUXURY HAS NO BOUNDARIES.



EXPERIENCE THE LEXUS LX

The latest expression of Lexus flagship luxury. 2017 LX 570 offers incredibly advanced technology and safety features, luxurious seating for eight, and unsurpassed freedom on or off road – melding boundless performance with uncompromising refinement.





A

A. NIKE® DRI-FIT CAP

267413

100% polyester Dri-Fit. Lightweight comfort and breathability. Adjustable snagless closure.

MSRP: \$29.95



B

B. NEW ERA® MESH CAP

267416

6 panel stretch fit cap with elasticized band. NEW ERA® taping on inside seams.

Adult sizes: S/M (6 7/8 to 7 1/4), M/L (7 1/8 to 7 5/8), L/XL (7 1/2 to 8).

MSRP: \$26.95



C

C. OAKLEY® CAP

267414

97% cotton / 3% elastane. Authentic New Era® 39THIRTY® fitted hat. Slightly curved brim. Front metal fixed icon. Padded sweatband and eyelet venting.

MSRP: \$39.95



D

D. BEDFORD CORD CAP

267428

96% cotton / 4% spandex. 6 section cap, with matching adjustable back strap.

MSRP: \$22.50



E

E. BRUSHED PERFORMANCE CAP

227474

85% Polyester / 15% Nylon

Water repellent brushed nylon, with matching sandwich peak. Lexus symbol on rubber patch on front right panel.

MSRP: \$22.95

F. SPORTS MESH CAP

227418

6 section performance mesh cap with matching adjustable self back strap and velcro tab closure. Lexus logo embroidered on front left panel.

MSRP: \$19.95



G. LEXUS NEW ERA® DRY MESH CAP

206325

100% polyester full back cap with stretch fit and elasticized band. Lexus logo embroidered on front left panel.

S/M - 6 7/8" to 7 1/4" diameter

M/L - 7 1/8" to 7 5/8" diameter

L/XL - 7 1/2" to 8" diameter

MSRP: \$29.95



H. LEXUS SLEEK CAP

155018

This black cap is branded with distinction using a liquid metal Lexus logo.

MSRP: \$16.95



I. LEXUS LIQUID METAL CAP

163004

Premium cotton twill cap with liquid metal Lexus logo on front. Adjustable self back strap. One size fits most.

MSRP: \$22.50



J. NEW ERA® CAP

267415

100% Polyester. Stretch fit with elasticized band. NEW ERA® taping on inside seams.

Adult sizes: S/M (6 7/8 to 7 1/4),

M/L (7 1/8 to 7 5/8), L/XL (7 1/2 to 8).

MSRP: \$32.95





A. MEN'S TAG HEUER AQUARACER WATCH

231066

43mm, fine brushed and polished steel case. Anti-reflective scratch-resistant sapphire crystal. 3-counters: 1/10th of a second and hour chronograph counter, minute chronograph counter and running second counter. Angled big-date window at 12 o'clock. Water resistant to 300M.

***Model subject to change throughout the year based on availability.**

This is a dropship item. Please allow 3 - 4 weeks for delivery.

MSRP: \$2,450.00

THE ULTIMATE EXPRESSION OF THE HIGH PERFORMANCE LIFESTYLE





B

B. MEN'S VICTORINOX SWISS ARMY WATCH

267434

Swiss Quartz movement. 45mm stainless case diameter. Water resistant to 100M. Lexus logo on back case of watch.

*Model subject to change throughout the year based on availability.

MSRP: \$895.00



C

C. MEN'S BULOVA AUTOMATIC WATCH

267438

Stainless steel with black outer dial and open skeleton inner dial. Fold-over closure. Water resistant to 30M. Lexus logo on back case of watch.

*Model subject to change throughout the year based on availability.

MSRP: \$450.00



D

D. MEN'S HUGO BOSS WATCH

267439

Black matte dial and stainless steel case and bracelet. Chronograph movement that is water resistant to 50M. Lexus logo on back case of watch.

*Model subject to change throughout the year based on availability.

MSRP: \$525.00



E

E. LADIES' LACOSTE ROSE GOLD WATCH

267444

3-hand movement, water resistant to 30M. Lexus logo on back case of watch.

*Model subject to change throughout the year based on availability.

MSRP: \$250.00

HOT AND COLD DRINKWARE.
SERVE IT UP IN SLEEK
LEXUS STYLE.



A. HOT & COLD THERMAL BOTTLE

267454

17oz., this bottle is double wall 18/8 grade stainless steel with vacuum insulation. Inner wall is plated with copper for ultimate conductivity to keep drinks hot for up to 12 hours and cold for up to 48 hours.

MSRP: \$29.95

B. CHISELED TUMBLER

206367

16 oz., double wall stainless steel tumbler with screw on, spill proof flip lid.

MSRP: \$27.50

C. COFFEE TUMBLER

267456

17oz., sleek and ergonomic design makes it comfortable to grip and drink from. The flip top provides easy access to your favourite hot drink. The vacuum insulated double wall stainless steel interior keeps your liquids hot for up to 6 hours and cold for up to 24 hours. Gift boxed.

MSRP: \$25.95

D. WHITE QUARTZ MUG

267446

12oz., sleek matte white finish with contrasting interior.

MSRP: \$13.95

E. HOT & COLD GLASS BOTTLE

267450

14oz. sleek and refined tumbler is double-walled heat resistant so it's great for both hot or cold beverages. Gift boxed.

MSRP: \$32.50

F. HIGH SIERRA® VACUUM BOTTLE

267582

20oz. Rugged construction heightens the durability of this double wall vacuum insulated stainless steel bottle. Keeps drinks hot for up to 6 hours and cold for up to 24 hours. Twist on/off cap has open close function. Lid with handle doubles as 6oz. drinking cup.

MSRP: \$39.95



D

E

F



A



B



C



D



E



F

A. PRISM TUMBLER

227479

16oz. stainless steel. Double walled vacuum tumbler. Leakproof screw on flip top lid. Textured diamond pattern. Non-slip EVA bottom.

MSRP: \$23.95

B. VACUUM TUMBLER

267457

16oz., double wall vacuum insulated 18/8 stainless steel construction. Keeps drinks hot for up to 5 hours and cold for up to 15 hours. Outer wall is grooved for a comfortable grip and stylish look.

MSRP: \$29.95

C. VACUUM TUMBLER

227480

16oz. Stainless steel. Dual wall, copper lined and vacuum insulated. Flip top lid.

MSRP: \$25.95

D. VACUUM INSULATED TUMBLER

267458

20oz., durable, double-wall stainless steel tumbler. Allows your cold beverage to stay cold for up to 24 hours and hot for up to 6 hours. Easy sipping, push-on lid.

MSRP: \$29.95

E. WHITE TUMBLER

182488

Dual wall construction for optimum heat retention. Twist-action, spill resistant lid.

MSRP: \$23.95

F. CUTTER & BUCK® TRAVEL MUG

162986

Double wall, stainless travel 16 oz. mug with screw on lid. Includes 1-piece Cutter & Buck® gift box.

MSRP: \$25.95



**G. THERMOS®
HYDRATION BOTTLE**

267449

24oz. BPA-free, impact-resistant and dishwasher safe. Hygienic rear push button lid with one-handed operation and locking switch. Integrated carrying loop. Measuring guide helps monitor daily intake.

MSRP: \$34.50



H. SPORT BOTTLE

227507

28oz., BPA free. Bold, geometric design. Lid features handle and flip up straw. Tritan™ material is shatter, stain and odour resistant.

MSRP: \$14.95



**I. INFUSER TRITAN™
BOTTLE**

267447

32oz., screw-on, spill resistant lid with straw. Detachable fruit infuser to add flavour to your beverage. Wide opening for easy cleaning and filling. Shatter, stain, and odour resistant. Carabiner hook. BPA free.

MSRP: \$17.50



**J. HOT & COLD TRAVEL
BOTTLE**

267451

15oz. Style, durability and a sleek matte finish. Drinks remains cold for up to 24 hours, and hot for up to 8 hours. Handwash only. Gift boxed.

MSRP: \$32.50



**K. CONTIGO® THERMAL
BOTTLE**

267455

20oz., stainless steel water bottle keeps drinks cold for up to 24 hours and keeps drinks hot for up to 10 hours! Leak proof and includes a convenient carry handle that makes for easy on-the-go transport.

MSRP: \$29.95





HIT THE COURSE.

A. TAYLORMADE® AEROBURNER PRO GOLF BALLS

267463

Aeroburner Pro is a three-piece ball engineered for high ball speeds off the club face, designed to deliver speed and distance with pro-like stopping power.

MSRP: \$39.95

B. TITLEIST PRO V1® GOLF BALLS

182516

This tour-proven golf ball features a new patented cover formulation that delivers more short-game spin and control with an even softer feel. Combined with its already exceptional distance, long-lasting durability, unmatched consistency, penetrating trajectory, and low driver spin

MSRP: \$69.95

C. TAYLORMADE® TOURLITE STAND BAG

261741

4-way top with handle (8.5" x 7.5"), 4 point shoulder strap with mesh, anti-split stand system with 7 pockets including valuables, garment, rangefinder, accessories and water bottle pockets, velcro glove tab, removable custom embroidery ball pocket, 3.9 lbs.

MSRP: \$ 229.95

D. NIKE 62" WINDPROOF UMBRELLA

267465

Innovative "Pinchless" design opening feature. Two-colour 100% rubber handle with a dual-density grip is designed to fit comfortably in your hand or securely in your push cart. Made of durable nylon.

Limited edition inventory available. While supplies last.

MSRP: \$49.95



FOR WHEREVER LIFE TAKES YOU

A. BUGATTI CARRY-ON LUGGAGE

227593

Black lightweight Polycarbonate and ABS hard shell. The shell flexes to absorb impact and flexes back to regain original shape. Telescopic handle system with multi-stage locking heights. Reinforced top and side carry handles. Comes with Lexus luggage tag. 20" H x 14" L x 10" W

MSRP: \$150.00





B. OGIO® LADIES' DUFFEL

206450

Large main compartment. Front-faced and side zippered pocket. Adjustable padded shoulder strap. 13" H x 24" W x 12" D.

MSRP: \$59.95



C. OGIO® ALL TERRAIN DUFFEL

206448

Large U-shaped opening. Front and side storage pocket with mesh dividers. Fleece-lined valuables pocket. 11.75" H x 24" W x 9" D.

MSRP: \$69.95



D. VICTORINOX SWISS ARMY LAPTOP BACKPACK

267563

Padded rear compartment with soft, anti-scratch lining holds up to a 16" laptop. 10" padded portable electronic device pocket with soft, anti-scratch lining. 13.5"W x 18"H x 10.5"D

MSRP: \$ 99.95



E. LADIES' METHOD TOTE

267570

This tote can be used as a briefcase for the active executive or as a gym bag. Bag includes many pockets for organization, an interior hanging pocket, padded tablet compartment, and a special place for your cell phone. This bag also has a removable and adjustable shoulder strap with shoulder pad. Fully Lined. Fabric is 420D nylon with a PVC coating.

MSRP: \$89.95

F. ELLEVEN™ 22" SQUARED DUFFEL WITH GARMENT BAG

267571

Elleven™ is the next generation in travel bags, built specifically for the frequent traveler. This innovative design combines both a carry-on size duffel and a removable zip-out garment bag. Other smart features include large zippered front organizer pocket and integrated shoe pockets. Padded and adjustable shoulder straps, signature eleven lining and hardware.

MSRP: \$125.75





LIFE'S SIMPLE PLEASURES



A. ROXBOX™ 7" MINI-TWIST BLUETOOTH SPEAKER

227610

3-Watt Bluetooth® speaker. The speaker is powered by V2.1 EDR Bluetooth® and supports NFC technology for quick and easy phone pairing. Listen at a range of 10m/33ft for up to 4 hours straight with a 2 ½ hour recharge time. Includes a USB cable for recharging and a 3.5mm audio jack for non-Bluetooth® devices.

MSRP: \$99.95



B. WATERPROOF OUTDOOR BLUETOOTH SPEAKER

267579

Enjoy your favourite music regardless of your location. Take the outdoor speaker with you to the pool, on your hike, or to your next house party. The 6 Watt output and Digital Sound Processor is capable of filling any location with quality sound. Includes Micro USB charging cable. Bluetooth® working range is 10 meters.

MSRP: \$75.95

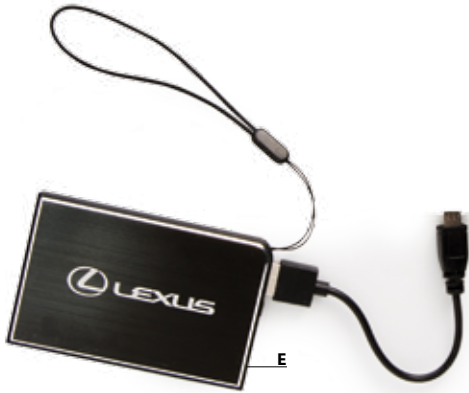

E. 2,000 MAH POWER BANK

220761

Metal power bank with a USB output port that supplies DC 5V/1A output current and LED battery status indicators. Includes a USB/micro-USB charging cable.

MSRP: \$29.95

C. BOSE® SOUNDTRUE™ ON-EAR HEADPHONES

206477

Premium sound, delivering exceptional on-ear quality listening.

MSRP: \$240.00

D. WIRELESS STEREO EARBUDS

267589

Take your calls and listen to music with these stylish and comfortable wireless stereo earbuds. Answer a call, redial the last number, or put a call on hold while you answer another - or play your music and skip songs, all for up to 7.5 hours after just 2 hours of charging.

MSRP: \$59.95

F. MEGA VAULT POWER BANK

267528

8800 mAh Grade A Lithium Ion battery with dual output. The first output is for charging smartphones and the second is for charging tablets. Also includes an LED light and Micro USB cable which can charge the battery backup or be used to charge up devices.

MSRP: \$69.95

LIFESTYLE & ACCESSORIES

A. VIN BLANC PORTABLE WINE CHILLER

267578

This ingenious chiller is practical, safe and lightweight; it is the ideal product for transporting and keeping fine wine at the recommended temperature.

MSRP: \$59.95

B. HIGH SIERRA® VACUUM BOTTLE

267582

20oz. Rugged construction heightens the durability of this double wall vacuum insulated stainless steel bottle. Keeps drinks hot for up to 6 hours and cold for up to 24 hours. Twist on/off cap has open close function. Lid with handle doubles as 6oz. drinking cup.

MSRP: \$39.95

C. VELURA™ TRAVEL PILLOW

267577

On your next trip make life a little easier with this soft travel pillow. 100% polyester.

MSRP: \$29.95

D. THE CABIN THROW

267576

Made from 100% polyester. Our single layer Velura™ Cabin Throws are perfect to snuggle up in and complement fall and winter colours perfectly. 60" x 70"

MSRP: \$59.95



E. LAMBSWOOL THROW

227615

Features micro fur on one side while the other has the coziness of faux lambswool. Machine washable. 100% polyester. Packages in a vinyl zipper bags. 50" x 50"

MSRP: \$59.95

F. MINI CARABINER LIGHT

267590

Barrel style flashlight with six bright LED lights. Carabiner style clip to attach to your bag, backpack, purse or key ring. Batteries included.

MSRP: \$6.95



G. HIGH SIERRA® 66 LED 3-IN-1 CAMPING LANTERN

267580

Heavy duty camping lantern featuring bright white 66 LED lights with dual optional removable 3 LED flashlights. Lantern includes two metal rubber coated carry handles and multiple mode.

MSRP: \$59.95



H. LED MAGNETIC POCKET FLASHLIGHT

227616

Easy-to-use portable 10 LED flashlight with magnet clip is housed in a lightweight ABS plastic shell. Includes three AAA batteries.

MSRP: \$15.75



I. POP UP CARGO BOX

206468

600D polyester black cargo box features two large compartments for storing groceries, sporting goods and much more. 16.25" L 12" H 20" W.

MSRP: \$35.50



J. BRAKE DISC WALL CLOCK

267573

13" diameter wall clock. Construction details to an original racing brake disc. Aluminum rotor sheet with through-hole cross drilling. Wrench shaped sweeping hands.

MSRP: \$79.95



STYLUS AND WRITING INSTRUMENTS

A. ROLLERBALL/STYLUS

267536

Brass with a magnetic pull-off cap and a metallic mesh capacitive stylus. Lexus logo beside clip.

MSRP: \$32.50

B. CASE LOGIC® ROLLER BALL STYLUS

267535

Features a shiny and matte contrasting finish. The fiber stylus tips allows for the easy navigation of the web as well as important documents. Pen includes premium black roller ball ink cartridge. Case Logic® gift box included.

MSRP: \$17.75

C. PREMIUM STYLUS PEN

267533

The ultimate in luxury and class, this solid brass pen-stylus combination is nicely weighted and made of the highest quality materials. The top end features a 6mm silicone soft touch capacitive stylus tip while one twist of the glossy smooth barrel reveals a refillable ballpoint pen on the opposite end. Lexus logo beside clip.

MSRP: \$22.50





D. BALLPOINT & ROLLERBALL SET

267537

Ballpoint pen is standard aluminum push action pen. Rollerball is a pull off cap with oval shaped barrel.

MSRP: \$19.95

E. CROSS® EDGE GEL INK PEN

163104

Innovative capless slide-and-snap mechanism. Stylish and sophisticated black finish.

MSRP: \$65.95

F. FRANKLIN COVEY PEN BY CROSS®

227581

Polished black lacquer finish, with chrome accents. Click-to-write functionality. Black, medium ballpoint. specially formulated ink that flows flawlessly for a superior writing experience. Lexus logo beside clip.

MSRP: \$15.95



KEYRINGS

A. LEXUS RHINESTONE KEYCHAIN

163169

Split ring keychain with a little bling! A perfect accessory for a Lexus driver.

MSRP: \$12.95

B. CUSTOM LEXUS KEYCHAIN

267514

MSRP: \$12.50



C. KEY RING

267523

Chrome hinged ring has 3 detachable split rings.

MSRP: \$12.95



D. BLACK LEATHER KEY FOB

163171

Split key ring with Lexus logo laser engraved on plate.

MSRP: \$9.95



TOY BLOCKS

PILLOW FORT

ARCHITECTURAL SCHOOL

APPRENTICE

PARTNER

SKYSCRAPER



**YOUR PASSIONS
TAKE YOU PLACES.**

SO DO OURS. Discover the 2017 Lexus ES. From its elegant lines, available hybrid engine, and intuitive park-assist, to its handcrafted heated steering wheel, ventilated leather seats and Lexus Safety System+, it's as comfortable as you are accomplished.

 LEXUS

ACCESSORIES



A



B



C



D



E



F



G

A. LEATHER KEY FOB, GENERATION 1

155016

Proudly sport the Lexus brand with this black 100% leather key fob.

MSRP: \$12.50

B. LEATHER KEY FOB, GENERATION 2

163145

Proudly sport the Lexus brand with this black 100% leather key fob.

MSRP: \$12.50

C. SECRID CARD PROTECTOR

273621

Holds 6 flat cards or 4 embossed cards. The aluminium card protector protects your most important cards, both against bending and breaking and against being scanned if you don't want them to be (such as transportation passes, ID cards, credit cards and business cards).

MSRP: \$59.95

D. BUSINESS CARD HOLDER

267524

Double-sided with two compartments for business cards.

MSRP: \$19.95

E. BUGATTI MEN'S LEATHER WALLET

206385

This black wallet features fully integrated Identity Block™ protection. Removable left wing billfold. Card slots, I.D. windows and functional pockets.

MSRP: \$47.50

F. IZOD COMPACT UMBRELLA

206383

43' arc umbrella which opens and closes automatically with the push of a button. Stylish molded rubber handle. Overlapping double canopy funnels wind to prevent umbrella from inverting.

MSRP: \$49.95

G. BUGATTI LARGE CLASSIC UMBRELLA

206381

Elegant genuine Chestnut wood hook handle with fiberglass manual frame. Extra large canopy for outstanding protection. Approximate diameter of 52".

MSRP: \$79.95

A TOUCH OF LEXUS BLING

H



H. SWAROVSKI® CRYSTAL NECKLACE

182648

18N gold plated 11MM roller ball crystal with chain. Clear Swarovski® crystal. Packaged in a gift box that is decorated with the Lexus logo.

MSRP: \$69.95

I. LEXUS CUFFLINKS

206391

Custom stainless steel cufflinks accentuated with sophisticated black accents.

MSRP: \$69.95

J. PANDORA® CHARM

227573

Custom Pandora® charm with the Lexus stacked logo engraved on the centre.

MSRP: \$89.95

K. CUSTOM LEXUS LAPEL PIN

156321

Classic sterling silver lapel pin is a subtle statement of Lexus pride and style.

MSRP: \$29.95

J



K



I



LICENCE PLATE FRAMES

A personalized touch to add style and enhance the appearance of your Lexus.



Classic polished frame is made from high grade, heavy gauge stainless steel that is guaranteed not to rust or corrode. Includes matching hardware hider caps for a high end look.



A. F SPORT STAINLESS STEEL LICENCE PLATE FRAME

200999

F SPORT Plate Frame Classic polished frame is made from high grade, heavy gauge stainless steel that is guaranteed not to rust or corrode. Includes matching hardware hider caps for a high end look. F SPORT logo on plate set in carbon fiber composite.

MSRP: \$53.25

B. LEXUS GIFT SET

200995

Classic polished frame is made from high grade, heavy gauge stainless steel that is guaranteed not to rust or corrode. Includes matching hardware hider caps for a high end look. Lexus logo on frame set in domed epoxy. Set includes branded tire valve stem caps and laser etched stainless steel keyring.

MSRP: \$69.95

C. LEXUS STAINLESS STEEL LICENCE PLATE FRAME

200997

Classic polished frame is made from high grade, heavy gauge stainless steel that is guaranteed not to rust or corrode. Includes matching hardware hider caps for a high end look. Lexus logo on frame set in UV resistant protective domed epoxy.

MSRP: \$47.95

D. POLYCARBONATE LEXUS MARQUE PLATE

226838

2 hole, 1/16" polycarbonate with anti-scratch coating. Backside is reverse screen printed with exterior grade UV resistant ink. Includes black hardware hider caps and offset spacers.

MSRP: \$33.00

E. POLYCARBONATE F SPORT MARQUE PLATE

226841

2 hole, 1/16" polycarbonate with anti-scratch coating. Backside is reverse screen printed with exterior grade UV resistant ink. Includes black hardware hider caps and offset spacers.

MSRP: \$33.00

Some provinces do not permit the covering of licence plate characteristics. Please check with your local law enforcement agency.



UP THE EXCITEMENT

F SPORT ignites a passion for driving with intuitive technology and expressive design. The *F SPORT* accessories collection is designed to infuse your Lexus with *F SPORT* style.



To find out more about the *F SPORT* lineup, please visit lexus.ca.





A. MEN'S STORMTECH *F SPORT* LIGHTWEIGHT JACKET 206340

100% polyester black jacket featuring H2XTREME® stretch fabric. Breathable and waterproof, this jacket is perfect for all activities. *F SPORT* logo heat transferred on left chest and Lexus logo heat transferred on right bicep. S-XL

MSRP: \$199.95



B. MEN'S BONDED F SPORT JACKET

267375

100% polyester jersey with waterproofness and breathability. Includes right chest pocket, underarm and under sleeve panels. F SPORT logo on left chest, Lexus logo on right bicep. M-2XL

MSRP: \$99.95

C. MEN'S F SPORT POLO

267404

This performance polo offers both high fashion style and H2X-DRY® moisture management technology. F SPORT logo on left chest and Lexus logo on right sleeve. M-2XL

MSRP: \$89.95

D. MEN'S ADIDAS FULL ZIP

267406

95% polyester / 5% elastane. Heat guards at neck, sleeves and hem keep warmth from escaping. Zippered hand pockets. F SPORT logo on right bicep, Lexus logo on back neck. Generous sizing. M-2XL

MSRP: \$179.95

E. LEXUS F SPORT CUSTOM CAP

267431

100% Cotton with lightweight performance material on back and on peak. Multi-panel sport accents.

MSRP: \$25.95

**A. MEN'S F SPORT
LIMITED EDITION WATCH**

207494

Stainless steel watch with chronograph movement. One-way turnable top bezel. Water resistant to 100 metres. *F SPORT* logo printed on dial and Lexus logo engraved on the back case.

While supplies last.

MSRP: \$249.95

B. F SPORT MEN'S WATCH

163405

100% stainless steel with spring buckle and luminous hands. Water resistant to 50 metres.

While supplies last.

MSRP: \$225.95





C



D



E

**C. CUSTOM F SPORT
KEYCHAIN**

267517

MSRP: \$12.50

**D. SHEAFFER® CARBON
FIBER PEN**

267540

Carbon Fiber barrel with chrome cap and chrome trim. Ballpoint with a sleek design offered in contemporary finish. Comes with a limited 3 year warranty.

MSRP: \$79.95

**E. F SPORT TWIST
CARBON FIBER PEN**

163113

Twist action mechanism. Standard European black ballpoint ink cartridge. Includes 2-piece gift box.

MSRP: \$19.95

**F. THERMOS®
HYDRATION BOTTLE**

227506

24oz., BPA free. Flip top lid with one hand push button operation. Rotating meter lets you monitor your daily water consumption. Dishwasher safe.

MSRP: \$25.95



F



A. MEN'S TAG HEUER CARRERA WATCH 231069

43mm, with special luminescent hands and markers for excellent readability in the dark or under water. Water resistant to 100M.

***Model subject to change throughout the year based on availability.**

This is a dropship item. Please allow 3 - 4 weeks for delivery.

MSRP: \$5800.00



TRACK SOLD SEPARATELY.



THE ELECTRIFYING 2017 RC F

The race-inspired RC F Coupe from Lexus. Its unique L-shaped cooling intakes, aggressive stance and active rear wing promise unrivalled performance. Its formidable 5.0-liter, 467 hp V8 engine stands ready to deliver. The Lexus RC F, born on the track and built from the asphalt up. Begin your obsession at Lexus.ca/RCF





A

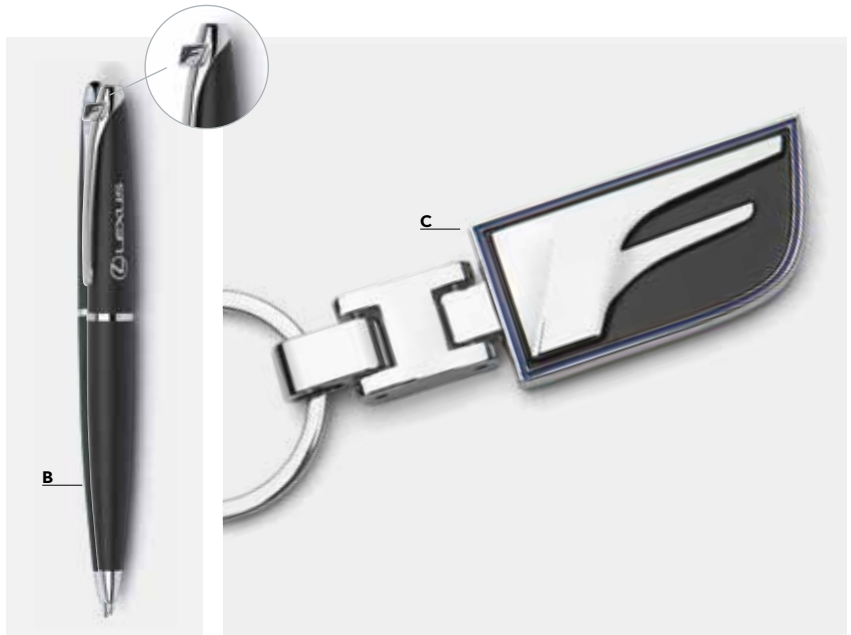

B

C



D

**B. CUSTOM F CROSS®
ATX PEN**

267542

Swivel action, medium ballpoint pen. Comes with specially formulated ink that flows for a superior writing experience.

MSRP: \$99.95

C. CUSTOM F KEYCHAIN

267516

MSRP: \$12.50

D. SECRID MINI-WALLET

273623

Hold 6 flat cards or 4 embossed cards, business cards, cash and 4 extra cards. Solid aluminium with European leather. The Miniwallet is both a compact and secure wallet. In addition to the cards in the Cardprotector, the interior offers space for a few cards, paper money, receipts, business cards and some coins. Lexus logo on inside metal case.

MSRP: \$99.95

**A. THERMOS® TRAVEL
TUMBLER**

267461

16oz., durable stainless steel interior and exterior. Cool to the touch with hot liquids, sweat-proof with cold. Fits most automotive cup holders. Keeps hot for up to 4 hours. Keeps cold for up to 8 hours.

MSRP: \$59.95



E. MEN'S LACOSTE POLO

228422

Timeless, original pique knit polo. Soft, durable and stylish. S-XL

MSRP: \$99.95

F. TUMI V3 INTERNATIONAL CARRY-ON

227595

This four-wheel carry-on is effortless to maneuver and ideal for those who travel both internationally and domestically. Retractable top carry handle. 3-stage telescoping handle. Integrated TSA lock. 4 recessed dual wheels. Weighs 6.4 lbs.

***Model subject to change throughout the year based on availability.**

MSRP: \$750.00

G. NEW ERA® STRUCTURED COTTON CAP

267417

97% cotton / 3% cotton. 6-panel, stretch fit cap with elasticized band. NEW ERA® taping on inside seams.

Sizes: S/M (6-7/8 to 7-1/4), M/L (7-1/8 to 7-5/8), L/XL (7-1/2 to 8).

MSRP: \$29.95



F logo on back neck



E



F



G





A



D



E



B

C

LEXUS YOUTH

A. LEXUS PLUSH BEAR

207454

16" bear with matching ribbon around the neck.

MSRP: \$29.95

B. CHILDREN'S LAMBSWOOL BLANKET (PINK)

267591

Both luxurious and warm, this incredibly comfortable, reversible plush throw features micro fur on one side while the other has the coziness of faux lambswool. 30" x 45"

MSRP: \$39.95

C. CHILDREN'S LAMBSWOOL BLANKET (BLUE)

267592

Both luxurious and warm, this incredibly comfortable, reversible plush throw features micro fur on one side while the other has the coziness of faux lambswool. 30" x 45"

MSRP: \$39.95

D. CHILDREN'S CONTIGO® WATERBOTTLE

267593

14oz patented single wall plastic bottle with AUTOSPOUT® threaded lid, silicone spout, one-touch push button and soft carrying handle.

MSRP: \$24.95

E. MESH PADDLE, BALL & BIRDIE GAME

273624

Great sporting activity for hours of fun at the park, in the backyard or at the beach.

MSRP: \$25.50

THE STRIKING 2017 LEXUS GS

Every inch of the 2017 Lexus GS has been built to exceed expectation. Bolder, more aggressive lines emanate from its unique spindle grille, hinting at its powerful 3.5-litre, 24-valve 311 hp engine. The interior is a deft balance of premium finishes like wood trim and a heated leather-wrapped steering wheel and technical comforts like a 12.3" LCD display. Experience the 2017 Lexus GS for yourself today.



ONE PART
THOROUGHbred.

NO PART
TAME.



Lexus Canada Dealers

BRITISH COLUMBIA

Open Road Lexus Richmond, BC (604) 273-5533
Jim Pattison Lexus Victoria, BC (250) 386-3516
Regency Lexus Vancouver, BC (604) 739-1212
Jim Pattison Lexus Northshore North Vancouver, BC
(604) 982-0033
Open Road Lexus Port Moody, BC (604) 461-7623
Lexus of Kelowna Kelowna, BC (250) 448-0990

ALBERTA

Lexus of Calgary Calgary, AB (403) 225-3987
Lexus of Edmonton Edmonton, AB (780) 466-8300
Lexus South Pointe Edmonton, AB (780) 989-2222
Lexus of Royal Oak Calgary, AB (403) 296-9600

SASKATCHEWAN

Ens Lexus Saskatoon, SK (306) 653-6777
Taylor Lexus Regina, SK (306) 569-8777

MANITOBA

Birchwood Lexus Winnipeg, MB (204) 889-3700

ONTARIO

Performance Lexus St. Catharines, ON (905) 934-3336
Ken Shaw Lexus Toronto, ON (416) 766-1155
Lexus Downtown Toronto, ON (416) 603-9100
Tony Graham Lexus Ottawa, ON (613) 225-2223
Lexus of London London, ON (519) 680-1900
Heffner Lexus Kitchener, ON (519) 748-9668
Lexus on the Park Toronto, ON (416) 391-1600
Bel-Air Lexus Ottawa, ON (613) 741-3270
Lexus of Oakville Oakville, ON (905) 847-8400
Northwest Lexus Brampton, ON (905) 494-1000
Lexus of Richmond Hill Richmond Hill, ON (905) 883-8812
Lexus of Windsor Windsor, ON (519) 979-1900
Erin Park Lexus Mississauga, ON (905) 828-7727
Don Valley North Lexus Markham, ON (905) 475-1625
Lexus of Barrie, Barrie ON (705) 722-7955
Lexus of Kingston, Kingston ON (613) 634-5555

QUÉBEC

Spinelli Lexus Lachine, QC (514) 634-7171
Spinelli Lexus Pointe-Claire Pointe-Claire, QC (514) 694-0771
Lexus Laval Laval, QC (450) 686-2710
Boulevard Lexus Quebec, QC (418) 681-2121
Lexus Gabriel Brossard Brossard, QC (450) 923-7777
Lexus Gabriel St.-Laurent, St.-Laurent QC (514) 747-7777
Park Avenue Lexus Sainte-Julie Ste-Julie, QC (450) 922-1833

NOVA SCOTIA

O'Regan's Lexus Halifax, NS (902) 453-2331

NEW BRUNSWICK

Lexus of St-John St-John, NB (506) 642-5398



www.lexus.ca 1-800-26-LEXUS
Lexus, One Toyota Place, Toronto, Ontario M1H 1H9

All illustrations and specifications contained in this brochure are based on the latest product information available at time of publication. Lexus Canada reserves the right to make any changes at any time, without notice, in colours, materials, specifications and pricing. Any variations in colours shown are due to the reproduction variations in the printing process.
Printed in Canada. Printed on recycled paper.