

ROADMASTER TOW BARS

TOWING & SAFETY

N

In Section N: Husky Hitches Couplers Hitch Accessories Hitches Tow Bars Tow Brakes Levels Mirrors & Safety Brake Controls Towing Electrical

ALL TERRAIN™ NON-BINDING TOW BARS



Towing and Suspension Solutions

Releasing your towed vehicle is easy with ROADMASTER's All Terrain tow bars...even when the tow bar is at a hard angle or the towed vehicle is out of level. Four familiar, classic ROADMASTER tow bars — StowMaster, Falcon, BlackHawk 2 and Sterling — are available in the All Terrain Series. Each is upgraded with ROADMASTER's exclusive Freedom Latch, which releases the tow bar at any angle, level or bind — first time, every time.



Includes cables and wiring

6,000 pound rated EZ Hook safety cables and electrical wiring are included.

wt. 35 lbs.



Sterling All Terrain Tow Bar

6,000 lb. wt. capacity motorhome-mounted tow bar.

30139 STERLING ALL TERRAIN tow bar with 4 wire electrical cord and cables (6,000 lb. capacity motorhome-mounted tow bar) #575 1

30143 STERLING ALL TERRAIN tow bar with 6 wire electrical cord and cables (6,000 lb. capacity motorhome-mounted tow bar) #576 1



wt. 38 lbs.

Falcon ALL TERRAIN™

39574 FALCON ALL TERRAIN tow bar
6,000 lb. wt. capacity motorhome-mounted tow bar - wt. 38 lbs. #522 15



Freedom Latch™

Disconnects first time, every time. Releasing your towed vehicle is easy — even when the tow bar is out of level or at a hard angle.



wt. 42lbs.

10,000 lb. rated!

BlackHawk 2 ALL TERRAIN™

30156 BLACKHAWK 2 ALL TERRAIN tow bar
10,000 lb. wt. capacity motorhome-mounted tow bar - wt. 42 lbs. #422 1



Quick-Disconnects

Allows "one-person" fast and easy mounting or removal of your Sterling, Falcon, or BlackHawk 2 All Terrain tow bar.



U.S. Patent No. 6,619,586

Patented Storage Latch

The patented Storage Latch makes storing the All Terrain tow bar a snap! Simply fold the tow bar toward the motorhome and it will "click," automatically locking in place.



wt. 52lbs.

StowMaster ALL TERRAIN™

39577 STOWMASTER ALL TERRAIN tow bar
6,000 lb. wt. capacity car-mounted tow bar - wt. 52 lbs. #502 1



U.S. Patent No. 6,168,182

Built-in Cable Guide

The built-in Cable Guide enhances appearance and helps keep safety cables and wiring from being rushed or damaged.



Made in the USA



Towing and Suspension Solutions

6,000 pound weight capacity motorhome-mounted tow bar

- The use of stainless steel in virtually every moving component allows for smooth, trouble-free operation and prevents corrosion that binds.
 - Autowlok locking mechanism — allows both tow bar arms to extend or retract for a quick connection. Then, as you drive away, the arms self-center and automatically lock.
- A patented latching mechanism ensures secure, easy storage on the back of your motorhome.
- One-person quick connect and disconnect — thanks to ROADMASTER's self-supporting "quick-disconnects," one person can easily connect or disconnect the Falcon 2 in seconds.
- Full-length, steel crossbar reinforced for maximum support and safety
- A lustrous, high-tech powder coat finish for maximum durability



- 34829** Falcon 2 Tow Bar (Weight 37 pounds) #520 20
- 38450** Falcon 2 Tow Bar (Fits Blue Ox base plates) #525 1
- 39378** Falcon 2 Tow Bar Cover #055 15
- 39379** Falcon 2 Combo Kit (coiled wiring) #9240 1
- 39380** Falcon 2 Combo Kit (straight wiring) #9241 1

STOWMASTER™

America's Best-Selling Car-Mounted Tow Bar

6,000-pound weight capacity car-mounted tow bar

- Stainless steel in virtually every moving component for smooth, trouble-free operation.
- Autowlok locking mechanism — allows both tow bar arms to extend or retract for a quick connection. Then, as you drive away, the arms self-center and automatically lock.
- Full-length safety crossbar — a full-length angle iron brace is integrated into the rear of the bar for maximum support.
- Self-lubricating nylon bushings eliminate friction between the inner and outer arms. Other tow bars use steel on steel.
- Plug-welded arms — steel plugs seal both ends of the tow bar, preventing corrosion from moisture and debris.
- A lustrous, high-tech powder coat finish for maximum durability.



- 38169** STOWMASTER Tow Bar #501 20
- 39553** STOWMASTER Combo Kit #9254 1
- 38170** STOWMASTER Tow Bar Cover #052 10

TRACKER™

The safest, strongest, easiest, most durable, trouble-free, 5,000 lb. rated, 'A' frame tow bar manufactured...BAR NONE!



- ROADMASTER's entry-level tow bar.
- Full-length safety crossbar for maximum strength.
- 5,000 pound towing capacity.
- A lustrous, high-tech powder coat finish for max. durability.
- Easily folds for storage — no tools needed!.
- Sealed tow bar arms keep moisture and road debris out.
- For all 2-inch ball-mount motorhome receivers.

38541 TRACKER Tow Bar for ROADMASTER XL, EZ Twistlock, or Standard Brackets #020 1



Made in the USA

Mounting Brackets



Towing and Suspension Solutions

No unsightly steel hanging off the front of your car!

ROADMASTER 'XL', 'MX' and 'EZ' series mounting brackets have detachable extensions which are easily removed when the car is not being towed.

- They're virtually invisible — improved aesthetics.
- Easy to install — ROADMASTER brackets use existing attachment points on the vehicle's undercarriage.
- Most install through the grille — no scraping brackets in dips or curbs.
- Easy to remove — converts from towed car to road car in seconds!



Now you see 'em...



...now you don't!

XL™ Bracket



EZ Twistlock™ Bracket



EZ Twistlock bracket shown with quick-disconnects

MX™ Bracket



Why are Roadmaster brackets rated #1?

- Largest selection in the industry
- Easiest to install
- Strongest design
- Computer tested

Tow Bar Covers

Heavy-duty, marine-grade black vinyl, hand-crafted at the ROADMASTER plant to custom-fit ROADMASTER tow bars. Proudly displaying their respective logos, these 'car wash safe' covers will help keep your tow bar free of dirt and road grime, ensuring smooth and easy tow bar operation.

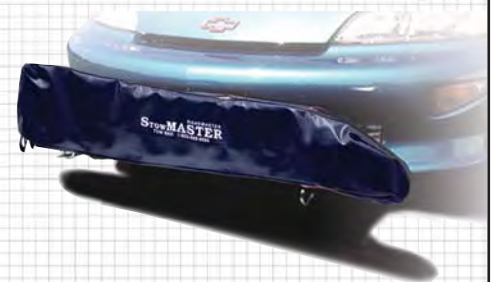

- 30134** STERLING ALL TERRAIN Tow Bar Cover #057-2 15
- 39598** ^{LS} STOWMASTER ALL TERRAIN Tow Bar Cover #052-2 1
- 38170** STOWMASTER Tow Bar Cover #052 10
- 39378** FALCON 2 Tow Bar Cover #055 15
- 39599** FALCON, BLACKHAWK, BLACKHAWK 2 ALL TERRAIN Tow Bar Cover #055-2 1
- 39597** ^{LS} BLACKHAWK ALL TERRAIN Tow Bar Cover #058-2 1

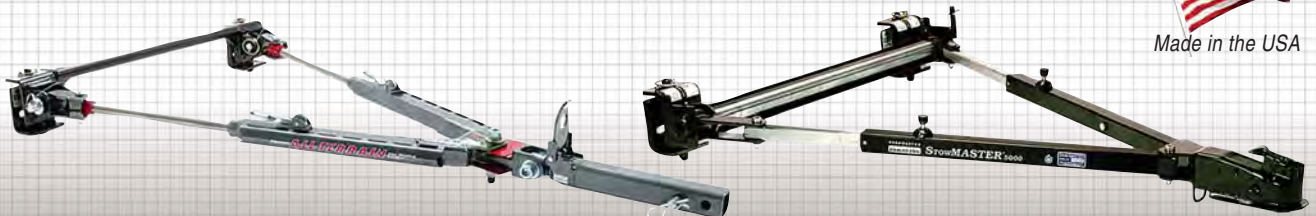

Made in the USA

Adaptor Bars



Towing and Suspension Solutions

To adapt other manufacturers' tow bars to ROADMASTER brackets...

Adaptor components shown in white

(Tow bar and mounting brackets are not included)

38177 025 Adapts Reese, Valley, Eaz-Lift, Draw-Tite and Husky car-mounted tow bars to Roadmaster brackets (see notes 1 and 2) #025 1

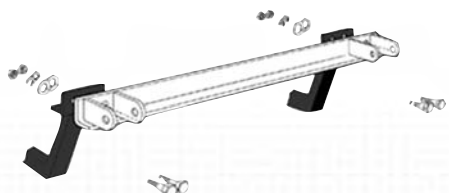

38664 032 allows you to disconnect the adapter bar and the removable front bracket arms. The Guardian rock guard will work with this adaptor (see note 2) #032 1

032 and **033** adapt motorhome-mounted Blue Ox tow bars (Aventa, Aventa II, Kar Bar, Aladdin, Alexxa, Acclaim), as well as Blue Ox "A frame" tow bars (with one- or three-pronged attachments) to ROADMASTER brackets. Also adapt Demco Aluminator, Dominator, Excalibar and Kwik-Tow tow bars to ROADMASTER brackets.

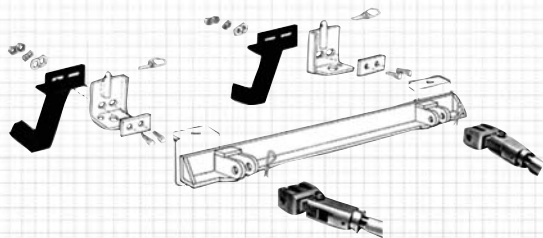

033 – The adaptor is permanently bolted to the mounting bracket (see notes 1 and 2).

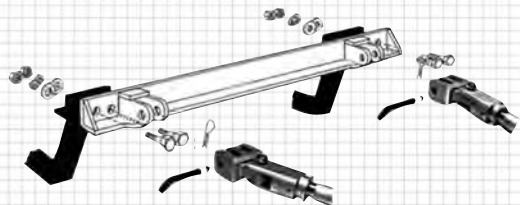

38180 038 – ^{LS} Adapts Duncan Towmatic II, Karbar and EazAligner 2000 car-mounted tow bars to ROADMASTER brackets (see notes 1 and 2). #038 1

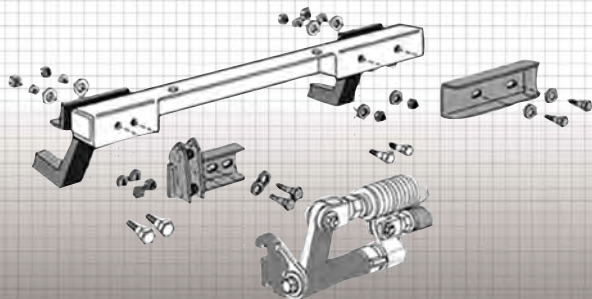

To adapt ROADMASTER tow bars to other manufacturers' brackets...

031

Adapts ROADMASTER Falcon, BlackHawk, BlackHawk All Terrain and Falcon All Terrain tow bars to Blue Ox brackets. Also adapts Sterling tow bars (with serial numbers up to 14,500) to Blue Ox brackets.



031-5

Adapts all ROADMASTER Sterling tow bars (with serial nos. above 14,501) to Blue Ox brackets.



034

Adapts ROADMASTER Falcon, BlackHawk, BlackHawk All Terrain, and Falcon All Terrain tow bars to Demco brackets. Also adapts Sterling tow bars (with serial nos. up to 14,500) to Demco brackets.



034-5

Adapts the ROADMASTER Sterling tow bar (with serial numbers above 14,501) to Demco brackets.



Note 1: in order to remove the front extensions on ROADMASTER XL or EZ Twistlock brackets, you will need quick-disconnects in addition to the adaptor.

Note 2: this adaptor does not fit MX or MS series brackets.

(Tow bars and mounting brackets are not included with adaptor bars.)



Made in the USA

Combo Kits + Padlock



Towing and Suspension Solutions

Combo kits contain all the necessary accessories for most vehicles, matched to your ROADMASTER tow bar.

Each kit contains:

- All electrical components —
- A wiring kit with four 'Hy-Power' diodes. • A bracket to mount the power cord socket.
- A power cord to connect the vehicles, with plugs and sockets for both vehicles (The Sterling All Terrain comes complete with a power cord).
- A pair of safety cables (rated at 6,000 lb., 8,000 lb., or 10,000 lb. capacity, depending on the model you chose). (The Sterling All Terrain comes complete with safety cables).
- Two case-hardened steel padlocks (keyed alike) — for added security.
- A marine-grade vinyl cover to protect your tow bar.
- A marine-grade vinyl storage bag — for all your towing accessories.



- 30137** Sterling All Terrain Combo Kit (6,000-pound capacity) #9284-2 1
- 39739** Falcon All Terrain Combo Kit (6,000-pound capacity) #9241-2 1
- 39740** BlackHawk All Terrain Combo Kit (8,000lbs Capacity) #9294-2 1
- 39379** Falcon 2 Combo Kit w/coiled wiring #9240 1
- 39380** Falcon 2 Combo Kit w/straight wiring #9241 1
- 39553** StowMaster Combo Kit W/4 Hy-Power Diodes #9254 1
- 38313** Coupler Padlock #305 6



Safety Cables

Our aircraft type, galvanized steel safety cables are continuously tested to ROADMASTER's exacting standards. Each comes fitted with heavy-duty, drop-forged steel hooks with spring-loaded latches. Vinyl coating prevents the safety cables from scratching or chipping the tow bar. Each kit contains two cables, two snap hooks, and two quick-disconnects. Rated at either 6,000 or 8,000 lb. capacity, depending on the model you choose.

- 38454** 68" 6,000 lb. Single Hook Coiled - 1 pr. #643 10
- 38181** 64" 6,000 lb. Single Hook Straight - 1 pr. #645 15
- 38183** 64" 6,000 lb. Double Hook Straight - 1 pr. #646 15
- 39566** 64" 8,000 lb. Single Hook Straight - 1 pr. #649 8

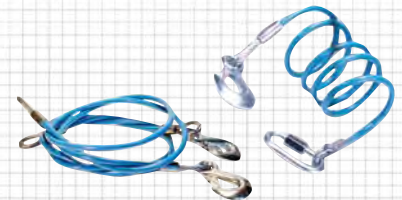

EZ Hook Safety Cable

EZ Hook safety cables are faster to connect than other cables. They have all the features of the standard cables (see above), with the addition of a unique attachment system — a stainless steel ball at the end of the cable latches into a slotted anchor plate. Included with the Sterling All Terrain tow bar, EZ Hook safety cables fit all ROADMASTER mounting brackets with quick-disconnects.

- 39030** 1pr. EZ HOOK Safety Cable with anchors. Cables are 68" long 6,000 lb. rated #655 1



Pins, Clips, Cables & Links



Towing and Suspension Solutions

It's bound to happen: a part gets lost or misplaced. Here's a partial list of the parts and accessories we have available. If it's not listed here, call us at 800-669-9690, tell us what you're missing, and we'll find what you need.

Denotes limited supply

Pins and Clips			All Terrain	Blackhawk	Eagle	Falcon	Falcon 2	Sterling	StowMaster	Tracker	Price
38832	#910026	2-pack safety pin with clasp			•	•					
38833	#910024	2-pack QD lynch pins	•	•	•	•	•	•	•		
38834	#910023	2-pack storage hairpin							•		
38836	#910028	2-pack clip only for receiver pin				•					
38338	#910029	2-pack base pin with cable and lynch pin	•	•	•	•	•	•			
38842	#910022	2-Pack Quick Links for Cables									

38338



38833



38834

Towing Accessories

QUICK-DISCONNECTS

Allows 'one-person' fast and easy mounting or removal of your StowMaster tow bar. A retrofit for older StowMaster tow bars — for quick, easy and secure connect and disconnect. Also used for mounting accessories. Replacement packs — full and half sets.

- 38191 1 Set Quick-Disconnects #201 1
- 38684 1/2 Set Quick-Disconnects; (both car sides) #222 1
- 39603 QD Base Assembly. Includes both car and motorhome QDs, crossbar, hitch pins and base pins #910021-00 1

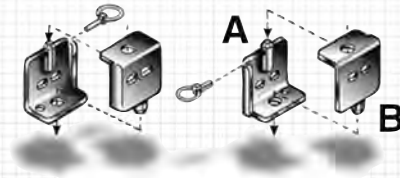

XL™ RECEIVER INSERTS

Designed for ROADMASTER XL Series brackets, these heavy gauge steel caps help keep out dirt, gravel & grime when your XL brackets are removed. Fits all 1-1/2" I.D. tubes.

- 39034 XL Receiver Inserts, 1 Pair, 1-1/2", Black (not shown) #200-5 g



LUBEMASTER™ SILICONE SPRAY

LubeMaster is the ideal lubricant for tow bars, awning arms, window tracks, folding steps, or for hundreds of other applications around the home and RV. It's a dry silicone, which doesn't attract dirt or road grime that can cause binding. Meets Volatile Organic Compound (VOC) standards.

- 38540 LUBEMASTER Silicone Spray #747 12



ADJUSTABLE TIE-DOWN STRAP

For RoadMaster tow dolly. One size adjusts to fit tires from 12" to 16". Sold per each.

- 38668 Adjustable Tie-Down Strap #2150 10



QUIET HITCH™

This anti-rattle ring slips over the tow bars stinger mount. Tightening two bolts (061) removes any free play between the stinger mount and the hitch.

- Bolts on in seconds
- Powder coated finish for maximum durability
- The 061 fit 2" hitch receivers; the 049-1 fits 2 hitch receivers

- 31820 Quiet Hitch for 2" Receivers #061 1



NEW!



Made in the USA

Hitch Accessories

HI-LOW HITCHES

Use a Hi-Low Hitch to level the RV hitch to the tow bar. Available in four-, six-, eight-, and 10-inch drops.

- Fits all square tube hitch receivers with two-inch inner diameters.

- **10,000 lb. GVWR capacity;** 400 lb. tongue weight max.

- 30393** 4" Hi-Low Hitch #048-4 1
- 30394** 6" Hi-Low Hitch #048-6 1
- 30395** 8" Hi-Low Hitch #048-8 1
- 30396** 10" Hi-Low Hitch #048-10 1



Towing and Suspension Solutions

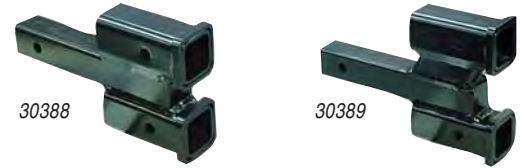

DUAL HITCH RECEIVER

Double your towing capacity while using a tow bar, and add a bike carrier using our new dual hitch receiver.

- For car and boat owners alike.
- Fits all hitch receivers.
- 10,000 lb. capacity; 400 lb. tongue wt.
- Solid steel construction.
- Computer-designed and -tested.
- Powder coated for maximum durability.

- 30388** 2" Dual Hitch Receiver #077-2 1
- 30389** 4" Dual Hitch Receiver #077-4 1



4" AND 6" HI-LOW DROP AND 12" EXTENSION

The shanks on the Hi-Low Drops can be turned up or down, for low- or high-ground clearance. The 12" extension extends the hitch receiver by 12". Only for towing a car behind a motorhome — not for use with any type of trailer.

- 38452** 4" Drop Receiver Flip to Raise 4" #070 1
- 39182** 6" Drop Receiver Flip to Raise 6" #076 1
- 38453** 12" Receiver Extension #071 1



PROTECT YOUR TOWED VEHICLE AND RV AGAINST DINGS AND ROCK CHIPS

The GUARDIAN is crafted from rotationally-molded, high-impact polyethylene to absorb the impact of rocks, gravel and road debris — instead of ricocheting it back at the motorhome. The GUARDIAN can be attached and removed in seconds, and fits all ROADMASTER tow bars equipped with quick-disconnects. Can also be used with a tow dolly to help protect your towed car by using GUARDIAN bracket part no. 2000-8. If you tow more than one vehicle, the Second Vehicle Kit has all the mounting hardware necessary to swap the GUARDIAN from one vehicle to another.

- 38539** Guardian Rock Shield #4000 10

Protection



REMOVABLE MUDFLAP SYSTEM

RoadWing's "anti-sail" design keeps the mud flaps down, where they can stay on the job — double-bolt attachment points hold the system in place, as well as level on the bevel, and grooved interior channels deflect rocks, gravel and road debris down and away from your towed vehicle or trailer. The RoadWing slides over your ball mount or tow bar stinger, and is easily attached with set bolts, or just as easily detached. The 24" x 24" flaps can be trimmed to fit nearly any vehicle. The model above (77-inch) — fit full-size trucks.

- 39179** Removable MudFlap System #4400 1



Made in the USA

Electrical

FLEXO-COIL™ CORDS



Whatever electrical system you chose, you'll need a cord to connect electricity between the towed car and the motorhome. ROADMASTER's are the best — the wires are water-oil, and chemical-resistant, and the plugs are injected with silicone to prevent corrosion. 'Flexo-Coil' cords expand to over eight feet, and conveniently contract for storage.

'Flexo-Coil' wiring kits - for tow bars without cable channel guides:

- 38186** 4-Wire 'Flexo-Coil' Kit #164 10
- 39556** 4-Wire Flexo-Coil w/Socket Brackets #1644 10
- 30146** 7-to-4 Wire 'Flexo-Coil' Kit #164-7 1
- 38187** 6-Wire 'Flexo-Coil' Kit #146 10
- 39557** 6-Wire Flexo-Coil w/Socket Brackets #1466 8
- 30148** 7-to-6 Wire 'Flexo-Coil' Kit #146-7 1

BRITE-LITE™ 3-TO-2 WIRING CONVERTER

If you have this — the motorhome has separate brake and turn signal lights; the towed vehicle has combined brake and turn signal lights.

Then you need this — the Brite-Lite wiring converter connects a vehicle with a separate brake and turn signal system to a vehicle with a combined brake and turn system, while delivering more current to the towed vehicle's brake and turn signal lights for brighter illumination.



- 38431** Brite-Lite 3-to-2 converter #732 25

By law, a towed vehicle's turn signals, running lights and brake lights **must mimic** the motorhome's. There are two ways to accomplish that: Each method has its advantages. Whichever one you chose, ROADMASTER has a kit with all the necessary components, and step-by-step instructions.

UNIVERSAL WIRING KIT

This kit uses a system of diodes to connect your towed vehicle's turn signals, running lights and brake signals to your motorhome's. Diodes prevent electrical feedback and protect both vehicles' electrical systems. The kit comes complete with:

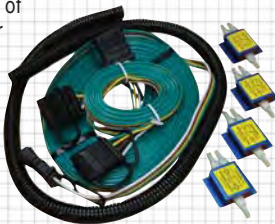

- four Hy-Power™ diodes (more diodes may be purchased separately);
- a 30-foot strand of four-wire electrical cord;
- three feet of split wire loom;
- six-foot extension cord (connects the towed vehicle to the motorhome); • a ring terminal; • cable ties;
- wire connectors; and
- step-by-step installation instructions

- 39552** Universal Wiring Kit w/4 Hy-Power Diodes #154 10
- 38430** Universal Wiring Kit (no diodes) #150 10

TAILLIGHT WIRING KIT w/bulbs

A self-contained wiring system that bypasses your towed vehicle's lighting with a set of independent plugs and sockets mounted inside the taillights.



Since the towed vehicle's electrical system is bypassed, this kit eliminates the concern of voiding the vehicle manufacturer's warranty.

Important: The towed vehicle's taillight must have room for an extra socket and bulb inside the lens housing.

- 38671** Taillight Wiring Kit w/Bulbs #155 10



Towing and Suspension Solutions



AUTOMATIC BATTERY DISCONNECT

Eliminate the inconvenience and danger of pulling your battery cable with the Automatic Battery Disconnect. The Automatic Battery Disconnect is ideal for anyone towing a Jeep Liberty, Jeep Wrangler or any other vehicle which must be towed with the battery cable disconnected, and also for anyone who wants the security of knowing they'll always have a fully-charged battery during and after towing. With the Automatic Battery Disconnect, supplemental braking systems cannot drain the battery. The Automatic Battery Disconnect comes with a marine-grade high-amperage solenoid (200-amp constant duty, 600-amp surge) and is preassembled for easy installation (average installation time: 30 to 45 minutes)



- 10007** Automatic Battery Disconnect #765 1



HUSKY MAGNETIC TOWING LIGHTS

The Husky towing lights have over 35% more holding power and larger magnets than competitive models. They include a plug cover to keep dirt and corrosion out. The magnets come with an e-coated magnet cap to eliminate rust and protect the vehicle from scratches. Wired to industry standard 4-way flat connector. Comes in a clam shell that can be used as a storage container. Includes tow vehicle hook-up plug and long 20' cord. Useful for RV, agricultural, industrial, marine and automotive needs. Complete with instructions.

- 17929** Magnetic Towing Lights #17929 10

In Section N:	Husky Hitches	Couplers	Hitch Accessories	Hitches	Tow Bars	Tow Brakes	Levels	Mirrors & Safety	Brake Controls	Towing Electrical
---------------	---------------	----------	-------------------	---------	----------	------------	--------	------------------	----------------	-------------------

HUSKY Premium Tail Light Isolators

Provides a safe and convenient way to use factory lights on towed vehicles while protecting sensitive electronics from voltage feedback.

- Permanently installs on tow vehicle, near tail lights.
- Heavy duty, 30-amp rating.
- Aluminum heat sink prevents diode failure caused by overheating.
- Easy installation: includes connectors and adhesive mounting pad.

Description	Part #
Husky Tail Light Isolator (Diode), 1/Card	39869
Husky Tail Light Isolators (Diodes), 2/Card	39870
Husky Tail Light Isolators (Diodes), 3/Card	39871
Husky Tail Light Isolators (Diodes), 4/Card	39866
Husky Tail Light Isolators (Diodes), 25/Box	39868



Premium Parking Light Isolator

Allows use of towed vehicle's lights. Prevents feedback between RV and car. If the towed vehicle's lights are turned on while still plugged into the motorhome, the motorhome will draw from the towed vehicle to supply power to all of the park lights. This will place a heavy load on the towed vehicle's wiring, and can result in severe electrical system damage. Using the Husky Parking Light Isolator will prevent this, while still allowing the motorhome to power the towed vehicle's park/tail lights.

- Permanently installs on tow vehicle near tail lights.
- Heavy duty, 30-amp rating.
- Aluminum heat sink prevents diode failure caused by overheating.
- Easy installation: includes connectors and adhesive mounting pad.

Parking Light Diode, 1/Card	39867
-----------------------------	-------

Tail Light Isolator Wiring Kit

Recommended installation kit for Husky Premium Taillight Isolators.

- Use the towed vehicle's light system for towing.
- Permanently installs on towed vehicle.
- 26' of 16 gauge ribbon wire with 4-way flat connector.
- Includes wire, connectors and installation hardware. *Diode kits sold separately.*

Wiring Kit for Isolator, 1/Card	13984
---------------------------------	-------

Tail Light Isolator Wiring Kit with Bulbs

Isolated, internal light system for towing. Eliminates cutting into factory wires.

- Use this kit in place of tail light isolators.
- Permanently installs on towed vehicle.
- Fits most vehicles with clearance in taillight housing.
- 26' of 16 gauge ribbon wire with 4-way flat connector.
- Easy installation includes wires, connectors, bulbs, sockets, installation hardware and instructions.

Tail Light Wiring Kit, 1/Card	13985
-------------------------------	-------

Tow Bar Wire Harness

Recommended for all tow bars. 80" long with 4-pin flat connectors.

- Permanently installs on tow bar.
- Easy installation.
- Includes wire ties.

Tow Bar Wiring Harness, 1/Card	13986
--------------------------------	-------

Tow Bar Wiring Kit

Recommended installation kit for Husky Premium Tail Light Isolators.

- Permanently installs on towed vehicle.
- Includes 26' of 16 gauge wire.
- Easy installation includes, cables, connectors and installation hardware.

Tow Bar Wiring Kit, 1/Card	13987
----------------------------	-------



ROADMASTER Hy-Power Diodes

Diodes are used to tie into the towed vehicle's brake light, running light and turn signal wiring, and connect it to the motorhome. Diodes permit electrical current to flow in only one direction — from the motorhome to the towed vehicle — preventing electrical feedback and the damage it can cause to the towed vehicle's dashboard electronics. ROADMASTER's Hy-Power diodes have a heavy-duty, anodized aluminum heat sink, and each diode is protected against the elements.

Four-pack required for most vehicles. Includes detailed wiring instructions.



- 38188** Single Hy-Power Diode #790 ²⁵
- 38189** 2-Pack Hy-Power Diodes #792 ¹⁵
- 38190** 3-Pack Hy-Power Diodes #793 ¹⁵
- 39028** 4-Pack Hy-Power Diodes #794 ¹
- 38485** 25-Pack Diodes, (bulk pack) #790-25 ¹



Towing and Suspension Solutions

PARK LIGHT DIODE

Problem: Electrical damage can occur to the towed vehicle if its headlights are turned on while still connected to the motorhome.

Solution: Use a Park Light Diode to stop any interaction between the two park light systems, preventing electrical feedback and electrical damage.

- 38891** Single Park Light Diode #690 ¹⁰



“Direct” Proportional Braking



Towing and Suspension Solutions

BRAKEMASTER[™] by ROADMASTER PROPORTIONATE TOWED CAR BRAKING SYSTEM



What is BrakeMaster?

BrakeMaster, ROADMASTER's 'direct' proportional braking system, is the best supplemental braking system available, and the easiest to use. Connects directly to the motorhome's air or hydraulic braking system, for rock-solid, reliable braking — brake line pressure in the motorhome controls the brakes in the towed vehicle. Because it connects directly to what powers your motorhome's brakes, BrakeMaster is a truly proportional, truly synchronized braking system — however you brake the motorhome, BrakeMaster automatically applies the same pressure. Every time. Connects and disconnects from the towed vehicle in under a minute, without any tools, adjustments or settings — attach the brake pedal clamp, secure to the floor or seat adaptor, quick-connect the air hose, and you're ready to tow.

Weighs just 5-1/2 pounds and measures under two feet in length — stores almost anywhere.

- works in most motorhomes.
- works in virtually any towed vehicle with power brakes.
 - motorhome monitor provides a visual reference of braking activity.
 - easily disconnects from the brake pedal — from towed car to road car in seconds!
 - includes a break away emergency braking system.
 - meets U.S. and Canadian braking requirements.

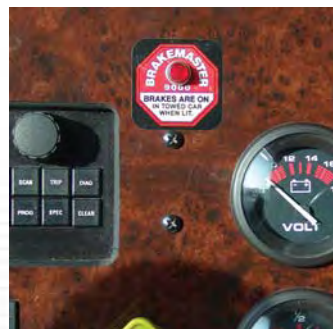

BrakeMaster LED

An LED in the motorhome provides a visual reference of braking activity.

Optional seat adaptors

ROADMASTER seat adaptors are required on some vehicles, and simplify the installation on others. Contact us to see if your vehicle needs a seat adaptor, or visit www.roadmasterinc.com.



STOP 30% FASTER!
(Your results may vary.)

50mph
braking test results

Motorhome ONLY 132	
209'	
137'	

Motorhome and car WITHOUT supplemental brakes

Motorhome and car WITH supplemental brakes

- 38983** Brakemaster™ 9060 w/BrakeAway™ for Motorhomes with Hydraulic Brakes #9060 1
- 38737** Brakemaster™ 9100 for Motorhomes with Air or Air Over Hydraulic Brakes #9100 1
- 38984** Brakemaster™ 9160 w/BrakeAway™ for Motorhomes with Air or Air Over Hydraulic Brakes #9160 1

BrakeMaster reliability for your hybrid or Hummer!

With the Brake Pressure Reducer, you can install BrakeMaster in a Ford Escape hybrid, a Mercury Mariner hybrid, a Hummer H3, or any vehicle with an 'active' (or, 'continuous power assist') braking system. By working in conjunction with these braking systems, the 900002 delivers a correspondingly reduced braking pressure that eliminates over-braking issues previously associated with these vehicles, such as 'flat-spotting' the tires or overheating the brakes. Connects to the BrakeMaster air line in just a few minutes; turn the variable control to set and lock in the precise braking pressure.

- 30836** Brake Pressure Reducer #900002 1



30836



Made in the USA

CAR-TOWING ACCESSORIES

TOWING & SAFETY

N

In Section N: Husky Hitches Couplers Hitch Accessories Hitches Tow Bars Tow Brakes Levels Mirrors & Safety Brake Controls Towing Electrical



ROCK SOLID BACK GUARD FOR MOTORHOMES

Protection that won't fly away! Durable, lightweight materials protect the back of your coach, vehicle in tow, and nearby cars. Aerodynamic design reduces wind drag. Strips won't allow excess heat build-up under your coach. Individual strips can be trimmed to fit and removed to accommodate mufflers, hitches, wiring, etc. 1-year guarantee by manufacturer.

77309 Rock Solid for Class A Motorhomes, Two Pieces, 48" x 20" #00002 5

79009 Rock Solid for Class C and Smaller Class A Motorhomes, Two Pieces, 48" x 16" #01696 1



Easy Mount: No Drilling In Your Truck! ROCK SOLID™ "FULL WIDTH" PROTECTIVE ROCK & SPLASH GUARD KIT For Pickups

Your truck or van kicks up debris that can damage your vehicle or boat in tow. Avoid those nasty chips and dents with this "full width" protective rock and splash guard. Easily fastens to your 2" receiver hitch insert. The mounting system allows for easy removal from the vehicle when not towing. Constructed of durable, all-weather, therma-plastic rubber. Rock Solid™ provides protection that mud flaps cannot. The kit includes two 34" x 14" sections, 4' pre-drilled steel channel, hitch bracket and all installation hardware. Perfect size for van, pickup and sport utility vehicles. 1-year guarantee by mfr.

79648 Rock Solid for Pickups #00011 1



ROCK SOLID ULTRA GUARD FOR MOTORHOMES

ATTRACTIVE... ONE PIECE... ALL RUBBER MOLDED ROCK GUARD

Provides tough shielding for the back of your coach and your vehicle in tow from rocks, diesel oil, gravel, tar and other road debris. Made of a special blend of rubber with reinforcing fabric and ribs molded in to reduce wind sail and to ensure durability. One-piece construction attaches to your coach with a standard piece of angle iron or tubing (not included). Can be trimmed and cut to fit almost any motorhome.

Ultra Guard for Class A Motorhomes:

70214 94" W x 20" L #00014 1

70385 94" W x 16" L #00016 1



73196

SMART SOLUTIONS ULTRA PLATE ACCESSORY FOR ULTRA GUARD™

Improves the looks of your RV while reducing the sailing of your Ultra Guard™. Stainless steel polished to a mirror-like finish. 93" L x 6" H x 3/32" thick.

73196 Ultra Plate Accessory for Ultra Guard #00093 1

ULTRA GUARD MOUNT

Pre-drilled mount for Ultra Guard, 94" x 1.5" x 1.5". Angled steel makes installation a snap.

73197 Ultra Guard Mount #00094 1



ULTRA GUARD FOR TRUCKS & VANS

Ideal for pickup trucks and all types of SUVs. Ultra Guard protects towed trailers, boats and fifth-wheels from flying gravel, tar, stones and other road debris. Made of 3/8" thick molded rubber with a nylon cord impregnation, Ultra Guard is durable and attractive. Its design includes anti-sail stiffening ribs to ensure minimal sail in the wind. Unique installation system allows it to mount to the ball mount (hitch insert) of a two-inch receiver hitch. It is easy to install and remove (no drilling into the bumper). Holes for wiring and chains can easily be cut or notched out of the rubber. 70" W x 16".

72042 Ultra Guard For Trucks And Vans #00015 1

85480 1" x 1" x 70" Angled Steel Mounting Bar for Ultra Guard with Pre-Drilled Holes #00070 1



SPLASH STOP

Brush-like material attaches to rear of motorhome to keep tar and debris from hitting your towed vehicle. Also keeps back of motorhome cleaner. Lightweight material won't increase wind drag or heat build-up; won't crack; is easy to install and remove; won't interfere with normal hitch operation. 8' L (two 4' sections).

Splash Stop:

77764 11" H #341011-3007299 12

76630 16" H #341016-3006154 12

76631 22" H #341022-3006155 12

The most trusted name in towing!

Aventa™ II Tow Bar BX7335

NEW!



Stores on Motorhome

With its 6,000 lb. towing capacity, the Aventa™ II lets our customers tow just about anything on wheels. This steel, motorhome-mounted tow bar automatically aligns for quick hookups and folds away for easy storage. The Aventa™ II can tow heavier cars, trucks, and SUVs.

S/O BX7335 Aventa™ II Tow Bar

ALLURE™ TOW BAR



Stores on Vehicle

The class IV Allure™ tow bar is specifically designed to fit heavy-duty vehicles, provide a tight turning radius and haul heavy loads with ease. With 10,000 lb of towing capacity, it features a pintle along with collapsible legs for safer and easier coupling. 10,000 lb safety cables are included.

S/O Allure™ Tow Bar #BX7460P



S/O BX88248, Allure™ 2" Ball Adapter
S/O BX88249, Allure™ 2" Receiver Adapter
S/O BX88250, Allure™ 2" Clevis Adapter

Aventa® LX Tow Bar

10,000 lb. Towing Capacity!



Stores on Motorhome

All Blue Ox® tow bars are FEA certified and come with a three year warranty!

The class IV Aventa® LX towbar has a ball in socket design that reduces wear points between the coach and the tow car.

Hook up and disconnect is a cinch with the 360 degree swivel and it easily connects and disconnects when you're out of alignment or on uneven surfaces. With our exclusive offset triple lug connection, towing forces on the tow car are minimized. The self-tightening and self-lubricating pivot connection Aventa® LX comes standard with 10,000 lb. safety cables.

30913 Aventa® LX #BX7445 1

S/O BX7450 Aventa® LX with 2-1/2" Receiver Tube



Strong As An Ox™

ACCLAIM™ TOW BAR

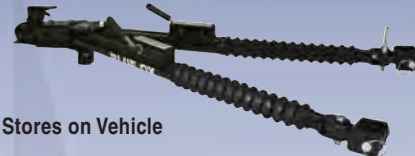

Stores on Vehicle

The class III Acclaim™ tow bar is virtually maintenance-free with easy release handles and protective rubber boots. It can tow vehicles up to 5,000 lbs and is constructed with solid steel. This tow bar requires a 2" ball. 5,000 lb safety cables are included.

30910 Acclaim™ #BX4330 1

ALADDIN® TOW BAR



Stores on Motorhome

The class III 5,000 lb towing capacity Aladdin® tow bar is the lightest tow bar in the Blue Ox product line. Weighing in at only 37 pounds, this ultra-light, self-aligning towbar, with a 3 axis swivel design quickly connects and disconnects in minutes flat. Its exclusive offset triple lug connection minimizes towing forces on the tow car. 5,000 lb safety cables come standard.

30909 Aladdin® #BX4325 1

AMBASSADOR™ TOW BAR



A-Frame

The class III Ambassador™ tow bar is made of solid steel and can safely tow up to 5,000 lbs. This tow bar requires a 2" ball. Safety cables are not included.

30911 Ambassador™ #BX7302 1

ADVENTURER™ TOW BAR



A-Frame

The class III Adventurer™ tow bar is perfect for part-timers. It is a universal option to safely tow up to 5,000 lbs. The adjustable legs expand up to 41" wide and allow safer and easier coupling and uncoupling. It folds easily for storage and requires a 2" ball. Safety cables are not included.

30912 Adventurer™ #BX7322 1

BLUE OX TOW BARS

In Section N:	Husky Hitches	Couplers	Hitch Accessories	Hitches	Tow Bars	Tow Brakes	Levels	Mirrors & Safety	Brake Controls	Towing Electrical
---------------	---------------	----------	-------------------	---------	----------	------------	--------	------------------	----------------	-------------------



Baseplate shown on a 2007 Jeep Wrangler Rubicon

Blue Ox Baseplates

Choosing Blue Ox® is like having a baseplate custom-made for your tow vehicle — only faster! Our baseplates are easy on your suspension and even easier on the eyes. We've designed them with hidden reinforcement. We don't offer a one-size-fits-all support system, but rather a system that's shock absorbing and integrated into the individual bumper frame with the bumper design of your vehicle. Our philosophy is to let the baseplate torsion, or flex, absorb the forces of towing rather than rigidly transferring the forces to the frame of the vehicle. Our state-of-the-art removable tabs give you the option to remove your towing tabs so you can drive away leaving the "tow car" look behind. There's no need to get on your knees or reach under your vehicle! Removing the tabs or re-inserting them is quick and easy, taking less time to get up and go. **All Blue Ox® baseplates come with a three year warranty. See fit guide.**

All Blue Ox® baseplates are designed with a built-in port for the electrical plug!



Each baseplate are built with safety cable hooks and Finite Elemental Analysis tested.

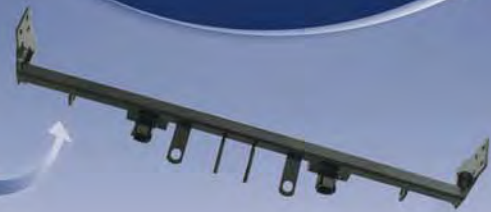

1 Locate the removable tab receiver and place the removable tab in as far as it will go.



2 Begin turning the removable tab in a counter-clockwise position to safely lock the tab.



3 After you hear the removable tab "click" you're ready to tow!



Strong As An Ox™

BULB & SOCKET WIRING KIT



Everything you need to wire most towed vehicles. It does not tap into any of the vehicle's existing wiring. Fits most vehicles with clearance in taillight. Operated by the towing vehicle.

- 30967** Wiring Kit, each #BX8869 1
- 30931** Bulb/Socket (less ribbon wire), Pk/10 #BX88184 1

DIODE BLOCKS



Replacement diode block for wiring kits. Molded and sealed to keep moisture out. Contains six, 6A diodes.

- 30965** Diode Block 9 Terminal, Ea #BX8863 1

Replacement diode for wiring kits. Molded and sealed to keep moisture out. Each block contains two 6A diodes.

- 30966** Diode Block, Ea #BX8864 1
- 30926** Diode Block, 12/Pack #BX88159 1
- 30960** Wire Kit (4) Diodes #BX8848 1
- 30916** Taillight Wiring Kit (9 term) #BX8811 1
- 30959** Wire Kit (3) Diodes #BX8847 1

COILED ELECTRICAL CABLES



For ease of use and storage, these cables expand from 1'-7". Wire connections encased in silicone for long life and reversible plug connectors allow quick hook-ups. Locking connector and expanding cable virtually eliminate accidental disconnection. Trailer plugs included.

- 30963** 4-Wire Coiled Electric Cable (includes 2 female receptors) #BX8861 1
 - 30964** 6-Wire Coiled Electric Cable (includes 2 female receptors) Shown #BX8862 1
 - 30941** 7 to 6 Coiled Electric Cable (includes 1 female receptor) #BX88206 1
- S/O SC9002, 6-Wire, 12' Cable

TOW BAR COVERS



These heavy-duty, vinyl-coated fabric covers keep your tow bar clean and protected when stored. Easily put on and taken off.

- 30969** Aventa® LX/Aladin®/Aventa® II Alexis™ Tow Bar Cover #BX8875 1
- 30925** Acclaim™ (Shown Upper) #BX88156 1

Vinyl bag for carrying and storing accessories like tabs, cables, locks, etc. 13" long x 7" high. Keeps customer's trunk or basement clean.

- 30923** Vinyl Bag #BX88134 1

ACCESSORIES KITS



Contains safety cables, bulb and socket kit, 6-wire electrical cable, 3 lock set, 4-diode kit and cover.

- 31222** 5,000# safety cables, 6 wire electrical cable, bulb and socket kit, 3 lock set and cover #BX88109 1
- 31221** 10,000# safety cables, 6 wire electrical cable, bulb and socket kit, 3 lock set, cover (Shown) #BX88190 1

Aventa LX®/Aladdin® Accessories Kits

- 31234** 6 wire electrical cable, bulb and socket kit, 3 lock set and tow bar cover #BX88229 1
- 30955** 7-6 electrical cable, bulb and socket kit, 3 lock set and tow bar cover #BX88231 1

UNIVERSAL TOWING ACCESSORIES KITS

Same accessories as shown above but includes only one 5/8" receiver lock, no cover and no diode kit.

- 31204** 5,000# Tow Kit (Pictured) with 6 wire electrical cable #BX88191 1
- 31203** 10,000# Tow Kit with 6 wire electrical cable #BX88192 1
- 30956** 5,000# safety cables, 7-6 electrical cable, bulb and socket kit, 1-5/8" lock #BX88232 1
- 30957** 10,000# Motorhome mount 7 to 6 kit with 7 to 6 wire coiled electrical cable #BX88233 1

SAFETY CABLE KITS



Aircraft grade braided safety cables coil into shape for easy storage. Plastic-coated for more resistance. Heavy-gauge steel connectors. Two (2) per pack.

- 30938** 5,000# GVW 7' (Shown) #BX88196 1
- 30939** 10,000# GVW 7' #BX88197 1
- 30942** Baseplate Cable Kit 5,000# #BX88207 1
- 30943** Baseplate Cable Kit 10,000# #BX88208 1

ADAPTER KITS

Universal adapter kit adapts Valley, Reese®, DrawTite®, EazLift® Universal, Husky® and other tow bars made from 1" x 2" tube to a Blue Ox® baseplate.

- 30958** A-Frame Kit #BX8833 1

Adapts Blue Ox tow bar to a Reese bracket.

- 30915** Reese Adapter #BX88102 1

Adapts non-24" spaced Blue Ox® baseplates to receive A-frame, Rangefinder® and Rangefinder® II tow bars.

- 30922** RangeFinder II #BX88133 1

Adapts Blue Ox® baseplates with holes to accommodate the Duncan® quick attach Eaz-Aligner™ and Towmatic™ II Tow Bars

- 30924** Duncan Adapter #BX88135 1

Blue Ox® triple lug kit for Roadmaster® adapter to Falcon™ All Terrain™, Sterling All Terrain™, and Eagle™ tow bars.

S/O BX88151, Steel Triple Lug Aventa® and Roadmaster Kit

Adapts Blue Ox® tow bar to Roadmaster® bracket. Includes cross bar.

- 30930** Roadmaster Adapter Kit #BX88178 1

The BX88185 Adapter Kit is designed to adapt Valley, Reese, DrawTite, EazLift and Husky tow bars to Roadmaster brackets which are equipped with the cross bar already.



- 30932** Roadmaster Kit (Shown) #BX88185 1

General purpose adapter kit adapts non-Blue Ox® baseplates to Blue Ox® tow bars with cross angle. Also a foundation to build your own baseplate to fit Blue Ox® tow bars.

- 30954** Univ. Adapter #BX88230 1