

In Section L:	Fresh Water Line	Filters	Winterizing	Pumps	Faucet & Shower	Sink & Drain	Holding Tanks	Drain Valves & Fittings	Drain Hose	Chemicals & Toilets
---------------	------------------	---------	-------------	-------	-----------------	--------------	---------------	-------------------------	------------	---------------------



Hose-end strain relief

Easy-to-thread ends

**AQUA PRO DRINKING WATER HOSES**

Drinking water safe. Stops kinks at the outlet with the attached strain relief. Made with flexible, easy to coil components. Manufactured with FDA approved materials for safe drinking water. 5-ply construction. 250 psi burst strength. 10-year Aqua Pro warranty.

**Aqua Pro Water Line:**

20150	1/2" x 25'	#20150-AP	10
20151	1/2" x 50'	#20151-AP	10
21317	5/8" x 25'	#21317-AP	10
21318	5/8" x 50'	#21318-AP	5



### TEKNOR APEX HOSES

- Lead-free™ construction compliant with RoHS standards restricting lead content to less than one-tenth of 1% lead by weight in homogeneous material.
- Manufactured with F.D.A. sanctioned materials. Drinking Water Safe.

#### AQUA-FLEX HOSE

- ThumThing® coupling for easier attachment to the faucet.

#### Aqua-Flex Water Line:

- |       |            |          |    |
|-------|------------|----------|----|
| 20125 | 1/2" x 25' | #7503-25 | 10 |
| 20126 | 1/2" x 50' | #7503-50 | 10 |

#### NEVERKINK SELF-STRAIGHTENING HOSE

- Constructed with NTS Reflex Mesh® patented technology eliminates kinks, twists & tangles.
- Grip-Tite® coupling for easy, leak free attachment at the faucet.

#### NeverKink RV/Marine Hoses:

- |       |            |          |    |
|-------|------------|----------|----|
| 28043 | 1/2" x 25' | #7602-25 | 10 |
| 28044 | 5/8" x 25' | #8602-25 | 10 |
| 28045 | 5/8" x 50' | #8602-50 | 5  |



### AQUA-FRESH HIGH-PRESSURE DRINKING WATER HOSE

High-pressure, fresh water drinking hose. Easy-to-use Hose Gripper included. 1/2" hoses 160 psi working pressure. Non-toxic. 10-yr. mfr. warranty. White.

#### Drinking Water Hose:

- |       |     |           |    |
|-------|-----|-----------|----|
| 28012 | 4'  | #W01-5048 | 10 |
| 28013 | 10' | #W01-5120 | 10 |



### AMERICAN SPECIALTY MFG. HANDI-HOSE AND REEL

Handi-Hose is a compact, lightweight, extremely durable water hose with standard garden hose couplings. Remains pliable in all weather. Built-in self-squeegee system. Safe for drinking water; rated by FDA as non-toxic. White. Replacement hose also available.

- |       |                 |         |   |
|-------|-----------------|---------|---|
| 21721 | 25' Hose w/Reel | #MRT-25 | 6 |
| 20021 | 50' Hose w/Reel | #MRT-50 | 6 |
| 24422 | 25' Hose Only   | #MHT-25 | 1 |

### AMERICAN SPECIALTY UTILITY WATER HOSE

Don't drag out that long tangled hose for a small job! FDA approved hose is drinking water safe and lightweight.

- |       |                    |       |    |
|-------|--------------------|-------|----|
| 25771 | Utility Hose, 4' L | #UT-4 | 12 |
|-------|--------------------|-------|----|



### VALTERRA HIGH PRESSURE FRESH WATER LINES

For underground application, for permanent or long water line hookups. May be buried below frost line to help prevent freezing. Will not corrode or rot. Tasteless, odorless, non-toxic. Safe for drinking water. Safe for permanent and semi-permanent cold water application. Bursting pressure 720 psi; working pressure 180 psi.

#### Ebonyline High Pressure Water Line:

- |       |            |           |    |
|-------|------------|-----------|----|
| 20142 | 1/2" x 10' | #W01-0010 | 10 |
| 20157 | 1/2" x 15' | #W01-0011 | 6  |
| 20158 | 1/2" x 25' | #W01-0012 | 5  |



### TEKNOR APEX STOW-A-WAY HOSE CARRY STRAP

For storing and carrying. Adjustable strap holds a variety of hose lengths. Convenient one piece, sturdy construction.

- |       |                  |         |   |
|-------|------------------|---------|---|
| 26023 | Stow-A-Way Strap | #HH-102 | 1 |
|-------|------------------|---------|---|

In Section L:	Fresh Water Line	Filters	Winterizing	Pumps	Faucet & Shower	Sink & Drain	Holding Tanks	Drain Valves & Fittings	Drain Hose	Chemicals & Toilets
---------------	------------------	---------	-------------	-------	-----------------	--------------	---------------	-------------------------	------------	---------------------

### AQUA PRO COILED WASHDOWN HOSES WITH NOZZLE

- 1/2" Inner Diameter
- UV Resistant
- 3/4" Solid Brass Fittings
- Self-Coiling, No Kink, Space Saving Design
- Non-Drinkable Hose
- 6 Position Adjustable ABS Plastic Nozzle.

Washdown hoses with nozzle:

- 20092** 25' Coiled Washdown Hose with nozzle, 25' Polyurethane Hose  
#P-0441BA 5
- 20098** 50' Coiled Washdown Hose with nozzle, 50' Polyurethane Hose  
#P-0442BA 5



### AQUA PRO PLASTIC HOSE ELBOWS

- For RV, Home Faucet or Behind Washer
- Features Quick Grip For Easy On & Off

45° and 90° hose elbows allow the water to flow freely by helping to eliminate kinks in the hose. Plastic elbow is made of food-grade, non-toxic ABS plastic with UV stabilizer for long-lasting, trouble-free use. Carded.

Plastic Hose Elbow:

- 24988** Hose Elbow, 90° #24988 20
- 27987** Hose Elbow, 45° #27987 24



**CAMCO WATER BANDIT**



Hook this 3-1/4" connector to any standard-size unthreaded faucet or those with stripped threads and attach your garden hose. Stop wasting water due to poor connections.

- 28383** Water Bandit #22484 5



**VALTERRA EZ COIL-N-STORE HOSE**

- Multiple uses: RV - Home - Garden.
- Quick Connect fittings for easy installation.

Coiling water hose with new quick connect fittings. Compliant with lead-free CA laws. Self coiling and easy to store drinking water hose recoils to 15".

- 20227** 25' EZ Coil-N-Store Hose  
#W01-0022 12



### JR PRODUCTS CAP, STRAP & SPOUT REPLACEMENTS

FOR GRAVITY WATER FILLS

This cap, strap and spout is the original replacement for most gravity style fresh water fills. Cap has a tab style, non-threaded type twist lock to assure a good seal to your water fill. Strap is heavy duty plastic which holds up to the UV rays and weather better than most rubber styles. Spout is barbed for easy replacement and will accept either 1-1/4" or 1-3/8" water fill hose.

Replacement Cap & Fill Spout, Packaged:

- 45224** Black #222/224BK-A 24
- 21678** Colonial White #222/224CW-A 1
- 25674** Polar White #222/224PW-A 1

Replacement Cap & Strap only, Packaged:

- 45225** Black #222BK-A 24
- 27788** Colonial White #222CW-A 1
- 27789** Polar White #222PW-A 1



**VALTERRA PISTOL NOZZLE**

Pistol-grip nozzle for your water hose has a fully adjustable spray—easier to control water while cleaning your RV or boat or watering the roses.

Pistol Nozzle, Carded:

- 25531** Plastic #A01-0136VP 35
- 25532** Metal #A01-0134VP 30



**AQUA PRO CAP & PLUG**

Keep dirt & debris out of fresh water hoses or regulators. Male threaded replacement plugs for most water fills with brass garden hose connections. Female threaded cap for use on any male threaded garden hose end or water regulator. Will fit any 3/4" male garden hose thread. Includes strap. White.

- 27838** Plug & Strap, Bulk #27838 1
- 27839** Plug & Strap, CD/1 #27839 1
- 27917** Cap & Strap, CD/1 #27917 1

### VALTERRA DRINKING WATER HOSE STORAGE CAPS

Easily attaches to hose end to keep out bugs and dirt. Vent holes inhibit bacteria growth.



- 20640** Hose Caps #A0171VP 24

## VALTERRA FRESH WATER HOSE ACCESSORIES



25523

25524

25525

"HOSE FIXER"  
WATER HOSE REPAIR FITTINGS

Save that water hose. In-line mender, fixes 1/2" or 5/8" hose. Simply cut hose evenly at break or damage, insert connector, fasten the 2 clamps. Great for making extended length hoses too. Also available: female and male repair ends.

*Hose Fixer, Carded:*

**25523** Hose x Male Hose Thread  
#A01-0050VP 1

**25524** Hose x Female Hose Thread  
#A01-0055VP 1

**25525** Hose x Hose #A01-0060VP 1



28014

20086

## 3/4" HOSE CAP, HOSE PLUG

*Male Threaded Hose Plug w/Strap, Off-White:*

**28104** 3/4", Carded #T1020-1EVP 5

**20086** 3/4", Bulk #T1020-1E 1

*Hose Cap with Strap, Carded:*

**28014** 3/4", Black #T1020-1DVP 1

**28010** 3/4", White #T1020-1DWVP 1

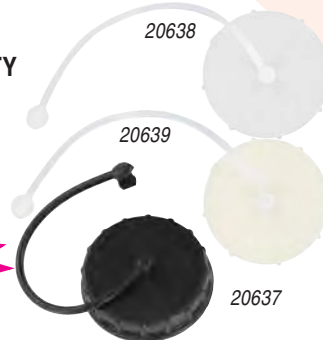
GRAVITY  
WATER  
INLET  
CAP

20638

20639

20637

Cap and strap for fresh water gravity fills. Bayonet tab style for quick reliable seal.

*Gravity Water Inlet Cap, Carded:*

**20637** Black #A0120SBKVP 10

**20638** White #A0120SVP 24

**20639** Colonial White #A0121SVP 24

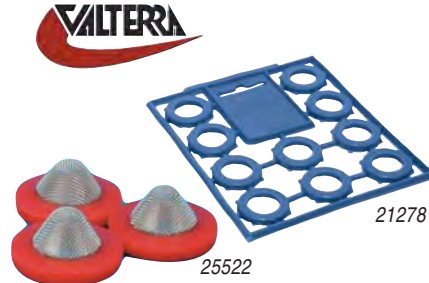

21278

25522

## HOSE WASHERS

## GARDEN HOSE WASHERS

Garden hose washers with hanger.

**21278** Washers, CD/10 #W1516VP 1

## GARDEN HOSE WASHERS WITH SCREEN

**25522** Screen Washers, CD/3  
#W1526VP 1

QUICK CONNECT  
WITH 90° HOSE SAVER  
ADAPTER

90° hose saver adapter makes RV water hookup quick and easy. Includes spare straight adapter. Plastic. Carded.

**25527** Quick Connect/Adapter  
#A01-0137VP 1



24632

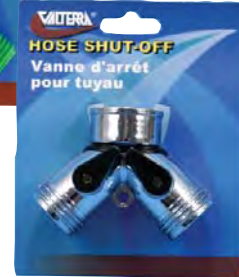

24633



25780



25942



24631

## HOSE SHUT-OFFS

## PLASTIC HOSE SHUT-OFF

**24631** Hose Shut-Off, CD/1  
#A01-0125VP 1

## SIAMESE HOSE SHUT-OFF

**24632** Plastic Siamese Hose Shut-Off, CD/1  
#A01-0130VP 24

**24633** Zinc Siamese Hose Shut-Off, CD/1  
#A01-0131VP 24

*Fresh Water Valve!*  
EZ DIAL 2 WAY HOSE SHUT OFF

Easy to grip, easy to turn dial. Control water direction with a trouble-free turn of the dial.

**25780** EZ Dial 2 way hose shut off  
#A01-0132VP 1

HI FLOW SHUT-OFF VALVE—  
GREAT FOR USE WITH TANK RINSERS!

Hi Flow Shut-Off Valve has a unique 3/8" larger internal opening for maximum water flow vs. the 5/16" opening common on most import shut-off valves. It is an ideal shut-off valve for use with any tank flushing product.

**25942** Hi Flow Shut-Off Valve, Carded  
#A01-0144VP 30



21277

20075

## VALTERRA QUICK FILL PIGTAILS

Quick Fill Pigtail with shut-off includes a large 3/8" opening valve and 5/8" tubing for the maximum fill rate. Quick Fill Pigtail reduces back flow pressure, cutting fill time in half. Easily slips into all water tank fill fittings.

*Quick Fill Pigtail Water Tank Filler:*

**20075** Without Shut-Off Valve  
#A01-0030VP 1

**21277** With Shut-Off Valve  
#A01-0031VP 1



### AQUA PRO LEAD-FREE HOSE SAVER

90° hose saver prevents hose from kinking or pinching. Features pre-assembled EZ hose gripper for ease of use. Built-in strainer on one end. Great for RVs, homes, or boats.

**20647** 90° Hose Saver, Brass, Lead-Free, Carded #A20647 50



### VALTERRA HOSE SAVERS

#### 45 DEGREE HOSE SAVER

Prevents hose from crimping or pinching. EZ Hose gripper pre-assembled for ease of use. Works for RV's or homes. Brass. Carded.

**27922** LS 45°, Carded (Not approved for sale in CA or VT) #A01-0118VP 1

**20459** 45°, Carded, Lead free #A01-0019VP 25

#### 90 DEGREE HOSE SAVER LEAD-FREE BRASS

90 degree hose saver prevents hose from crimping or pinching. Lead-free brass meets CA & VT laws on lead content for drinking water fixtures. Includes EZ hose gripper. Works on RV 's or homes.

**20054** 90° Hose Saver, Lead-free, Carded #A01-0020VP 50

### VALTERRA HOSE SAVER WITH SPRING

You know those times you really wish you could bend that hose connection "just so"? Here's the solution. Valterra Hose Saver with Spring prevents hose kinking at the faucet or RV connection. Medical grade plastic; drinking water safe.

**28348** Hose Saver with Spring #A01-0040VP 5



### AQUA PRO PRODUCTS

#### RV WATER REGULATOR

Protect your RV plumbing system from damage due to high pressure. Outlet pressure is preset to 45 psi. Fits all standard garden hose and hose bib type connections. The "Easy Gripper" makes installation easy, and eliminates the need for tools. Made of high quality, food grade, non toxic materials that meet IAPMO and NSF requirements. Standard models include an "Easy-Gripper" and a washer w/strainer, are rated for 150 psi, max, and have a 1-yr warranty. Deluxe models include an "Easy-Gripper" and a washer w/strainer, male and female protective covers with "Keeper" straps to keep dirt and debris out during storage, are rated for 300 psi, max, and have a 2 yr warranty.

Water Regulator:

**27549** Standard, CD/1 #27549 48

**27550** Standard, Box/1 #27550 50

**27866** Deluxe, CD/1 #27866 96



Deluxe Regulator



Standard Regulator



27784



27866

#### UNIVERSAL GAUGE ADAPTER

Monitor water supply pressure to your RV plumbing system to help prevent damage due to high pressure. Can be used inline with any hose bib type water regulator or any water line with a garden hose type connection. Rated for 300 psi. Made of food grade, non-toxic materials. 1-year warranty.

**27784** Universal, CD/1 #27784 6



### VALTERRA PRESSURE GAUGE

Pressure gauge adapts for use with standard water regulators. Allows you to know the hook up water pressure, since high water pressure can damage your RV plumbing system.

**27658** Water Pressure Gauge, Carded (Not approved for sale in CA or VT) #A01-0112VP 1

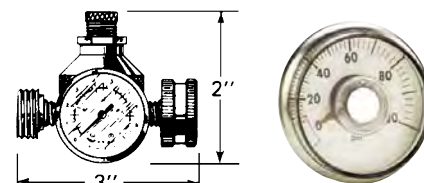

### WATER PRESSURE REGULATOR

Takes the worry out of replenishing your water tank by automatically turning the water off when pressure reaches 40 lbs. 3/4" NH hose connection. Gauged version adjusts from 0 to 60 lbs. These valves are especially designed for units with self-contained water supply tanks. The valve will also supply water automatically as needed to the tank for overnight or semi-permanent stays, saving wear and tear on the pump or compressor. Adjustable pressure; and can be easily disassembled for cleaning.

Water Pressure Regulator:

**20153** With Gauge #0355020 1

### JR PRODUCTS RUBBER DUST PLUG

Original replacement city water fill dust cover. Made of flexible 100% rubber for long lasting use. Non-threaded for easier use; installs quickly to any city water fill.

**78838** Dust Plug #422-PW-A 24





## VALTERRA WATER REGULATORS

## WATER REGULATOR

Protects your RV's or boat's plumbing system against extreme high pressures. Outlet pressure factory set at 45 psi. Fits all standard water hose and campground water risers. Includes easy to use hose gripper.

## Water Regulator

(Not approved for sale in CA or VT):

**27374** Bulk #A01-1115 1

**27375** Carded #A01-1115VP 30

## HI FLOW WATER REGULATOR

All brass interior and increased water flow make this the top of the line water regulator a real winner! Factory set to keep pressure between 50 and 55psi.

**28015** Hi Flow Water Regulator w/gripper, Carded (Not approved for sale in CA or VT) #A01-1113VP 12

## WATER REGULATOR &amp; GAUGE COMBO

High water pressure can damage RV water systems. Check it and regulate it with this Valterra Combo Kit. Carded.

**28016** Water Regulator & Gauge Combo (Not approved for sale in CA or VT) #A01-1118VP 6

Protects RV's plumbing system against high pressure

## HIGH FLOW STAINLESS STEEL WATER REGULATOR



- Lead free. • 15 to 20% greater flow.
- Preset at 50 psi. • Carded.

**28729** High Flow Stainless Steel Water Regulator #A01-1114VP 12



## LEISURE TIME CITY WATER ENTRY CAP

Attaches to your city water entry. Built in ventilation holes stop bacterial development and allow only air to enter city water hook up. White.

**27611** Water Entry Cap #15009 5



## VALTERRA WATER REGULATORS LEAD-FREE

Protects your RV plumbing against high pressure. 15 to 20% more flow than standard regulators. Regulates incoming water pressure to 50-55 psi. This lead-free brass conforms to CA & VT lead laws for drinking water fixtures.

**20057** Water regulator, Lead-free, Brass, Bulk #A01-1120VP 12

**20077** Water regulator, Lead-free high flow, Carded #A01-1122VP 12

## WATER REGULATOR &amp; GAUGE COMBO LEAD-FREE

Water regulator protects your RV plumbing system against high pressure. Gauge allows you to know the hook-up water pressure. Lead-free brass meets CA & VT laws on lead content for drinking water fixtures.



**20056** Water Regulator & Gauge Combo Lead-free, Carded #A01-1124VP 6



## VALTERRA FILL SPOUT AND WATER INLETS

Rigid, telescoping, heavy duty ABS construction for long lasting durability. O-ring seal for leakproof closure. 1 $\frac{3}{8}$ " or 1 $\frac{1}{4}$ " barb inlet.

Flush Mount Telescoping Water Fill:

**21516** Ivory, Bulk #R920 1

**27302** White, Bulk #R920TW 1

Top opening surface-mount fill spout with barbed connection. 1 $\frac{3}{8}$ " x 1 $\frac{1}{4}$ " Barb Inlet.

Water Fill:

**21515** Ivory, Bulk #RF911 1

**28075** Ivory, Carded #RF911VP 6

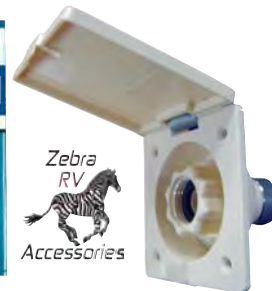

## ZEBRA RV ACCESSORIES CITY WATER ENTRY 1/2" F.P.T.

- City water connection port with locking hinged lid cover that protects and keeps the fill clean.
- Built-in check valve. • Female garden hose connection. • Durable ABS plastic.
- 3-1/2" x 3-1/2" O.D. • Packaged.

**20161** Polar White #RC146P 12



20187, Packaged

## ZEBRA RV ACCESSORIES FLUSH MOUNT GRAVITY FILLER SPOUT

- Durable ABS plastic water fill spout includes locking snap-lid cover which protects and keeps fill clean. • Flush mount tank water gravity feed has a built-in vent port. • For either 1-1/4" or 1-3/8" tubing. • Packaged.

3-1/2" x 3-1/2" O.D. Polar White:

**20187** 1-1/4" #RT144P 12

**20190** 1-3/8" #RT145P 12

## LASALLE BRISTOL GRAVITY FILLER

Recessed gravity water inlet with 1 $\frac{3}{8}$ " O.D. and  $\frac{3}{8}$ " I.D. barb connection and  $\frac{3}{8}$ " barb vent connection. White.



**21044** Gravity Fill #74BPC73C 1

In Section L: Fresh Water Line Filters Winterizing Pumps Faucet & Shower Sink & Drain Holding Tanks Drain Valves & Fittings Drain Hose Chemicals & Toilets

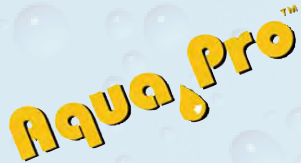

## AQUA PRO WATER FILLS & CHECK VALVES

### AQUA PRO CITY WATER FILLS

Recessed and surface mount models to fit all applications. Direct replacement for Marshall Brass and JR Products models. All Aqua Pro models are made of non-toxic materials, have "poppet" style check valves, 1/2" pipe thread and are certified to IAPMO and NSF standards.

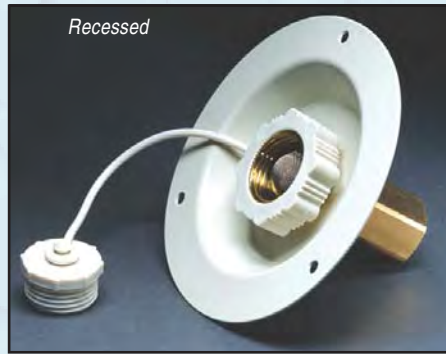

Recessed



Surface Mount

#### RECESSED MODELS

Recessed models are 4.5" outside dia. and require a 3.5" dia. cutout. Available in metal or plastic. Metal is powder coated for a long lasting finish. Plastic is UV stabilized for durability.

*Metal Recessed Mounting Flange w/1/2" FPT:*

**27870** <sup>LS</sup> Colonial White, Bulk #27870 1

**27882** Colonial White, CD/1 #27882 1

**27886** Polar White, CD/1 #27886 1

*Plastic Recessed Mounting Flange w/1/2" MPT:*

**27889** <sup>LS</sup> Colonial White, Bulk #27889 1

**27890** Colonial White, CD/1 #27890 1

**27888** Polar White, CD/1 #27888 1

#### MODELS WITHOUT MOUNTING FLANGE

*No Mounting Flange w/1/2" FPT:*

**27868** <sup>LS</sup> Bulk #27868 1

**27880** CD/1 #27880 1

#### SURFACE MOUNT MODELS

Surface mount models are available in metal, plastic and aluminum. Metal is powder coated for a long lasting finish. Plastic is UV stabilized for durability. Aluminum has a "brushed" finish. Surface mount models are 3" outside dia., and require a 1-1/4" dia. cutout.

*Aluminum Surface Mounting Flange w/1/2" FPT:*

**27869** Bulk #27869 1

**27884** CD/1 #27884 1

*Metal Surface Mounting Flange w/1/2" MPT:*

**27883** Polar White, Bulk #27883 1

**27881** Polar White, CD/1 #27881 1

*Plastic Surface Mounting Flange w/1/2" MPT:*

**27892** Colonial White, CD/1 #27892 1

**27895** Polar White, Bulk #27895 1

**27893** Polar White, CD/1 #27893 1

### AQUA PRO CHECK VALVES

Direct replacement for Marshall Brass and for Hydronamic Products. Aqua Pro models are made of non-toxic, food-grade materials, have 1/2" pipe thread, and are certified to IAPMO and NSF standards.

*Aqua Pro Check Valve:*

**27915** 1/2" MPT x 1/2" MPT, Bulk #P27915BU 1

**27916** 1/2" MPT x 1/2" MPT, CD/1 #P27916 1

**27871** 1/2" MPT x 1/2" FPT, Bulk #P27871BU(P23402) 1

**27879** 1/2" MPT x 1/2" FPT, CD/1 #P27879 1

### JR PRODUCTS CITY WATER FLANGE

Original equipment city water flange is built to last. Made of durable plastic with a brass check valve and mounts easily with three screws. Also includes a rubber dust cover to keep dirt and debris out of your fresh water. Cut out dim. 1-1/2"; Outside dim. 4-1/2".



*City Water Flange:*

**45136** Black #160-85-A-36-A 1

**41285** Colonial White #160-85-A-16-A 12

**41286** Polar White #160-85-A-26-A 20



### JR PRODUCTS LOCKABLE GRAVITY WATER HATCH

1/2" O.D. air vent. Will accept small padlock; has a snap lock. Low profile design is U.V. stabilized, fade resistant and impact resistant. Easy installation. Dimensions: cutout 3 1/2" dia., outside 4 1/2" dia.

*Lockable Gravity Water Hatch:*

**25420** Colonial White #370-A-1-A 1

**25421** Polar White #370-A-2-A 12



### ZEBRA RV ACCESSORIES 1 3/8" GRAVITY FILL SPOUT WITH FLANGE

- 4-1/4" x 4-1/4" Remodel plate covers old water fill cavity. • Fits 1-3/8" tubing.
- Built-in vent port. • Locking hinged cover protects and keeps fill clean. • Packaged.

**20179** Gravity Fill Spout, Polar White #RM433P 12





### SHURflo PRESSURE REGULATED CITY WATER ENTRY



20121



28474



28437

### WALL MOUNT PRESSURE REGULATOR

• Quick, permanent wall mount. • Continuous protection from high pressure surges. • Fits standard hose fittings. • Built in check valve.

This combination water regulator and check valve with exclusive Shurflo diaphragm design provides continuous protection from high pressure surges in the city water system. Pressure limited to 65 PSI. Leak tight construction. Quick, permanent wall mount installation on walls of any thickness.

Filler/Regulator, Wall Mount, with 65 PSI:

**28437** Chrome #183-029-14 24

**28474** Cream #183-029-11 24

**20121** White #183-029-18 24



### JR PRODUCTS CITY WATER DISH



41284

45232

This original manufacturer's city water fill will replace any dish type water fill with a 3-1/2" opening. Brass check valve has a 1/2" M.P.T. fitting. Dish is constructed of durable plastic for a long life. Comes with a replacement rubber dust cover to keep dirt and debris from your fresh water supply. Packaged. Cut out dim. 3-1/2"; Outside dim. 4-1/2".

City Water Dish, Packaged:

**45232** Black #321-B-36-A 1

**78832** Colonial White #321-B-16-A 2

**41284** Polar White #321-B-26-A 12



### VALTERRA GRAVITY WATER INLET

Easy to install 4-1/2" dia. gravity water fill.  
• UV stabilized plastic with 1/2" air vent for a fast fill. • Bayonet style cap for a quick reliable seal.  
• Includes installation screws and putty tape.  
Cutout: 3-1/2" dia.

Gravity Water Inlet, Carded:

**20630** White #A01-2003VP 6

**20629** Black #A01-2003BKVP 6



20638

### VALTERRA GRAVITY WATER INLET CAP



20637

Cap and strap for fresh water gravity fills. Bayonet tab style for quick reliable seal.

Gravity Water Inlet Cap, Carded:

**20637** Black #A0120SBKVP 10

**20638** White #A0120SVP 24

**20639** Colonial White #A0121SVP 24

### JR PRODUCTS CITY WATER DISH



41283

27472

With plastic check valve. 4.5" outside dia., 3.5" cut-out dia.

**27472** City Water Dish #321-B-2P-A 12

With 1/2" O.D. air vent. 4.5" outside dia., 3.5" dia. cut-out.

Gravity Water Dish:

**41283** Colonial White #321-A-13-A 12

**78833** Polar White #321-A-23-A 2



### VALTERRA LEAD-FREE PLASTIC FLANGE WATER INLET, MPT

Includes a brass check valve, garden hose swivel fitting with gripper and press-in dust plug. • 1/2" MPT inside connection. • 2-3/4" flange, MPT. • Includes installation screws, putty tape, and PTFE tape

Water Inlet, Lead-Free, Carded:

**20624** Black #A01-0169LFVP 10

**20685** White #A01-0170LFVP 10



20687



20686

### VALTERRA FLUSH MOUNT WATER INLET, FPT

Easy press-in dust plug. • Installation tape and hardware. • Brass check valve. • Screened washer. • Swivel connection with gripper.

Water Inlet, Metal Flange, Lead-Free, Carded:

**20686** White #A01-0171LFVP 10

**20687** Aluminum Finish #A01-0172LFVP 10



20688

### VALTERRA RECESSED WATER INLET, FPT

Easy press-in dust plug. • Installation tape and hardware. • Brass check valve. • Screened washer. • Swivel connection with gripper.

Water Inlet, Metal Flange, Lead-Free, Carded:

**20688** White #A01-0176LFVP 14

**20689** Colonial White #A01-0177LFVP 14

In Section L:	Fresh Water Line	Filters	Winterizing	Pumps	Faucet & Shower	Sink & Drain	Holding Tanks	Drain Valves & Fittings	Drain Hose	Chemicals & Toilets
---------------	------------------	---------	-------------	-------	-----------------	--------------	---------------	-------------------------	------------	---------------------

### JR PRODUCTS CITY WATER FLANGE

#### WITH PLASTIC CHECK VALVE & STEEL FLANGE

Comes with a die cast steel flange for secure mounting. Combined with a chrome plated finish and stainless steel mounting screws for a great look and durability. Replaces most steel flanged units. The 1/2" male steel thread is a standard in the RV industry.



**27822** City Water Flange w/ Check Valve, Packaged #9690-200-023 18

#### WITHOUT PLASTIC CHECK VALVE

Water flange assembly. RV end is a 1/2" - NPT tapered male thread. The water input is a standard 3/4" - 11-1/2 NH garden hose thread. The body is ABS plastic with a zinc flange and rubber washer. With attached plastic dust cover.

**22222** City Water Flange w/o Check Valve #9691-300-023 18



### VALTERRA LEAD FREE WATER INLET WITH DIE CAST FLANGE, MPT

Includes a check valve, garden hose swivel fitting with gripper and press-in dust plug.  
• 1/2" MPT inside connection. 2-3/4" die cast flange, MPT. • Includes installation screws, putty tape, and PTFE tape.

**20622** Water Inlet, Die Cast Flange, Black, Carded #A01-0165VP 10

### CP PRODUCTS TANK PROBE

Use this sensor with your tank monitor panel. The probe works with fresh or waste water tanks, and is easy to install—just drill a hole in the tank, insert the probe and screw closed for a water tight seal.



**21886** Tank Probe Well Nut #MP5 120



27473;  
Plastic

20082;  
Brass

### JR PRODUCTS LOCKING CITY WATER HATCH



- Direct OEM replacement. • UV & impact resistant. • Resistant to road salts & acids.
- Paintable. • Outside dimensions: 6" W x 6.5" H; Cut-out: 4-1/4" W x 4-3/4" H. • Collar Depth: 1-1/2". • Packaged.

Locking City Water Hatch, Polar White:

**27473** Plastic Check Valve (Replaceable plastic check valve with 1/2" MPT Mfr#2P-A; CA/VT approved) #BGE12-P-A 12

**20082** **NEW!** Brass Check Valve, 1/2" MPT #BGE12-6-A 24



27469; Plastic

20245; Brass

### JR PRODUCTS CITY/GRAVITY WATER DISH WITHOUT DOOR

Easy installation. 1/2" O.D. air vent. Outside dim.: 7-9/16" W x 5-5/16" H; cut-out 6" W x 3-3/4" H.

Water Hatch, Polar White, Packaged:

**27469** With replaceable plastic city water fill check valve #497-AB-2P-A 12

**20245** With brass city water fill check valve #497-AD-26-A 24



### JR PRODUCTS UNIV. ONE-PIECE GRAVITY WATER FILL CAP

One-piece universal cap and strap is designed to fit most gravity water fills, threaded or bayonet style with an inside diameter of 1-1/4". Polar white flexible rubber strap resists fading and breakage. Easy to install: slips over the neck of your water fill. No more hard brittle plastic straps or caps to lose or crack.

**28305** Gravity Fill Cap #615-PW-A 1



### VALTERRA GRAVITY/CITY WATERHATCH

- 1/2" MPT tank connection in a lockable hatch.
- Paintable UV stabilized plastic with 1/2" air vent for a fast fill. Includes installation screws, putty tape and PTFE tape. • Cut out: 5-7/8" W x 4-3/4" H; OD: 7-5/8" W x 6-1/2" H. **20625** is a gravity fill and lead-free brass city water fill. **20631** is a gravity and plastic city water fill.

Gravity/City Water Hatch, White, Carded:

**20625** Brass #A01-2000VP 6

**20631** Plastic #A01-2004VP 10



### REPLACEMENT KEYS FOR B&B OR JR PRODUCTS LOCKING HATCH



Replacement Keys, Pk/2:

**44846** Square Head #DECO-A 12

**48779** **NEW!** Round Head #J236-A 1

**49399** Round Head #751-A 12





**VALTERRA**

**NEW!**



### VALTERRA GRAVITY/CITY RECTANGULAR FLANGE

- Easy to replace city and gravity water fills on a rectangular mount.
- UV stabilized plastic with 1/2" air vent for a fast fill.
- City fill has 1/2" MPT tank connection.
- Includes installation screws, putty tape and PTFE tape.
- OD: 7-1/2" W x 5-1/4" H.

**20627** Gravity/City Rectangular Flange, White, Carded #A01-2001VP 6



### JR PRODUCTS GRAVITY WATER HATCH

Protects water system against vandalism, dust and grime. Key-locking door with RVIA-approved warning tag. IAPMO and CSA approved. Fits 1 1/4" and 1 3/8" hose. Hatch dimensions: 5" W x 6 1/4" H. Cut-out dimensions: 3 1/8" W x 4 3/8" H. Packaged.



27810

21678,  
25674

Gravity Water Hatch:

**27305** Polar White #A6112-A 1

Replacement Cap & Fill Spout:

**21678** Colonial White #222/224CW-A 1

**25674** Polar White #222/224PW-A 1

Replacement Cap & Strap only:

**27788** Colonial White #222CW-A 1

**27789** Polar White #222PW-A 1

Replacement Strap only:

**27810** For 222/224PW #STRAP 1



27470



25413



21678,  
25674



### JR PRODUCTS LOCKING WATER CENTER

Will accommodate gravity or city water hookups. City fill has a 1-piece check valve 1/2" MPT. Easy installation, low profile and will fit in any wall. 6.5" x 7-5/8" outside dimensions; 4 3/4" H x 5 7/8" W cut-out dimensions; Collar Depth: 1-1/2" and Total Depth: 3-1/4" .

Locking Water Center:

**25413** **NEW!** Brass Check Valve, 1/2" MPT Polar White #K7112-6-A 24

**27470** Plastic Check Valve, 1/2" MPT Polar White #K7112-P-A 1

Replacement Cap & Fill Spout:

**21678** Colonial White #222/224CW-A 1

**25674** Polar White #222/224PW-A 1

Replacement Cap & Strap only:

**27788** Colonial White #222CW-A 1

**27789** Polar White #222PW-A 1



### JR PRODUCTS GRAVITY WATER HATCH

Low profile. UV stabilized; fade and impact resistant. Paintable. Dimensional stability. Key lock. Easy installation. 1/2" O.D. air vent. Resistant to road salts and acids. Outside dimensions 6" W x 6.5" H, with a 4.25" W x 4.75" H cut-out size.

Gravity Water Hatch:

**27359** Polar White #JFE12-A 12

Replacement Cap & Fill Spout:

**21678** Colonial White #222/224CW-A 1

**25674** Polar White #222/224PW-A 1

Replacement Cap & Strap only:

**27788** Colonial White #222CW-A 1

**27789** Polar White #222PW-A 1



**VALTERRA**

### VALTERRA GRAVITY HATCH



- Gravity water inlet with locking hatch.
- UV stabilized plastic with 1/2" air vent for a fast fill.
- Bayonet style cap for a quick reliable seal.
- Includes installation screws, putty tape and PTFE tape.
- Universal size fits both 4-1/4" W x 4-3/4" H and 4" W x 3" H cutouts.
- OD: 6" W x 6-1/2" H

**20628** Gravity Hatch, White, Carded #A01-2002VP 6

**VALTERRA**

### VALTERRA CAM LOCK WITH KEY

Replacement lock with key for hatch doors.

**48897** Cam Lock with Key #A510 1

**VALTERRA**

### VALTERRA WATER INLET WITH PLASTIC FLANGE, MPT

Includes a check valve, garden hose swivel fitting with gripper and press-in dust plug.

- 1/2" MPT inside connection.
- Includes installation screws, putty tape, and PTFE tape.

**20623** Water Inlet, 2-3/4" Flange, MPT, White, Carded #A01-0168VP 24

# WATER FILLS & ACCESSORIES

## PLUMBING

In Section L:	Fresh Water Line	Filters	Winterizing	Pumps	Faucet & Shower	Sink & Drain	Holding Tanks	Drain Valves & Fittings	Drain Hose	Chemicals & Toilets
---------------	------------------	---------	-------------	-------	-----------------	--------------	---------------	-------------------------	------------	---------------------



- Original replacement. • 751 keyed. • Packaged.
- 43026** 5/8" Cam #00E00 1
- 43018** 1-1/8" Cam #00100 1

See the table on page 247 for more information on the Hatch Key Locks from JR Products



### RV DESIGNER HATCH LOCK

Used on water, electric, gas hatches etc. "Cam" size is the length of the blade.

Clamshell packaging; 3" W x 5" H x 1" D, C:

- 44842** 1-1/8" Hatch Lock with 1-1/8" cam, 5/8" barrel #L100 1
- 44843** Hatch Lock with 5/8" cam, 5/8" barrel #L110 1
- 44844** Replacement Key, Code 751, Pk/2 #L200 1



### JR PRODUCTS CITY WATER FLANGE

With plastic check valve. 3" outside dia.; 1.5" cut-out dia.

- 27471** City Water Flange, Polar White #160-85-A-2P-A 12

### PLASTIC CHECK VALVE

Replacement check valve for all new hatches. This check valve is easily replaced by removing a clip located on the back of the hatch or dish. Superior design with a spring and ball system for longer life and is complete with a new hose connector with four raised thumb grips for easier connections. Fitting is 1/2" MPT.

- 28545** Plastic Check Valve, Polar White #2P-A 1

### FLEX-LINE

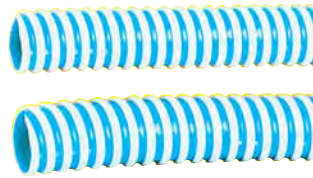

IAPMO approved. Easy to bend and cut.

25 ft. L Flex-Line:

- 27608** 1 1/4" I.D. #F-1125 4
- 27607** 1 3/8" I.D. #F-1135 4

### POLYETHYLENE SPIN-WELD FITTINGS

Water tank fitting, female pipe thread.



- 24743** 1/2" Fitting #53 1
- 24744** 1-1/4" Fitting #OS-19 1
- 24745** 1-1/2" Fitting #S-4-B 1
- 24747** 3" Fitting #S-6AB 1

### LASALLE BRISTOL WATER TANK FITTING

1-1/4" barb x 1-1/4" MPT.

- 24760** Elbow Adapter #74BPC80 1

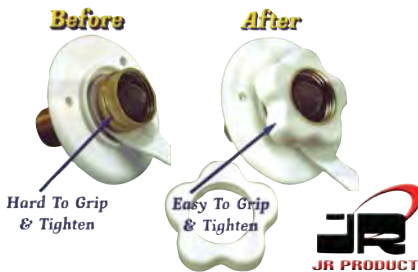

### JR PRODUCTS CONNECT-IT-TIGHT

The Connect-It-Tight makes tightening your city water line quick and easy. Finally an end to leaking water connections. With its large grip points and a hardened rubber compound, Connect-It-Tight will help you get a tight connection to your water hose. You can also use it on any standard female collar water hose connection.

- 28458** Polar White, Pk/1 #616-05-E-PW-A 1



### POLYETHYLENE FLEX TANK FITTINGS

To connect fittings, just drill a hole in the tank, insert the fitting (compression end, while loosely threaded) into the hole. Twist the outside end. The compression piece inside expands during twisting, sealing the fitting tight.

- 21033** 1/2" FPT Flex Fitting (Drill 1-1/8" Hole) #PS2 1
- 21034** 1-1/4" Barb Fitting (Drill 2" Hole) #PS10 1



### VALTERRA BARB FITTINGS

These fittings can be used with the 21033 fitting.

- 21070** Barb Fitting, 1/2" MPT x 1/2" Barb Elbow #RF846 25
- 21078** Union Fitting, 1/2" MPT x 1/2" Barb Straight #RF841 25



### VALTERRA POLYETHYLENE UNIVERSAL DRAIN VALVE

**20635** has 3/8" and 1/2" barbs; for 1/2" connections, cut off smaller end. Flanged for easy mounting. • **20636** has 3/8" and 1/2" MPT. Use PTFE tape on threads. These valves are polyethylene material, but can also be used with ABS.

Universal Drain Valve, Carded:

- 20635** Barbed #A01-2025VP 24
- 20636** Threaded #A01-2026VP 24

In Section L: Fresh Water Line Filters Winterizing Pumps Faucet & Shower Sink & Drain Holding Tanks Drain Valves & Fittings Drain Hose Chemicals & Toilets

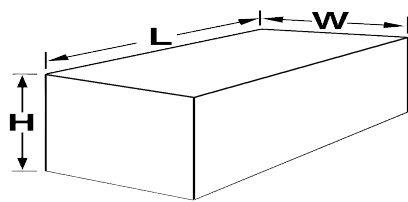

### POLYETHYLENE WATER TANKS WITHOUT FITTINGS (Regular Shape)

Use polyethylene flex tank fittings (not included)

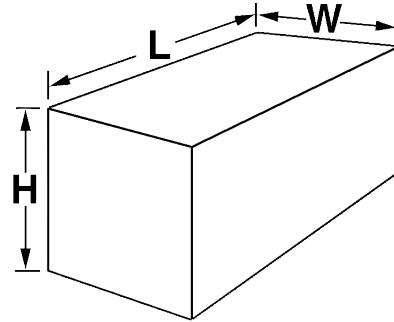

### IRREGULAR SHAPE POLYETHYLENE WATER TANKS (Fittings Not Included)

Use polyethylene flex tank fittings (not included).

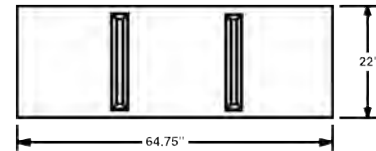

### 51 GALLON POLY TANK, NO FITTINGS

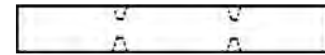
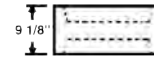

22443 51 Gal. Tank #W0030 1

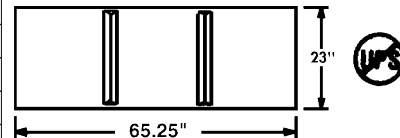

### 73 GALLON POLY TANK, NO FITTINGS



22470 73 Gal. Tank #W0531 1

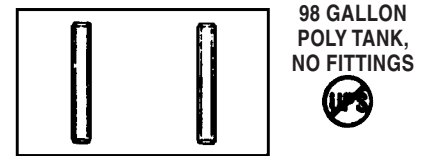

### 98 GALLON POLY TANK, NO FITTINGS

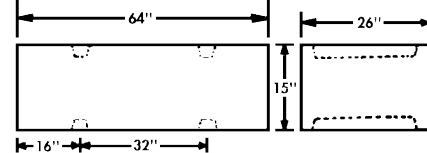

23729 98 Gal. Tank #W1078 1



### PETERSEN PLASTIC DRAIN COCKS

Durable plastic with UV stabilizer. Replaces most standard fresh water drain cocks. Available with Barb and MPT fittings in 3/8" and 1/2". Bulk.

Models with Flange, Artic White:

25745 3/8" MPT #18-957AW 5

25746 1/2" Barb #18-958AW 25

25747 3/8" Barb #18-959AW 25

Models with Flange, Colonial White:

21129 3/8" Barb #18-959CW 25

21130 1/2" Barb #18-958CW 25

21131 3/8" MPT #18-957CW 5

Models without Flange, Artic White:

25748 3/8" MPT #18-964AW 5

25749 1/2" MPT #18-966AW 5

Models without Flange, Colonial White:

21132 3/8" MPT #18-964CW 5

21133 1/2" MPT #18-966CW 5

**BRI-RUS**  
SPECIALTY RECREATION

### BRI-RUS SELF-SEALING WATER TANK FITTING

- 1/2 inch barb. • Self-sealing fitting.
- Fits in a 7/8 inch hole. • Made in the USA.

Directions for Installation: • Drill a 7/8" hole at desired location. • Back the nut off to the end of threads. • Insert fitting into hole at a 45° angle, snap into place. • Pull down on fitting and slowly turn clockwise until snug and O ring is seated.

68655 Water Tank Fitting #TF-1 1

### JR PRODUCTS DUAL BARBED DRAIN COCK



Durable plastic valve is designed for multiple uses and built to last. The dual size barbed fittings make choosing the right size a snap and the 2" mounting flange helps provide a good seal. The valve will replace most OEM fresh water tank drain valves as well as those mounted on the exterior walls of the RV or boat.

28544 3/8" - 1/2" Dual Barbed Drain Cock, Packaged #03182 1

**LIFESAFE**

### LIFESAFE SUPER SEAL TAPE

Emergency repairs, stops leaks, forms solid rubber wrap. Strips clean, leaves no messy adhesive or residue. Holds 100psi at 220°F. Works wet or dry, greasy or dirty. Shrinks about 3% to form an airtight, waterproof seal. Use for outdoor plumbing, automotive hoses, broken water lines, electrical cables, garden hose repair, boat and RV repair, wire bundles, extension cord connectors, sports equipment, tool grips, power tools and rope ends.



47900 Super Seal Tape, 1" x 16 ft. #RE3845ES 12



Full one-year warranty.



### “ROCKET” EXTRUDED ABS WATER TANKS

The only solvent-weldable water tank; add fittings anywhere. Lightweight, completely algae-free black ABS plastic. Tasteless, odorless and non-toxic. Will never rust or corrode. Made of high-grade plastic polymers. One-piece extruded construction eliminates the possibility of leakage. Baffled every 18 inches for surge control. Easily installed, universal design. Supplied with 3/8" threaded, fitting inserts; three on each end. Choice of fill fittings: elbow, straight or threaded with cap. For non pressure applications.

Rocket Water Tank, 8" x 16" x (L):

- 21550** 12"L 6 Gallon #R8012 1
- 20334** 18"L 9 Gallon #R8018 1
- 20331** 24"L 12 Gallon #R8024 1
- 20332** 30"L 15 Gallon #R8030 1
- 21330** 60"L 30 Gallon #R8060 1

### ROCKET ABS TANK FILL KITS

Each kit includes: 1 1/4" fill fitting; • 1/4" pint solvent cement; • two 3/8" drain/vent adapters; • two 3/8" 90° barbed ells; and 3/8" plug.

- 20264** <sup>LS</sup> Straight Fill Kit, 1 1/4" Barb #RK908 1



### ABSTANK FILL FITTINGS & ADAPTERS

- 21066** 90° Male Adapter, 3/8" MPT x 3/8" Barb #RF835 25
- 20268** 1 1/4" Barbed Elbow #RF907 5
- 20270** 1 1/4" Barbed Straight Adapter #RF908 1
- 20272** 3/8" FPT Drain Nut #RF922 1



- 1 1/2" FLUSH SLIP FITTING**
- 21731** 1-1/2" Slip Fitting #146 100

## SEA TECH QUICK CONNECT FITTINGS

Sea Tech, Inc. was established in 1995 and provides reliable, high-quality, cost-effective solutions for water connection needs. Sea Tech's Quick Connect Water System offers a wide range of standard 1/2" Nominal (5/8" O.D.) fittings and tubing, plus 3/8" Nominal (1/2" O.D.) and 3/4" Nominal (7/8" O.D.) adapters. Fittings have 2 patent pendings on the collet and O-ring guide designs.



### TECHNICAL INFORMATION

#### MATERIAL SPECIFICATION

Material	Fittings Color	O-ring
Thermal Plastic	5/8" O.D. White	EPDM

#### MAX. PRESSURE AND TEMPERATURE

SIZE	5/8" O.D.	TEMP
WORKING PRESSURE	100 psi	180°F
	6.8 bar	82°C

#### TORQUE VALUES

THREADS	3/8", 1/2"	3/4"
TORQUE	Min. 17.7 in-lbs Max. 26.5 in-lbs	Min. 22 in-lbs Max. 31 in-lbs

#### TUBING TOLERANCES

SIZE	TOLERANCE
5/8" O.D.	+0.004" ~ - 0.004" + .010mm ~ - .010mm

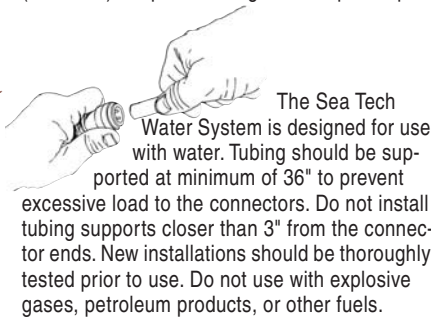

### CONNECT TO MULTIPLE MATERIALS!

The Sea Tech System incorporates Stainless Steel Gripping Teeth in its Collet. These corrosion-resistant teeth allow the connectors to interconnect with multiple materials without the need for special tools. • Copper. • CPVC. • PEX, LDPE, MDPE, & HDPE tubings.

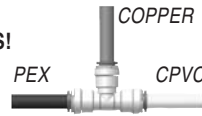

### THE O-RING GUIDE IS THE KEY!

Sea Tech connectors incorporate an exclusive O-ring Guide for improved reliability. This unique feature insures zero-leak connects by: • Protecting the O-ring from damage during assembly. • Increasing the connector's side load capacity. • Correctly aligning the tubing with the O-ring every time.

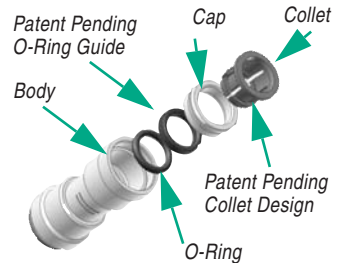

### MAKING A CONNECTION

Cut the tubing to length using the Sea Tech tubing cutter or similar. Slight pressure as if to twist the cutter around the tubing will aid cutting.

**1** Cut the tubing square using a proper tube cutter. It is essential that the outside diameter of the tubing be free of scratches and damage. The outer surface of the tube needs to be smooth and clean.

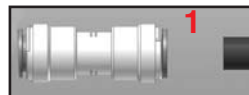

**2** Mark the insertion depth on the tubing end. Sea Tech connectors have an insertion depth line molded onto the outside of the connector bodies.

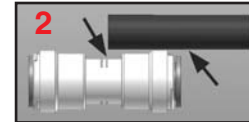

**3** Push the tubing into the connector until the insertion mark on the tubing meets the edge of the connector collet.

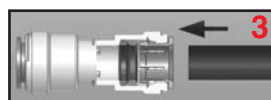

**4** Make certain to push the tubing completely into the connector until it comes into contact with the internal tubing stop.

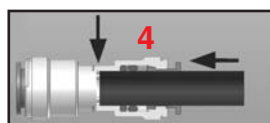

**5** To disconnect ensure the system is depressurized before removing connectors. Push the collet in squarely against the face of the fitting. With the collet held in this position, tubing can be removed. The connectors can then be re-used.

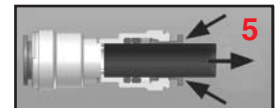

### ROTATES UNDER PRESSURE!

After a joint is made the tubing can still swivel while connected, even under maximum pressure. The connector's ability to rotate under pressure makes it the ideal connector for vibrating and dynamic applications.

### HIGHEST FLOW!

Because Sea Tech connectors join the tubing on the outside, there is no barb fitting on the inside, so flow capacity is increased by more than 30%. Only Sea Tech connectors offer complete flow, allowing for a more efficient water system.



Sea Tech fittings are certified and tested to: • NSF-14; • NSF-641; • CSA B137.5; • ASTM F877. **RVIA Approved.**



## RECTORSEAL CEMENT

### ABS CEMENT:

For connecting ABS plastic pipe and fittings. Bonds ABS pipe and/or fittings only. Approved for potable water. Dauber-top cans. Black. **ALL PURPOSE CEMENT:** For cementing PVC and/or CPVC to ABS. Dauber-top 4-oz. can. **PVC CEMENT:** For PVC Types I and II potable water, DWV and SW pipe, fittings up to Schedule 40 and up to 6" diameter. Dauber-top can.



- 20277** ABS Cement, 4-oz. #55938 24  
**20269** ABS Cement, 8-oz. #55940 24  
**20802** ABS Cement, Pint #55942 12  
**23363** ABS Cement, Quart #55944 1  
**21353** All Purpose Cement, 4-oz. #55969 24  
**23351** PVC Cement, 4-oz. #55901 24

## SEA TECH QUICK CONNECT FITTINGS & ACCESSORIES



CTS = Copper Tube Size

### PEX TUBING

PEX Tubing is NSF listed and FDA recognized.



PEX Tubing, 100' Roll:

- 25927** 3/8" I.D., White #0650392 1  
**25928** 1/2" I.D., White #0650394 1  
**NEW!** PEX Tubing, 50' Roll, Boxed:  
**20564** 1/2" I.D., Blue #00C5850 1  
**20565** 1/2" I.D., Red #00R5850 1  
**20563** 1/2" I.D., White #00W5850 1

PEX Tubing, 20' Roll:

- 25931** 3/8" I.D., White #16158 (EA) 10  
**25932** 1/2" I.D., White #W5820 1

### SEA TECH ACCESSORIES

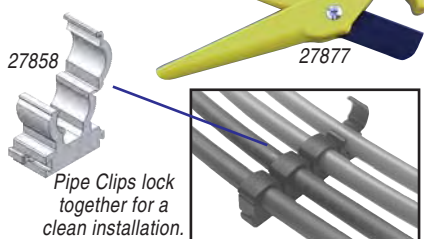

Pipe Clips lock together for a clean installation.

- 27858** Pipe Clip 1/2" I.D. (5/8" O.D.) #012370-1557 100  
**28261** <sup>LS</sup> Pipe Clip 3/4" I.D. (7/8" O.D.) #012370-2257 50  
**27877** Tubing Cutter #1158-1522 20

## SEA TECH QUICK CONNECT FITTINGS

Please note during 2011 some SeaTech items will change their packaging.

Sea Tech connectors utilize a swivel nut with NPS straight threads and a cone seal. This allows the installer to thread onto NPT, NPS, BSP, and most 1/2" male threads without tools or thread sealant. Simply thread on, hand tight, for a zero-leak seal.



3/8" size fittings can be developed by simply snapping a Reducing Stem into any 1/2" fitting.

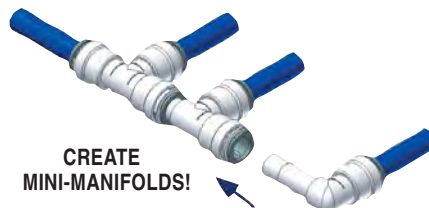

### CREATE MINI-MANIFOLDS!

With the Sea Tech Water System small lengths of tubing can be eliminated by using stackable connector configurations. Simply snap together Tees and/or Elbows to create a mini-manifold of fittings. Because all connectors rotate, the direction of the tubing can be orientated by a simple twist, reducing the amount of tubing required to plumb a water system.

### STACKABLE ELBOW



- 28233** 3/8" CTS, Bulk #013518-08 80  
**27851** 1/2" CTS, Bulk #013518-10 80

### DROP EAR ELBOW

- 28235** 1/2" CTS x 1/2" NPT, Bulk #013521-1008 40



### MALE ELBOW

- 27846** 1/2" CTS (B-Tube Size) x 1/2" NPT (A-Thread), Bulk #013519-1008 20



CTS = Copper Tube Size



### FEMALE SWIVEL ELBOW

- 28242** 3/8" CTS (B-Tube Size) x 1/2" NPS (A-Thread), Bulk #013520-0808 80  
**27845** 1/2" CTS (B-Tube Size) x 1/2" NPS (A-Thread), Bulk #013520-1008 50



### UNION ELBOW

- 28231** 3/8" CTS, Bulk #013517-08 80  
**27843** 1/2" CTS, Bulk #013517-10 60  
**28232** 3/4" CTS, Bulk #013517-14 25



### MALE CONNECTOR

- 28247** 3/8" CTS (B-Tube Size) x 1/2" NPT (A-Thread), Bulk #013501-0808 80  
**27848** 1/2" CTS (B-Tube Size) x 1/2" NPT (A-Thread), Bulk #013501-1008 80  
**28248** 1/2" CTS (B-Tube Size) x 3/4" NPT (A-Thread), Bulk #013501-1012 50  
**28249** 1/2" CTS (B-Tube Size) x 3/4" MGHT (A-Thread), Bulk #013501-1014 50



### END STOP

- 28255** 3/8" CTS, Bulk #013545-08 100  
**27850** 1/2" CTS, Bulk #013545-10 80



### STACKABLE HOSE BARB UNION

- 28253** 1/2" CTS x 1/2" Hose Barb, Bulk #013511-1008 200



### UNION CONNECTOR

Union Connector, CTS Tube Size:

- 28236** 3/8", Bulk #013515-08 80  
**27844** 1/2", Bulk #013515-10 20  
**28237** 3/4", Bulk #013515-14 40



In Section L:	Fresh Water Line	Filters	Winterizing	Pumps	Faucet & Shower	Sink & Drain	Holding Tanks	Drain Valves & Fittings	Drain Hose	Chemicals & Toilets
---------------	------------------	---------	-------------	-------	-----------------	--------------	---------------	-------------------------	------------	---------------------

### SEA TECH QUICK CONNECT FITTINGS

Please note during 2011 some SeaTech items will change their packaging.

CTS = Copper Tube Size



#### REDUCING UNION



**27872** 1/2" CTS Tube Size x 1/4" O.D. Tube Size, Bulk #013516-1004 70

**27873** 1/2" CTS Tube Size x 3/8" CTS Tube Size, Bulk #013516-1008 70

#### UNION CHECK VALVE

**28258** 1/2" CTS, Bulk #013540-10 50



#### HOSE BARB FITTING

Hose Barb Fitting, 1/2" Barb x 1/2" CTS Tube:

**28004** Bulk #013513-1008 80



#### UNION PUMP FITTING

**28251** 1/2" CTS, Bulk #013575-10 75



#### STACKABLE HOSE BARB ELBOW

**28254** 1/2" CTS x 1/2" Hose Barb, Bulk #013512-1008 200



#### ELBOW PUMP FITTING

**28252** 1/2" CTS, Bulk #013576-10 50



#### STACKABLE TEE

Stackable Tee, CTS Tube Size:

**27842** 1/2", Bulk #013533-10 50

**28028** 1/2", CD/1 #003533-10AQUA 16



#### FEMALE SWIVEL CONNECTOR



**28239** 3/8" CTS (B-Tube Size) x 1/2" NPS (A-Thread), Bulk #013510-0808 70

**27847** 1/2" CTS (B-Tube Size) x 1/2" NPS (A-Thread), Bulk #013510-1008 70

**27852** 1/2" CTS (B-Tube Size) x 3/4" NPS (A-Thread), Bulk #013510-1012 50

#### REDUCING STEM CONNECTOR

POLYSULFONE (SHOWN)

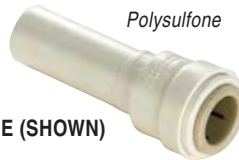

35 Series products are manufactured in Polysulfone and certified to NSF-61, NSF-14, CSA B137.5, ASTM F877, IGC 188-04c and recognized by the Uniform Plumbing Code.

Rated 180°F @ 100psi / 75°F @ 250psi

**28245** 1/2" CTS Stem Size x 3/8" CTS Tube Size, Bulk #013514-1008 60

**28039** 1/2" CTS Stem Size x 3/8" CTS Tube Size, CD/1 #003514-1008AQUA 24

#### ACETAL (NOT PICTURED)

24 Series fittings are manufactured from acetal for general plumbing use. These fittings interconnect with Sea Tech's 35 Series connections.

Rated 140°F @ 100psi / 75°F @ 250psi

**27874** 1/2" CTS Stem Size x 3/8" CTS Tube Size, Bulk #012414-1008 100

**27875** 1/2" CTS Stem Size x 1/4" CTS Tube Size, Bulk #012414-1004 100

**28040** 1/2" CTS Stem Size x 1/4" CTS Tube Size, CD/1 #002414-1004AQUA 24

#### REDUCING TEE

**28229** 1/2" CTS x 1/4" O.D., Bulk #013524-1004 50



#### MALE THREAD TEE

**28228** 1/2" CTS x 1/2" NPT, Bulk #013530-1008 50



#### UNION TEE

Union Tee, CTS Tube Size:

**28224** 3/8", Bulk #013523-08 50

**27841** 1/2", Bulk #013523-10 50



#### 3-WAY BY-PASS VALVE

3-Way By-Pass Valve, 1/2" CTS Tube Size:

**28257** Bulk #013541-10 20



#### 3-WAY SELECTOR VALVE

3-Way Selector Valve, 1/2" CTS Tube Size:

**27907** Bulk #013538-10 20



#### STOP VALVE

1/2" CTS Tube Size.

**27849** Bulk #013539-10 35



#### STACKABLE 2-WAY VALVE

**20414** Stackable 2-Way Valve, 1/2" CTS Tube Size, Bag/1 #013543-10 1



#### COLLET CLIP

**28262** Collet Clip 3/8" Bulk #013547-08 500

**28263** Collet Clip 1/2" Bulk #013547-10 500

**28264** Collet Clip 3/4" Bulk #013547-14 500



#### ELBOW CLIP

1/2" CTS Tube Size.

**27853** Bulk #2349-15 40

