

ROADMASTER TOW BARS

**TOWING
& SAFETY**

N

| | | | | | | | | | |
|---------------|---------|-------------------|------------|--------|------------------|----------------|-------------------|---------------|------------|
| In Section N: | Hitches | Hitch Accessories | Car Towing | Levels | Mirrors & Safety | Brake Controls | Towing Electrical | Brake & Wheel | Automotive |
|---------------|---------|-------------------|------------|--------|------------------|----------------|-------------------|---------------|------------|

ALL TERRAIN™ NON-BINDING TOW BARS



Towing and Suspension Solutions

Releasing your towed vehicle is easy with ROADMASTER's All Terrain tow bars...even when the tow bar is at a hard angle or the towed vehicle is out of level. Four familiar, classic ROADMASTER tow bars — StowMaster, Falcon, BlackHawk 2 and Sterling — are available in the All Terrain Series. Each is upgraded with ROADMASTER's exclusive Freedom Latch, which releases the tow bar at any angle, level or bind — first time, every time.



Includes cables and wiring
6,000 pound rated EZ Hook safety cables and electrical wiring are included.

wt. 35 lbs.



STERLING ALL TERRAIN TOW BAR

6,000 lb. wt. capacity motorhome-mounted tow bar.

30139 ^{LS} Sterling All Terrain tow bar with four-wire electrical cord, one 4-wire plug (attached) and one 7-wire plug #575 1

30143 Sterling All Terrain tow bar with six-wire electrical cord, one 6-wire plug (attached) and one 7-wire plug #576 1



wt. 38 lbs.



U.S. patent number 6,957,824

Freedom Latch™

Patented cam design inside the Freedom Latch transforms linear motion into rotary motion at a 400-to-one ratio — five pounds of force against the latch equals 2,000 pounds of force against the lock.

FALCON ALL TERRAIN TOW BAR

39574 Falcon All Terrain tow bar
6,000 lb. wt. capacity motorhome-mounted tow bar #522 15



wt. 42lbs.

10,000 lb. rated!



Quick-Disconnects

Allows "one-person" fast and easy mounting or removal of your Sterling, Falcon, or BlackHawk 2 All Terrain tow bar.

BLACKHAWK 2 ALL TERRAIN TOW BAR

30156 BlackHawk 2 All Terrain tow bar
10,000 lb. wt. capacity motorhome-mounted tow bar #422 1



wt. 52lbs.



Patented Storage Latch

The patented storage latch makes storing the All Terrain tow bar a snap! Simply fold the tow bar toward the motorhome and it will "click," automatically locking in place.

U.S. patent number 6,619,686



Built-in Cable Guide

The built-in cable guide enhances appearance and helps keep safety cables and wiring from being crushed or damaged.

U.S. patent number . 6,168,182



Made in the USA

STOWMASTER ALL TERRAIN TOW BAR

39577 StowMaster All Terrain tow bar
6,000 lb. wt. capacity car-mounted tow bar #502 1



Towing and Suspension Solutions

6,000 pound weight capacity motorhome-mounted tow bar

- The use of stainless steel in virtually every moving component allows for smooth, trouble-free operation and prevents corrosion that binds.
- Autowlok locking mechanism — allows both tow bar arms to extend or retract for a quick connection. Then, as you drive away, the arms self-center and automatically lock.
- A patented latching mechanism ensures secure, easy storage on the back of your motorhome.
- One-person quick connect and disconnect — thanks to ROADMASTER's self-supporting "quick-disconnects," one person can easily connect or disconnect the Falcon 2 in seconds.
- Full-length, steel crossbar reinforced for maximum support and safety
- A lustrous, high-tech powder coat finish for maximum durability



- 34829** Falcon 2 tow bar (Weight 37 pounds) #520 20
38450 Falcon 2 tow bar (Fits Blue Ox baseplates) #525 1
39378 Falcon 2 tow bar cover #055 15
39379 Falcon 2 Combo Kit (coiled wiring) #9240 1
39380 Falcon 2 Combo Kit (straight wiring) #9241 1

STOWMASTER™

America's Best-Selling Car-Mounted Tow Bar

6,000-pound weight capacity car-mounted tow bar

- Stainless steel in virtually every moving component for smooth, trouble-free operation.
- Autowlok locking mechanism — allows both tow bar arms to extend or retract for a quick connection. Then, as you drive away, the arms self-center and automatically lock.
- Full-length safety crossbar — a full-length angle iron brace is integrated into the rear of the bar for maximum support.
- Self-lubricating nylon bushings eliminate friction between the inner and outer arms. Other tow bars use steel on steel.
- Plug-welded arms — steel plugs seal both ends of the tow bar, preventing corrosion from moisture and debris.
- A lustrous, high-tech powder coat finish for maximum durability.



- 38169** StowMaster Tow Bar #501 20
39553 StowMaster Combo Kit #9254 1
38170 StowMaster Tow Bar Cover #052 10

TRACKER™

The safest, strongest, easiest, most durable, trouble-free, 5,000 lb. rated, 'A' frame tow bar manufactured...BAR NONE!



- ROADMASTER's entry-level tow bar.
- Full-length safety crossbar for maximum strength.
- 5,000 pound towing capacity.
- A lustrous, high-tech powder coat finish for max. durability.
- Easily folds for storage — no tools needed!.
- Sealed tow bar arms keep moisture and road debris out.
- For all 2-inch ball-mount motorhome receivers.

38541 Tracker tow bar for ROADMASTER XL, EZ Twistlock, or Classic Brackets #020 1



Made in the USA

| | | | | | | | | | |
|---------------|---------|-------------------|------------|--------|------------------|----------------|-------------------|---------------|------------|
| In Section N: | Hitches | Hitch Accessories | Car Towing | Levels | Mirrors & Safety | Brake Controls | Towing Electrical | Brake & Wheel | Automotive |
|---------------|---------|-------------------|------------|--------|------------------|----------------|-------------------|---------------|------------|



Towing and Suspension Solutions

Mounting Brackets

No unsightly steel hanging off the front of your car!

ROADMASTER 'XL', 'MX' and 'EZ' series mounting brackets have detachable extensions which are easily removed when the car is not being towed.

- They're virtually invisible — improved aesthetics.
- Easy to install — ROADMASTER brackets use existing attachment points on the vehicle's undercarriage.
- Through-the-grille installation - no scraping brackets in dips or curbs.
- Easy to remove - convert from towed car to road car in seconds!



Now you see 'em...



...now you don't!

XL™ Bracket



EZ Twistlock™ Bracket



MX™ Bracket



Why are Roadmaster brackets rated #1?

- Largest selection in the industry
- Easiest to install
- Strongest design
- Computer tested

Tow Bar Covers

Heavy-duty, marine-grade black vinyl, hand-crafted at the ROADMASTER plant to custom-fit ROADMASTER tow bars. Proudly displaying their respective logos, these 'car wash safe' covers will help keep your tow bar free of dirt and road grime, ensuring smooth and easy tow bar operation.



- 30134** Sterling All Terrain tow bar cover #057-2 15
- 38170** StowMaster tow bar cover #052 10
- 39378** Falcon 2 tow bar cover (also fits Falcon) #055 15
- 39599** BlackHawk, BlackHawk 2 All Terrain and Falcon All Terrain tow bar cover #055-2 1



Made in the USA

Adaptor Bars

To adapt other manufacturers' tow bars to ROADMASTER brackets...

Adaptor components shown in white

(Tow bar and mounting brackets are not included)

38177 025 Adapts Reese, Valley, Eaz-Lift, Draw-Tite and Husky car-mounted tow bars to ROADMASTER brackets (see notes 1 and 2) #025 1

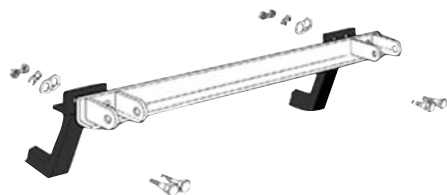

032 and 033 adapt motorhome-mounted Blue Ox tow bars (Aventa, Aventa II, Kar Bar, Aladdin, Alexxa, Acclaim), as well as Blue Ox "A frame" tow bars (with one- or three-pronged attachments) to ROADMASTER brackets. Also adapt Demco Aluminator, Dominator, Excalibar and Kwik-Tow tow bars to ROADMASTER brackets.

38664 032 allows you to disconnect the adapter bar and the removable front bracket arms. The Guardian rock guard and Nixtopper crossbar cover will work with this adaptor #032 1

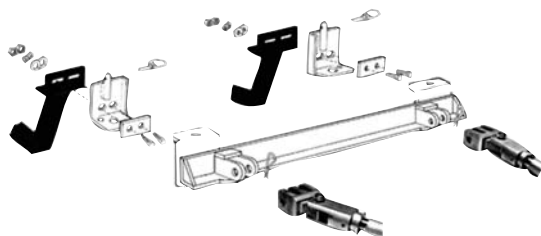

033 – The adapter is permanently bolted to the mounting bracket (see notes 1 and 2).

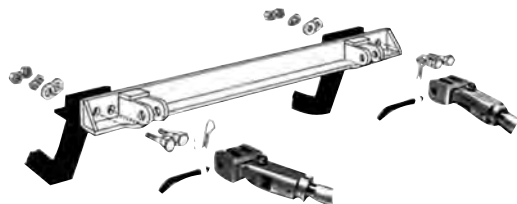

038 – Adapts Duncan Towmatic II, Karbar and EazAligner 2000 car-mounted tow bars to ROADMASTER brackets (see notes 1 and 2).

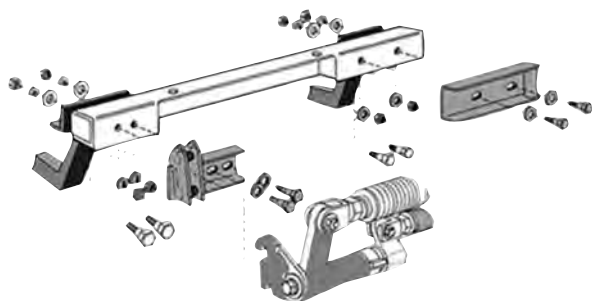

Towing and Suspension Solutions

To adapt ROADMASTER tow bars to other manufacturers' brackets...

031 – Adapts ROADMASTER Falcon, BlackHawk, BlackHawk All Terrain and Falcon All Terrain tow bars to Blue Ox brackets. Also adapts Sterling tow bars (with serial numbers up to 14,500) to Blue Ox brackets.



031-5 – Adapts all ROADMASTER Sterling tow bars (with serial nos. above 14,501) to Blue Ox brackets.



034 – Adapts ROADMASTER Falcon, BlackHawk, BlackHawk All Terrain, and Falcon All Terrain tow bars to Demco brackets. Also adapts Sterling tow bars (with serial nos. up to 14,500) to Demco brackets.



034-5 – Adapts the ROADMASTER Sterling tow bar (with serial numbers above 14,501) to Demco brackets.



Note 1: in order to remove the front extensions on ROADMASTER XL or EZ Twistlock brackets, you will need quick-disconnects in addition to the adaptor.

Note 2: this adaptor does not fit MX or MS series brackets.

(Tow bars and mounting brackets are not included with adaptor bars.)



Made in the USA

| | | | | | | | | | |
|---------------|---------|-------------------|------------|--------|------------------|----------------|-------------------|---------------|------------|
| In Section N: | Hitches | Hitch Accessories | Car Towing | Levels | Mirrors & Safety | Brake Controls | Towing Electrical | Brake & Wheel | Automotive |
|---------------|---------|-------------------|------------|--------|------------------|----------------|-------------------|---------------|------------|

Combo Kits + Padlock



Towing and Suspension Solutions

Combo Kits contain all the necessary accessories you need, matched to your ROADMASTER tow bar.

Each kit contains:

- Electrical components - a wiring kit with four Hy-Power diodes; a power cord to connect the vehicles, with a 7-wire plug for the motorhome (attached) and a plug and socket for the towed vehicle (except the Sterling All-Terrain tow bar, which comes with a power cord); a bracket to mount the power cord socket
- A pair of safety cables rated at 6,000- or 8,000-pound capacity, depending on the model you choose (except the Sterling All Terrain tow bar, which comes with safety cables).
- Two case-hardened steel padlocks (keyed alike) - for added security.
- A marine-grade vinyl cover to protect your tow bar.
- A marine-grade vinyl storage bag - for all your towing accessories.

- 30137** Sterling All Terrain Combo Kit (6,000-pound capacity) #9284-2 1
- 39739** Falcon All Terrain Combo Kit (6,000-pound capacity) #9241-2 1
- 39740** BlackHawk 2 All Terrain Combo Kit (8,000-pound capacity) #9294-2 1
- 39379** Falcon 2 Combo Kit (6,000-pound capacity) with coiled safety cables and coiled wiring #9240 1
- 39380** Falcon 2 Combo Kit (6,000-pound capacity) with straight safety cables and straight wiring #9241 1
- 39553** StowMaster Combo Kit (6,000-pound capacity) #9254 1
- 38313** Coupler padlock #305 6



38313

Coupler Padlock



Safety Cables

Our aircraft-type, galvanized steel safety cables are continuously tested to ROADMASTER's exacting standards. Each comes fitted with heavy-duty, drop-forged steel hooks with spring-loaded latches. Vinyl coating prevents the safety cables from scratching or chipping the tow bar. Each kit contains two cables, snap hooks and two quick links. Rated at either 6,000- or 8,000-pound capacity, depending on the model you choose.

- 38454** 68" 6,000-pound capacity single hook coiled - 1 pair #643 10
- 38181** 64" 6,000-pound capacity single hook straight - 1 pair #645 15
- 38183** 64" 6,000-pound capacity double hook straight - 1 pair #646 15
- 39566** 64" 8,000-pound capacity single hook straight - 1 pair #649 8



38181

EZ Hook Safety Cable

EZ Hook safety cables are faster to connect than other cables. They have all the features of the standard cables (see above), with the addition of a unique attachment system — a stainless steel ball at the end of the cable latches into a slotted anchor plate. Included with the Sterling All Terrain tow bar, EZ Hook safety cables fit all ROADMASTER mounting brackets with quick-disconnects.

- 39030** 1 pair EZ Hook 68" safety cables with anchor plates (6,000-pound capacity) #655 1



EZ hook safety cable



Made in the USA

Pins, Clips, Cables & Links



Towing and Suspension Solutions

It's bound to happen: a part gets lost or misplaced. Here's a partial list of the parts and accessories we have available. If it's not listed here, call us at 800-669-9690, tell us what you're missing, and we'll find what you need.

| Pins and Clips | | | All Terrain | Blackhawk | Eagle | Falcon | Falcon 2 | Sterling | StowMaster | Tracker |
|----------------|---------|--|-------------|-----------|-------|--------|----------|----------|------------|---------|
| 38832 | #910026 | 2-pack safety pin with clasp | | | • | • | | | | |
| 38833 | #910024 | 2-pack QD linch pins | • | • | • | • | • | • | • | |
| 38834 | #910023 | 2-pack storage hairpin | | | | | | | • | |
| 38338 | #910029 | 2-pack base pin with cable and linch pin | • | • | • | • | • | • | | |
| 38842 | #910022 | 2-pack quick links for cables | | | | | | | | |

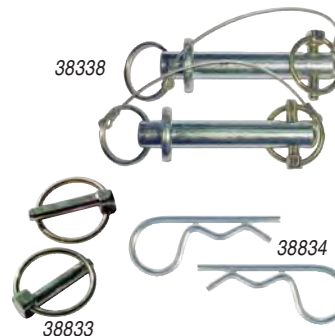

Towing Accessories

QUICK-DISCONNECTS

These replacement packs are available in full and half sets; a replacement set of quick-disconnect base assembly components is also available.

- 38191** 1 set quick-disconnects #201 1
- 38684** 1/2 set quick-disconnects; (both car sides) #222 1
- 39603** Quick-disconnect crossbar assembly. Includes car side quick-disconnects, crossbar, linch pins and base pins #910021-00 1

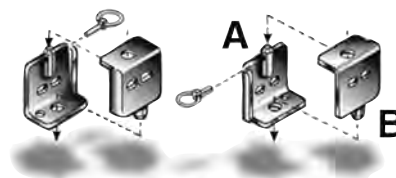

XL™ RECEIVER INSERTS

Designed for ROADMASTER XL series brackets, these heavy gauge steel caps help keep out dirt, gravel and grime when your XL brackets are removed. Fit all 1-1/2" diameter tubes.

- 39034** XL receiver inserts, 1 pair, black (exact size as the chrome version shown to the right) #200-5 g



LUBEMASTER™ SILICONE SPRAY

LubeMaster is the ideal lubricant for tow bars, awning arms, window tracks, folding steps, or for hundreds of other applications around the home and RV. It's a dry silicone, which doesn't attract dirt or road grime that can cause binding. Meets Volatile Organic Compound (VOC) standards.

- 38540** LubeMaster silicon spray #747 12



ADJUSTABLE TIE-DOWN STRAP

For ROADMASTER tow dollies. One size adjusts to fit tires from 12" to 16". Sold per each.

- 38668** Adjustable Tie-Down Strap #2150 10

QUIET HITCH™

Quiet Hitch stops sway and wander before it begins by eliminating any free play between the receiver and the tow bar (or bike rack, ball mount of whatever you insert).

- Bolts on in seconds.
- For most 2-inch hitch receivers.

- 31820** Quiet Hitch for 2" class 3 and 4 receivers #061 1



Made in the USA

| | | | | | | | | | |
|---------------|---------|-------------------|------------|--------|------------------|----------------|-------------------|---------------|------------|
| In Section N: | Hitches | Hitch Accessories | Car Towing | Levels | Mirrors & Safety | Brake Controls | Towing Electrical | Brake & Wheel | Automotive |
|---------------|---------|-------------------|------------|--------|------------------|----------------|-------------------|---------------|------------|

Hitch Accessories



Towing and Suspension Solutions

HI-LOW HITCHES

Use a Hi-Low Hitch to level the RV hitch to the tow bar. Available in four-, six-, eight-, and 10-inch drops.

- Fit nearly all 2" receiver hitches.
- **10,000 lb. GVWR capacity;** 400 lb. tongue weight max.

- 30393** 4" Hi-Low Hitch #048-4 1
- 30394** 6" Hi-Low Hitch #048-6 1
- 30395** 8" Hi-Low Hitch #048-8 1
- 30396** 10" Hi-Low Hitch #048-10 1



DUAL HITCH RECEIVER

With this dual-purpose hitch receiver, you can add a bike carrier or other hitch accessory to the rear of your motorhome.

- For car and boat owners alike.
- Fits most 2" hitch receivers.
- 10,000-pound capacity; 400-pound maximum tongue weight.
- Solid steel construction.
- Computer-designed and -tested.
- Powder coated for maximum durability.

- 30388** 2" Dual Hitch Receiver #077-2 1
- 30389** 4" Dual Hitch Receiver #077-4 1



4" AND 6" HI-LOW DROPS, 7-1/2" AND 12" EXTENSIONS

The shanks on the Hi-Low Drops can be turned up or down, for low- or high-ground clearance. The hitch receiver extensions provide 7-1/2 and 12 inches, for those towing systems which need a little more reach. Only for towing a car behind a motorhome - not for use with any type of trailer.

- 38452** 4" Drop Receiver (flip to raise 4") #070 1
- 39182** 6" Drop Receiver (flip to raise 6") #076 1
- 32040** 7-1/2" Hitch Receiver Extension #071-75 4
- 38453** 12" Hitch Receiver Extension #071 1



PROTECT YOUR TOWED VEHICLE AND RV AGAINST DINGS AND ROCK CHIPS

The Guardian is crafted from rotationally-molded, high-impact polyethylene to absorb the impact of rocks, gravel and road debris - instead of ricocheting it back at the motorhome. The Guardian can be attached and removed in seconds, and fits all ROADMASTER tow bars equipped with quick-disconnects. (Note: MX brackets will not accommodate the Guardian.)

- 38539** Guardian Rock Shield #4000 10



Protection



REMOVABLE MUDFLAP SYSTEM

RoadWing's "anti-sail" design keeps the mud flaps down, where they can stay on the job — double-bolt attachment points hold the system in place, as well as level on the bevel, and grooved interior channels deflect rocks, gravel and road debris down and away from your towed vehicle or trailer. The RoadWing slides over your ball mount or tow bar stinger, and is easily attached with set bolts, or just as easily detached. The 24" x 24" flaps can be trimmed to fit nearly any vehicle. The model above (77-inch) fits full-size trucks.

- 39179** Removable MudFlap System #4400 1



Protection



Towing and Suspension Solutions



ROADMASTER TOW DEFENDER

The Tow Defender's all-weather, heavy-duty screen deflects rocks, gravel and road debris down and away, protecting your towed vehicle's finish, headlights and windshield against chips and dings. The vinyl-coated mesh lets air through, keeping it low and over the road.

Fully extended, the Tow Defender offers 20 square feet of protection, and is held in place with shock-absorbing steel struts.

Once you've reached your destination, roll up the Tow Defender, snap the elastic straps around each end and store it against the motorhome.

- Quick installation and release.
- Lightweight and compact - weighs just 14-1/2 pounds, and rolls up to four inches in diameter.
- Powder-coated steel supports and heavy-duty gas struts for maximum durability, support and cornering flexibility.
- Fits all motorhome-mounted ROADMASTER tow bars, Blue Ox tow bars and Demco tow bars."

32041 Tow Defender #4750 **1**

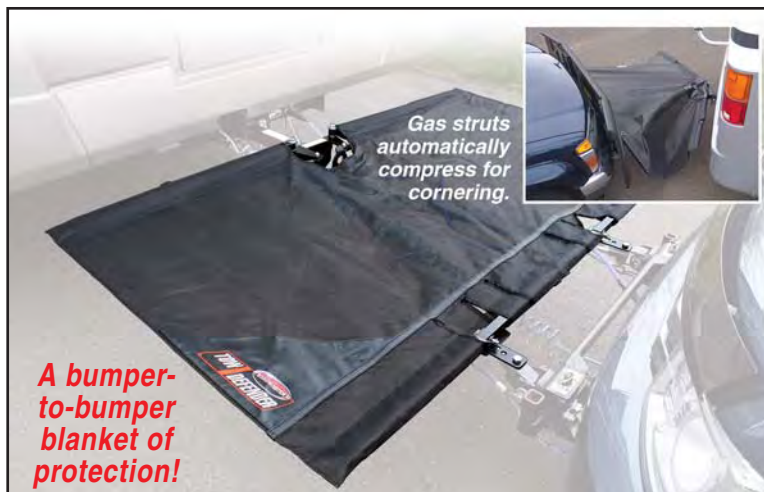

NIXTOPPER™

Patent pending

ROADMASTER NIXTOPPER™ CROSSBAR COVER

Protects and covers your ROADMASTER brackets and crossbar

The quick and easy way to add some pizzaazz to the front of a towed vehicle without having to remove the crossbar. Simply remove the linch pins, position the Nixtopper over the quick-disconnects and replace the pins.

- Made of black high impact ABS.
- Comes with a front license plate frame.
- Attaches in seconds and is just as quickly removed.
- Fits any ROADMASTER towing system with a quick-disconnect release.

31880 Nixtopper QD Crossbar Cover #4100 **1**



Before Nixtopper...



Made in the USA

ROADMASTER SUPPLEMENTAL BRAKING

TOWING
& SAFETY

N

| | | | | | | | | | |
|---------------|---------|-------------------|------------|--------|------------------|----------------|-------------------|---------------|------------|
| In Section N: | Hitches | Hitch Accessories | Car Towing | Levels | Mirrors & Safety | Brake Controls | Towing Electrical | Brake & Wheel | Automotive |
|---------------|---------|-------------------|------------|--------|------------------|----------------|-------------------|---------------|------------|



U.S. patent number 5,915,798

ROADMASTER BRAKEMASTER "DIRECT" PROPORTIONAL BRAKING

WHAT IS BRAKEMASTER?

BrakeMaster is ROADMASTER's 'direct' proportional braking system. It connects directly to the motorhome's air or hydraulic braking system for rock-solid, reliable braking - brake line pressure in the motorhome controls the brakes in the towed vehicle. Because it connects directly to what powers your motorhome's brakes, BrakeMaster is a truly proportional, truly synchronized braking system - however you brake the motorhome, BrakeMaster automatically applies the same pressure. Every time. Connects and disconnects from the towed vehicle in under a minute, without any tools, adjustments or settings - attach the brake pedal clamp, secure to the floor or seat adaptor, quick-connect the air hose, and you're ready to tow. Weighs just 3-3/4 pounds and measures 17 inches in length - stores almost anywhere.

- Works in virtually any motorhome.
- Works in virtually any towed vehicle with power brakes.
- Easily disconnects from the brake pedal - from towed car to road car in seconds!
- Includes a break away emergency braking system.
- Meets U.S. and Canadian braking requirements.

Towing and Suspension Solutions



BrakeMaster LED
An LED in the motorhome provides a visual reference of braking activity.

38983 BrakeMaster 9060 with BrakeAway for motorhomes with hydraulic brakes #9060 1

38737 BrakeMaster 9100 for motorhomes with air or air over hydraulic brakes #9100 1

38984 BrakeMaster 9160 with BrakeAway for motorhomes with air or air over hydraulic brakes #9160 1

BrakeMaster reliability for your hybrid or Hummer!

With the Brake Pressure Reducer, you can install BrakeMaster in a hybrid, a Hummer H3, or in any vehicle with a full-time ('active') power braking system. Working in conjunction with these braking systems, the Brake Pressure Reducer delivers a correspondingly reduced braking pressure that eliminates over-braking issues associated with these hybrids and Hummers. In addition to BrakeMaster, the Brake Pressure Reducer works in other supplemental braking systems which use pressurized air to brake the towed vehicle.



30836

30836 Brake Pressure Reducer #900002 1

ROADMASTER INVISIBRAKE™— A REVOLUTIONARY INNOVATION IN SUPPLEMENTAL BRAKING

INVISIBRAKE

WHAT IS INVISIBRAKE?

InvisiBrake is a fully-automatic, progressive supplemental braking system that uses the electrical connections already in place on your towed vehicle (the towed vehicle's electrical harness) to brake when you brake the motorhome — the same electrical signal that activates the towed vehicle's brake lights also activates InvisiBrake.

FEATURES

- Completely out of sight—InvisiBrake is so small it can usually be mounted under the driver's seat, under the rear seat, behind interior panels or in the trunk, without sacrificing any of the vehicle's usable space.
- Progressive braking—When you apply continuous braking force, so does InvisiBrake — the longer you apply the brakes in the motorhome, the harder your towed vehicle will brake. (InvisiBrake will not skid your tires.)
- Bypasses the 12-volt outlet and charges your battery—InvisiBrake connects directly to the towed vehicle's battery and constantly charges the battery during towing — InvisiBrake will never drain the battery.
- Two-stage motorhome monitor—InvisiBrake includes an LED monitor for a visual reference of braking activity; an audible alert at the motorhome will warn you if the brakes have been on for too long.
- Activates only when the motorhome's brake lights illuminate — no false braking!
- Works in virtually any towed vehicle — including those with full-time ('active') power braking systems
- Includes an emergency break away system
- Easily adjusts to individual braking preferences—braking pressure is adjustable from five to 80 psi.
- Meets U.S. and Canadian braking requirements



Patent pending

NOTHING. Zip. Zero. Zilch. Nada.
That's what you have to do to connect and disconnect InvisiBrake. There's nothing to take in and out of your towed vehicle, and there's nothing to push, pull, set, adjust, activate or deactivate.

What could be easier than nothing at all?

31978 InvisiBrake, Hidden Brake System #8700 1

Electrical

FLEXO-COIL™ CORDS

ROADMASTER's Flexo-Coil electrical cords are water-, oil- and chemical-resistant, and the plugs are injected with silicone to prevent corrosion. Flexo-Coil cords expand to more than eight feet and conveniently retract for storage. They are designed for tow bars without cable channel guides.

- 38186** 4-wire Flexo-Coil cord with plugs and sockets #164 10
39556 4-wire Flexo-Coil cord with plugs, sockets and socket bracket #1644 10
30146 7- to 4-wire Flexo-Coil cord with plugs, sockets and socket bracket #164-7 1
38187 6-wire Flexo-Coil cord with plugs and sockets #146 10
39557 6-wire Flexo-Coil cord with plugs, sockets and socket bracket #1466 8
30148 7- to 6-wire Flexo-Coil cord with plugs, sockets and socket bracket #146-7 1

BRITE-LITE™ 3-TO-2 WIRING CONVERTER

If you have this — the motorhome has separate brake and turn signal lights; the towed vehicle has combined brake and turn signal lights.

Then you need this — the Brite-Lite wiring converter connects a vehicle with a separate brake and turn signal system to a vehicle with a combined brake and turn system, while delivering more current to the towed vehicle's brake and turn signal lights for brighter illumination.



- 38431** Brite-Lite 3-to-2 converter #732 25

By law, a towed vehicle's turn signals, running lights and brake lights must mimic the motorhome's. Both of these kits have their advantages, and both come with all the necessary components and step-by-step instructions.

UNIVERSAL WIRING KIT

This kit uses a system of diodes to connect your towed vehicle's turn signals, running lights and brake signals to your motorhome's. Diodes prevent electrical feedback and protect both vehicles' electrical systems.

The kit comes complete with:

- four Hy-Power™ diodes (more diodes may be purchased separately);
- a 30-foot strand of four-wire electrical cord;
- three feet of split wire loom;
- six-foot extension cord (connects the towed vehicle to the motorhome);
- a ring terminal;
- cable ties;
- wire connectors; and
- step-by-step installation instructions.

- 39552** Universal Wiring Kit with 4 Hy-Power diodes #154 10
38430 Universal Wiring Kit with 2 Hy-Power diodes #150 10

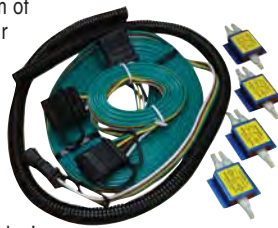

TAILLIGHT WIRING KIT w/bulbs

A self-contained wiring system that bypasses your towed vehicle's lighting with a set of independent plugs and sockets mounted inside the taillights. Wiring is routed from the taillights to the grille area.

Since the towed vehicle's electrical system is bypassed, this kit eliminates the concern of interacting with any vehicle electronics.

Important: The towed vehicle's taillight must have room for an extra socket and bulb inside the lens housing.

- 38671** Taillight Wiring Kit w/Bulbs #155 10



Towing and Suspension Solutions



AUTOMATIC BATTERY DISCONNECT

Eliminate the inconvenience and danger of pulling your battery cable with the Automatic Battery Disconnect. The Automatic Battery Disconnect is ideal for anyone towing a Jeep Liberty, Jeep Wrangler or any other vehicle which must be towed with the battery cable disconnected, and also for anyone who wants the security of knowing they'll always have a fully-charged battery during and after towing. With the Automatic Battery Disconnect, supplemental braking systems cannot drain the battery. The Automatic Battery Disconnect comes with a marine-grade high-amperage solenoid (200-amp constant duty, 600-amp surge) and is preassembled for easy installation (average installation time: 30 to 45 minutes)



- 10007** Automatic Battery Disconnect #765 1



HUSKY MAGNETIC TOWING LIGHTS



The Husky towing lights have over 35% more holding power and larger magnets than competitive models. They include a plug cover to keep dirt and corrosion out.

The magnets come with an e-coated magnet cap to eliminate rust and protect the vehicle from scratches. Wired to industry standard 4-way flat connector. Comes in a clam shell that can be used as a storage container. Includes tow vehicle hook-up plug and long 20' cord. Useful for RV, agricultural, industrial, marine and automotive needs. Complete with instructions.

- 17929** Magnetic Towing Lights #17929 10

TOW BAR ELECTRICAL

TOWING
& SAFETY

N

| | | | | | | | | | |
|---------------|---------|-------------------|------------|--------|------------------|----------------|-------------------|---------------|------------|
| In Section N: | Hitches | Hitch Accessories | Car Towing | Levels | Mirrors & Safety | Brake Controls | Towing Electrical | Brake & Wheel | Automotive |
|---------------|---------|-------------------|------------|--------|------------------|----------------|-------------------|---------------|------------|

HUSKY Premium Tail Light Isolators

Provides a safe and convenient way to use factory lights on towed vehicles while protecting sensitive electronics from voltage feedback.
 • Permanently installs on tow vehicle, near tail lights. • Heavy duty, 30-amp rating. • Aluminum heat sink prevents diode failure caused by overheating. • Easy installation: includes connectors and adhesive mounting pad.

| Description | Part # |
|--|--------|
| Husky Tail Light Isolator (Diode), 1/Card | 39869 |
| Husky Tail Light Isolators (Diodes), 2/Card | 39870 |
| Husky Tail Light Isolators (Diodes), 3/Card | 39871 |
| Husky Tail Light Isolators (Diodes), 4/Card <i>Limited Supply</i> | 39866 |
| Husky Tail Light Isolators (Diodes), 25/Box | 39868 |
| Premium Parking Light Isolator | |
| Allows use of towed vehicle's lights. Prevents feedback between RV and car. If the towed vehicle's lights are turned on while still plugged into the motorhome, the motorhome will draw from the towed vehicle to supply power to all of the park lights. This will place a heavy load on the towed vehicle's wiring, and can result in severe electrical system damage. Using the Husky Parking Light Isolator will prevent this, while still allowing the motorhome to power the towed vehicle's park/tail lights. • Permanently installs on tow vehicle near tail lights. • Heavy duty, 30-amp rating. • Aluminum heat sink prevents diode failure caused by overheating. • Easy installation: includes connectors and adhesive mounting pad. | |
| Parking Light Diode, 1/Card | 39867 |
| Tail Light Isolator Wiring Kit | |
| Recommended installation kit for Husky Premium Taillight Isolators. • Use the towed vehicle's light system for towing. • Permanently installs on towed vehicle. • 26' of 16 gauge ribbon wire with 4-way flat connector. • Includes wire, connectors and installation hardware. <i>Diode kits sold separately.</i> | |
| Wiring Kit for Isolator, 1/Card | 13984 |
| Tail Light Isolator Wiring Kit with Bulbs | |
| Isolated, internal light system for towing. Eliminates cutting into factory wires. • Use this kit in place of tail light isolators. • Permanently installs on towed vehicle. • Fits most vehicles with clearance in taillight housing. • 26' of 16 gauge ribbon wire with 4-way flat connector. • Easy installation includes wires, connectors, bulbs, sockets, installation hardware and instructions. | |
| Tail Light Wiring Kit, 1/Card | 13985 |
| Tow Bar Wire Harness | |
| Recommended for all tow bars. 80" long with 4-pin flat connectors. • Permanently installs on tow bar. • Easy installation. • Includes wire ties. | |
| Tow Bar Wiring Harness, 1/Card | 13986 |
| Tow Bar Wiring Kit | |
| Recommended installation kit for Husky Premium Tail Light Isolators. • Permanently installs on towed vehicle. • Includes 26' of 16 gauge wire. • Easy installation includes, cables, connectors and installation hardware. | |
| Tow Bar Wiring Kit, 1/Card | 13987 |



ROADMASTER HY-POWER™ DIODES

Diodes are used to tie into the towed vehicle's brake light, running light and turn signal wiring, and connect it to the motorhome. Diodes permit electrical current to flow in only one direction - from the motorhome to the towed vehicle's taillights - preventing electrical feedback and the damage it can cause to both vehicles' electronics. Hy-Power diodes have a heavy-duty, powder-coated aluminum heat sink, and each diode is protected against the elements - all components are housed inside an epoxy-sealed, powder-coated aluminum case. Four-pack required for most vehicles. Includes detailed wiring instructions.

- 38188 Single Hy-Power Diode #790 25
- 38189 2-Pack Hy-Power Diodes #792 15
- 38190 3-Pack Hy-Power Diodes #793 15
- 39028 4-Pack Hy-Power Diodes #794 1
- 38485 25-Pack Diodes, (bulk pack) #790-25 1

PARK LIGHT DIODE

Problem: Electrical damage can occur to the towed vehicle if its headlights are turned on while still connected to the motorhome.

Solution: Use a Park Light Diode to stop any interaction between the two park light systems, preventing electrical feedback and electrical damage.

Note: the Park Light diode will not replace Hy-Power diodes

- 38891 Single Park Light Diode #690 10



Towing and Suspension Solutions



| | | | | | | | | | |
|---------------|---------|-------------------|------------|--------|------------------|----------------|-------------------|---------------|------------|
| In Section N: | Hitches | Hitch Accessories | Car Towing | Levels | Mirrors & Safety | Brake Controls | Towing Electrical | Brake & Wheel | Automotive |
|---------------|---------|-------------------|------------|--------|------------------|----------------|-------------------|---------------|------------|

BRACKET GUIDE CODES:

- XL) Pull Pin To Remove Arm
- EZ) Twist To Remove, .use part# 210 insert
- EZ2) Twist To Remove, .use part# 212 insert
- MS) Non-Removable Arm
- MX) Pull Pin To Remove Arm, No Crossbar
- N) New Bracket
- C) Change in Bracket
- S/O) Special Order
- MT) Manufacturing Time Allow 3-4 Weeks.

IMPORTANT
Dealer times can vary in individual situations based on installation experience, vehicle hoist, tools and vehicle options.

MX and MS brackets are only for use with motorhome mounted tow bars. They eliminate the need for the included QD crossbar. The MX and MS brackets will not work with a car mounted tow bar like the STOWMASTER, nor will they work with the Easy Hook Safety Cables, Guardian or any accessory that requires a Roadmaster QD crossbar.

Limited Supply

| | |
|-----------|-------------------------------|
| Time Code | Avg. Dealer Installation Time |
| A |2.0 Hours |
| B |2.5 Hours |
| C |3.0 Hours |
| D |3.5 Hours |
| E |4.0 Hours |
| F |4.5 Hours |

ROADMASTER BRACKET APPLICATIONS

| MAKE / Model | Year | Comments | Type | Notes | Order | Kit# | Cost | Time* | |
|-------------------|-------|--|------|-------|-------|-------|------|-------|--|
| ACURA | | | | | | | | | |
| MDX | 01-06 | No brushguard or lower bumper trim. | XL | 47 | | 39357 | A | C | |
| BUICK | | | | | | | | | |
| ENCLAVE | 08-12 | Fits all. No brushguard. | EZ | 1 | | 30674 | A | C | |
| RAINEER | 04-07 | #3109-1 | XL | 1 | | 39188 | A | B | |
| CADILLAC | | | | | | | | | |
| ESCALADE | 02-06 | 1/2 ton, 2wd & AWD, also fits EXT. | XL | | | 39355 | A | B | |
| ESCALADE | 07-13 | NEW! Includes Hybrid. No Platinum or 2012-2013 Premium models | XL | 3 | | 30700 | A | A | |
| ESCALADE | 07-13 | NEW! Includes Hybrid. No Platinum or 2012-2013 Premium models | MX | 3,37 | | 30701 | A | A | |
| CHEVROLET | | | | | | | | | |
| AVALANCHE | 02-06 | Fits 1500 -1/2 ton,4wd & 2wd. No factory b'guard. | XL | | | 39355 | A | B | |
| AVALANCHE | 07-13 | Fits 1500 2wd, 4wd, LS, LT & LTZ. No brushguard. | XL | 3 | | 30700 | A | A | |
| AVALANCHE | 07-13 | Fits 1500 2wd, 4wd, LS, LT & LTZ. No brushguard. | MX | 3,37 | | 30701 | A | A | |
| COBALT | 05-10 | Fits all except S.S. models & sport models. Fits Cobalts with grill inserts. | EZ2 | 1,45 | | 30446 | A | B | |
| COLORADO | 10-12 | No Z71 or Xtreme. | XL | 50 | | 39915 | A | B | |
| COLORADO | 04-09 | Includes Z71 & 5.3 engine. No Xtreme | XL | 50 | | 39915 | A | B | |
| CRUZE | 11-12 | NEW! RS Package okay. No Active Air Shutter package. Check towability w/manufactur. | EZ2 | 3 | | 31948 | A | D | |
| HHR | 06-11 | Fits with foglights. No SS type. | XL | 1 | | 30441 | A | B | |
| MALIBU | 97-03 | #194-1 | XL | 40 | | 38416 | A | A | |
| MALIBU | 04-07 | Fits LS, LT, Maxx & LTZ and SS models. | EZ2 | 1 | | 39781 | A | C | |
| MALIBU CLASSIC | 08 | Fits LS, LT, Maxx, LTZ and SS models. | EZ2 | 1 | | 39781 | A | C | |
| MALIBU | 08-12 | Fits LS, LT, LTZ and Hybrid. | EZ2 | 1 | | 31681 | A | B | |
| SILVERADO 1500 | 99-02 | 1/2 ton, 4wd, Silverado, Z71. | XL | | | 38767 | A | B | |
| SILVERADO 1500 | 03-06 | 1500 and Z71 w/torsion bar. No HD or SS. | XL | | | 39355 | A | A | |
| SILVERADO 1500 | 03-06 | 1500 HD, 2500, 3500. No SS. | XL | | | 39879 | A | A | |
| SILVERADO 1500 | 07-13 | Fits new style 2wd & 4wd. | MX | 1, 37 | | 30701 | A | A | |
| SILVERADO 1500 | 07-13 | Fits new style 2wd & 4wd. | XL | 1 | | 30700 | A | A | |
| SILVERADO 2500 | 03-06 | 1500 HD, 2500, 3500. No SS. | XL | | | 39879 | A | A | |
| SILVERADO 3500 | 03-06 | 1500 HD, 2500, 3500. No SS. | XL | | | 39879 | A | A | |
| SILVERADO CLASSIC | 07 | 1500 and Z71 w/torsion bar. No HD or SS. | XL | | | 39355 | A | A | |
| SILVERADO CLASSIC | 07 | 1500 HD, 2500, 3500. No SS. | XL | | | 39879 | A | A | |
| SONIC | 12 | Fits sedan and hatchback models. No 1.4L turbo. | EZ2 | 1 | | 31164 | A | C | |
| SONIC | 12-13 | NEW! Fits sedan and hatchback models, turbo okay. | EZ2 | 1 | | 31420 | A | A | |
| SUBURBAN | 03-06 | 1500, LS, LT, Z71 | XL | | | 39355 | A | A | |
| SUBURBAN | 03-12 | 2500, LS, LT. No brushguard. | XL | 1 | | 39879 | A | A | |
| SUBURBAN | 07-13 | Fits 2wd, 4wd, LS, LT, LTZ & Z71. No B'guard or Hybrid. | XL | 3 | | 30700 | A | A | |
| SUBURBAN | 07-13 | Fits 1500 2wd, 4wd, LS, LT & LTZ. No brushguard. | MX | 3, 37 | | 30701 | A | A | |
| TAHOE | 03-06 | 4wd and 2wd with torsion bars. | XL | | | 39355 | A | A | |
| TAHOE | 07-13 | Fits 2wd, 4wd, LS, LT & LTZ. No b'guard, Hybrid or Z71 Off Road Package. | XL | 3 | | 30700 | A | A | |
| TAHOE | 07-13 | Fits 2wd, 4wd, LS, LT & LTZ. No b'guard, Hybrid or Z71 Off Road Package. | MX | 3, 37 | | 30701 | A | A | |
| TRACKER | 99-04 | 2dr & 4dr, okay with skidplate, no brush guard. | XL | | | 38760 | A | C | |
| TRAIL BLAZER | 02-09 | Relocate transmission cooler if required. No SS. | XL | 1 | | 39188 | A | B | |
| TRAVERSE | 09-12 | NEW! Fits all. No Brushguard. | EZ | 1,49 | | 30674 | A | C | |
| CHRYSLER | | | | | | | | | |
| PT CRUISER | 01-10 | Includes Turbo. | XL | 1 | | 30080 | A | C | |

ROADMASTER BRACKETS

**TOWING
& SAFETY**

| | | | | | | | | | |
|---------------|---------|-------------------|------------|--------|------------------|----------------|-------------------|---------------|------------|
| In Section N: | Hitches | Hitch Accessories | Car Towing | Levels | Mirrors & Safety | Brake Controls | Towing Electrical | Brake & Wheel | Automotive |
|---------------|---------|-------------------|------------|--------|------------------|----------------|-------------------|---------------|------------|

ROADMASTER BRACKET APPLICATIONS

| MAKE / Model | Year | Comments | Type | Notes | Order | Kit# | Cost | Time* | |
|---------------------------|-------|---|------|----------|-------|-------|------|-------|--|
| DODGE | | | | | | | | | |
| CARAVAN | 05-07 | Fits Grand | XL | 1 | | 30437 | A | C | |
| DURANGO | 01-03 | 4wd only, no brushguard. | XL | | | 39081 | A | A | |
| DURANGO | 11-13 | NEW! Fits all AWD models. No B'guard. Adaptive Cruise Control okay. Tow hooks need to be removed. | EZ | 1, 3, 49 | | 32018 | A | C | |
| PICK-UP DAKOTA | 01-03 | 4wd only, no brushguard. | XL | | | 39081 | A | A | |
| PICK-UP DAKOTA | 05-11 | 2wd and 4wd. | EZ | 3 | | 30445 | A | A | |
| PICK-UP RAM 1500 MEGA CAB | 06-08 | Fits with or without tow hooks. No SRT-10. | XL | | | 31224 | A | A | |
| PICK-UP RAM 2500 | 03-09 | 2wd, 4wd, Mega cab ok. Fits with or without tow hook. No Power Wagon. | XL | | | 31224 | A | A | |
| PICK-UP RAM 3500 | 03-09 | 2wd, 4wd, Mega cab ok. Fits with or without tow hook. No Power Wagon. | XL | | | 31224 | A | A | |
| FORD | | | | | | | | | |
| EDGE | 07-13 | No Adaptive Cruise Control. 2.0 EcoBoost okay except year 2013. Check owner's manual for towability. | XL | 1 | | 30702 | A | A | |
| ESCAPE | 08 | Fits all with manual transmission. | XL | 3 | | 31225 | A | A | |
| ESCAPE | 09-12 | NEW! Fits 2wd, 4wd, 4 cylinder and V6 | XL | 3 | | 31225 | A | A | |
| ESCAPE HYBRID | 08-12 | 2wd & 4wd. | XL | 3 | | 31225 | A | A | |
| EXPLORER | 02-05 | #480-1 | XL | | | 39138 | A | A | |
| EXPLORER | 06-10 | XLT, Eddie Bauer & Limited. | XL | 1 | | 30444 | A | A | |
| EXPLORER | 11-13 | No Adaptive Cruise Control | XL | 1 | | 31980 | A | B | |
| EXPLORER | 11-13 | NEW! Includes vehicles equipped with Adaptive Cruise Control & Collision Warning System. 2012 EcoBoost okay, no 2013 | XL | 1 | | 32038 | A | A | |
| EXPLORER SPORT TRAC | 07-10 | Fits XLT and Limited. No Adrenalin or Brushguard. | XL | 1 | | 30444 | A | A | |
| F-150 | 04-12 | 2wd & 4wd XL, XLT, King Ranch, Sport & 09-12 STX okay. No H' Davidson, Lightning, STX, Raptor, Lariat Limited or EcoBoost. | XL | 1 | | 39916 | A | A | |
| FOCUS | 12-13 | NEW! Fits S, SE, SEL & Titanium. No ST or Adaptive Cruise Control. | EZ2 | 1,49 | | 32037 | A | D | |
| RANGER EDGE | 01-05 | 2 & 4 wd. No Skidplate, no tremor. Must have tow hooks. | XL | | | 39886 | A | B | |
| RANGER PICK-UP | 06-11 | 2wd Sport only. | XL | | | 39886 | A | B | |
| RANGER PICK-UP | 07-11 | 4wd fits all. | XL | | | 39886 | A | B | |
| GEO | | | | | | | | | |
| TRACKER | 99-04 | 2dr & 4dr, okay with skidplate, no brushguard. | XL | | | 38760 | A | C | |
| GMC | | | | | | | | | |
| ACADIA | 07-12 | Includes Denali. No Brushguard. | EZ | 1,49 | | 30674 | A | C | |
| CANYON | 04-09 | Includes Z71 & 5.3 engine. No Xtreme. | XL | 50 | | 39915 | A | B | |
| CANYON | 10-11 | No Z71 or Xtreme. | XL | 50 | | 39915 | A | B | |
| ENVOY | 02-09 | Also fits XUV. No Envoy Denali. | XL | | | 39186 | A | B | |
| ENVOY DENALI | 05-09 | Includes XL. | XL | 1 | | 39188 | A | B | |
| SIERRA 1500 | 99-02 | 1/2 ton, 4wd, Sierra only. | XL | | | 38767 | A | B | |
| SIERRA 1500 | 03-06 | 1500 with torsion bar, No HD or SS. | XL | | | 39355 | A | A | |
| SIERRA 1500 | 07-13 | Fits new style 2wd & 4wd. | MX | 1, 37 | | 30701 | A | A | |
| SIERRA 1500 | 07-13 | Fits new style 2wd & 4wd. | XL | 1 | | 30700 | A | A | |
| SIERRA 1500 HD | 03-06 | 1500 HD, 2500, 3500. No SS. | XL | | | 39879 | A | A | |
| SIERRA 2500 | 03-06 | 1500 HD, 2500, 3500. No SS. | XL | | | 39879 | A | A | |
| SIERRA 3500 | 03-06 | 1500 HD, 2500, 3500. No SS. | XL | | | 39879 | A | A | |
| SIERRA CLASSIC | 07 | 1500 HD, 2500, 3500. No SS. | XL | | | 39879 | A | A | |
| SIERRA CLASSIC | 07 | 1500 with torsion bar, no HD or SS. | XL | | | 39355 | A | A | |
| YUKON | 03-06 | 2wd & 4wd also XL 1/2 ton. | XL | | | 39355 | A | A | |
| YUKON | 03-07 | XL 3/4 ton and Quadra Steer. | XL | | | 39879 | A | A | |
| YUKON | 07-13 | Fits 1500 2wd & 4wd. XL okay. No brushguard. | XL | 1 | | 30700 | A | A | |
| YUKON | 07-13 | Fits 1500 2wd & 4wd. XL okay. No brushguard. | MX | 1, 37 | | 30701 | A | A | |
| YUKON DENALI | 03-06 | Also XL Denali. | XL | | | 39355 | A | A | |
| HONDA | | | | | | | | | |
| ACCORD | 98-07 | No Hybrids. | XL | 1 | | 39578 | A | C | |
| CRV | 97-01 | #1528-3 | XL | 1 | | 38763 | A | A | |
| CRV | 02-04 | Without brushguard. | XL | | | 39342 | A | C | |

| | | | | | | | | | |
|---------------|---------|-------------------|------------|--------|------------------|----------------|-------------------|---------------|------------|
| In Section N: | Hitches | Hitch Accessories | Car Towing | Levels | Mirrors & Safety | Brake Controls | Towing Electrical | Brake & Wheel | Automotive |
|---------------|---------|-------------------|------------|--------|------------------|----------------|-------------------|---------------|------------|

ROADMASTER BRACKET APPLICATIONS

| MAKE / Model | Year | Comments | Type | Notes | Order | Kit# | Cost | Time* | |
|------------------------------|-------|---|------|----------|-------|-------|------|-------|--|
| HONDA (... continued) | | | | | | | | | |
| CRV | 05-06 | No brushguard or extra trim package. | XL | 1 | | 30072 | A | C | |
| CRV | 07-11 | 2wd & 4wd okay. Fits US & Japan built. No brushguard. | XL | 1 | | 30537 | A | C | |
| CRV | 12-13 | NEW! Fits all. No brushguard. | EZ2 | 1 | | 31186 | A | C | |
| ELEMENT | 03-06 | No EX-P. Check towability w/manufacturer. | XL | | | 39342 | A | C | |
| FIT | 07-08 | Bracket box date must be 3/31/08 & newer to fit with foglights. Check towability w/manufacturer. | EZ2 | 1 | | 31229 | A | B | |
| PILOT | 03-05 | No brushguard. | XL | | | 39357 | A | C | |
| ISUZU | | | | | | | | | |
| ASCENDER | 03-08 | #3109-1 | XL | | | 39188 | A | B | |
| PICK-UP I350 | 06-08 | #3122-1 | XL | 50 | | 39915 | A | B | |
| JEEP | | | | | | | | | |
| CHEROKEE | 91-01 | W/o brushguard, fits laredo,country,sport,limited. | XL | 1, 25 | | 38417 | A | B | |
| COMMANDER | 06-10 | Also fits Limited. | XL | 1 | | 30073 | A | A | |
| COMMANDER | 06-10 | Also fits Limited. | MX | 1,37 | | 30534 | A | A | |
| GRAND CHEROKEE | 93-98 | Also fits laredo & limited. | XL | 14 | | 38210 | A | B | |
| GRAND CHEROKEE | 99-00 | Laredo,limited, 6&8cyl, no b'guard. | XL | 1 | | 38946 | A | B | |
| GRAND CHEROKEE | 01-03 | Also fits limited, no brush guards. | XL | | | 39052 | A | B | |
| GRAND CHEROKEE | 04 | #1425-1 | XL | | | 39611 | A | B | |
| GRAND CHEROKEE | 05-10 | No Brushguard or SRT-8. Fits Hemi & Diesel. | XL | | | 30073 | A | A | |
| GRAND CHEROKEE | 05-10 | No Brushguard or SRT-8. Fits Hemi & Diesel | MX | 37 | | 30534 | A | A | |
| GRAND CHEROKEE | 11-13 | NEW! Fits all. Adaptive Cruise Control okay. No B'guard. Tow hooks need to be removed. No SRT-8. | EZ | 1, 3, 49 | | 32018 | A | C | |
| GRAND WAGONEER | 93-98 | also fits laredo & limited. #1411-2 | XL | 14 | | 38210 | A | B | |
| LIBERTY | 02-05 | No b'guard. 05 may req. trimming. Diesel ok. | XL | 14 | | 39190 | A | C | |
| LIBERTY | 02-07 | No b'guard. 05 & later may req trimming. Diesel ok. | EZ | 1, 14 | | 39877 | A | C | |
| LIBERTY | 08-12 | Fits Sport, Limited & Limited Jet Edition. No brushguard, rockguard or skid plate package. | EZ | 1 | | 30848 | A | C | |
| WRANGLER | 96-06 | Includes Unlimited, Rubicon & double tube bumper. No front leaf springs. | XL | 44 | | 39593 | A | B | |
| WRANGLER | 98-02 | U-channel bumper only. | | 1,34 | | 38531 | W | B | |
| WRANGLER | 99-02 | U-channel or single tube bumper only. | XL | 44 | | 38989 | A | B | |
| WRANGLER | 07-09 | Fits all 2 & 4 door models. No aftermarket bumpers winches, guards or Call of Duty. | XL | 3,51 | | 30850 | A | A | |
| WRANGLER | 07-09 | Fits all 2 & 4 door models. No aftermarket bumpers winches, guards or Call of Duty. | MX | 3, 37,51 | | 31231 | A | B | |
| LINCOLN | | | | | | | | | |
| MARK LT | 06-08 | Fits 2wd and 4wd. | XL | 1 | | 39916 | A | S | |
| MKX | 07-13 | No Adaptive Cruise Control. No 2.0 EcoBoost. | XL | 1 | | 30702 | A | A | |
| MAZDA | | | | | | | | | |
| TRIBUTE | 08 | Fits manual transmission. | XL | 3 | | 31225 | A | A | |
| TRIBUTE | 09-11 | Fits 2wd, 4wd, 4 cylinder and V6. | XL | 3 | | 31225 | A | A | |
| TRIBUTE HYBRID | 08-09 | Fits all. | XL | 3 | | 31225 | A | A | |
| MERCEDEZ-BENZ | | | | | | | | | |
| SMART FORTWO | 08-13 | Fits all. | EZ2 | 1 | | 31442 | A | E | |
| MITSUBISHI | | | | | | | | | |
| RAIDER | 06-09 | 4wd. | EZ | 3 | | 30445 | A | A | |
| PONTIAC | | | | | | | | | |
| G6 | 05-09 | Fits all except GXP & convertibles. Will not fit 09 models with new mid-year revised fascia. | XL | 1, 3 | | 30438 | A | C | |
| PURSUIT | 05-07 | Fits SE sedan. No coupes or GT models. | EZ2 | 1 | | 30446 | A | B | |
| SATURN | | | | | | | | | |
| AURA | 07-09 | Fits XE, XR and Hybrids. | EZ2 | 1 | | 30533 | A | B | |
| ION | 05-07 | Fits all except Redlines & Exterior Perf. Package. | XL | 1, 3 | | 30439 | A | B | |
| L-SERIES | 00-02 | Sedans & wagons. | EZ | | | 38858 | A | B | |
| L-SERIES | 03-05 | Sedans & wagons. | EZ2 | | | 39562 | A | A | |
| OUTLOOK | 07-10 | Fits all. No brushguard. | EZ | 1 | | 30674 | A | C | |
| VUE | 02-03 | check owner manual for towability. | XL | | | 39384 | A | A | |
| VUE | 04-05 | Four cylinder only. No Redline or V6 models. | XL | | | 39384 | A | A | |
| VUE | 04-07 | V6 only, no redline or factory brushguard. | XL | 1, 49 | | 39780 | A | A | |
| VUE | 06-07 | 4-Cyl. No V6, Redline or brushguard. | XL | 49 | | 30440 | A | B | |

ROADMASTER BRACKETS

TOWING & SAFETY

| | | | | | | | | | |
|---------------|---------|-------------------|------------|--------|------------------|----------------|-------------------|---------------|------------|
| In Section N: | Hitches | Hitch Accessories | Car Towing | Levels | Mirrors & Safety | Brake Controls | Towing Electrical | Brake & Wheel | Automotive |
|---------------|---------|-------------------|------------|--------|------------------|----------------|-------------------|---------------|------------|

ROADMASTER BRACKET APPLICATIONS

| MAKE / Model | Year | Comments | Type | Notes | Order | Kit# | Cost | Time* | |
|-------------------------------|-------|--|------|-------|-------|-------|------|-------|--|
| SATURN (... continued) | | | | | | | | | |
| VUE | 08-10 | Fits all. No Brushguard. | XL | 1 | | 30735 | A | B | |
| VUE GREEN LINE HYBRID | 07 | No brushguard. | XL | 49 | | 30440 | A | B | |
| VUE GREEN LINE | 08-10 | No brushguard. | XL | 1 | | 30735 | A | B | |
| VUE REDLINE | 08-09 | Trimming of front fascia required. See instructions. | XL | 1 | | 30735 | A | B | |
| SCION | | | | | | | | | |
| XD | 08-12 | #521181-5 | EZ | 1,3 | | 31227 | A | D | |
| SMART | | | | | | | | | |
| SMART FORTWO | 08-13 | Fits all. | EZ2 | 1 | | 31442 | A | E | |
| SUZUKI | | | | | | | | | |
| VITARA | 99-04 | All. | XL | | | 38760 | A | C | |
| TOYOTA | | | | | | | | | |
| COROLLA | 03-08 | Fits CE, LE, S & SRX. | XL | 1 | | 39883 | A | C | |
| PICK-UP TACOMA | 05-13 | 2wd, 4wd & PreRunner. No X-Runner. | XL | | | 30432 | A | A | |
| SCION XD | 08-12 | #521181-5 | EZ | 1,3 | | 31227 | A | D | |
| YARIS | 06-08 | Fits Canadian 3 & 4 door CE & RS hatchback models. No Australian models. | EZ | 1 | | 31226 | A | D | |
| YARIS | 07-12 | Fits sedan and hatchback models. No Australian models. | EZ | 1 | | 31227 | A | D | |
| YARIS | 07-11 | Fits all 3 door hatchback U.S. models. No Australian models. | EZ | 1 | | 31226 | A | D | |

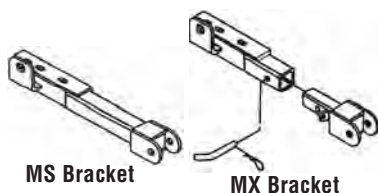

MS Bracket

MX Bracket

Tow bar rating must exceed actual weight of towed vehicle fully loaded.

MX and **MS** brackets are only for use with motorhome mounted tow bars. They eliminate the need for the included QD crossbar. The MX and MS brackets will not work with a car mounted tow bar like the STOWMASTER, nor will they work with the Easy Hook Safety Cables, Guardian or any accessory that requires a Roadmaster QD crossbar.

ROADMASTER FOOTNOTES:

- Trimming of spoiler, air dam or plastic fascia may be required on some models of this vehicle.
- Trimming the lower air dam, air deflector, cowl and/or rock guard is required on this model.
- A) Most Renegades & Wranglers** utilize a steel bumper that is shaped like a "U". The steel bumper has a flat top & face, which the **38208** (1409-3) or **38207** (1409-1) brackets bolt to. However, some versions incorporate bumpers without a flat face & top which prevent the use of these brackets.
- B) '98 Jeep Wrangler** uses **38531** (1417-1), if the front bumper has bumperettes.
- Add 1.5 hours if vehicle has tow hooks. Hooks & brackets must be removed in order for brackets to fit.
- On the 91-96 Jeep Cherokees**, the plastic under the bumper must be trimmed & a small bumper strap needs to be cut. All **38417** (1418-1) made before 9/8/97 WILL NOT FIT Cherokees with tow hooks.
- Some vehicles will require Quick-Disconnect brackets for the additional space needed for TRACKER tow bar to fit properly.
- Jeeps with factory fog lights will have to move fog lights 1" out from the stock position to clear mounting hardware.

- This bracket will accommodate any ROADMASTER motorhome mounted tow bar. This bracket is designed for heavier vehicles. Make sure the tow bar you use exceed the weight of the vehicle to be towed when full loaded. Anchor brackets for Sterling cables WILL NOT FIT MX or MS style brackets. To use MX or MS bracket with Sterling tow bar, the Sterling cable anchors must be attached to the frame of the vehicle or welded to the receiver portion of the bracket.
- ON 2002 MODELS ONLY:** need to check for sub-frame mounting bolts. These bolts are located under a splash panel behind the bumper. These bolts hold the engine cradle to the main frame. If these bolts are present, use a 194 series bracket.
- No right hand drive/steering.
- This bracket will not fit with the bumper fasias on the AJ or AK Body Styles.
- On 2006 Acura MDX Models only: Must check tow ability with manufacturer.
- Special tools required – see instructions.
- Please review the supplemental page located in the back of instructions if the vehicle is equipped with the auxiliary pump.
- Will not work with optional Mopar skid plate.



Classic Brackets
Designed for older vehicles.
Economically priced



Towing and Suspension Solutions