

## HUSKY Replacement Brake Assembly Kits

Save time and money by installing Husky Brake Assemblies. Why replace shoes, magnets, springs, adjusters, etc.? If you have to replace two or more of these components, it is easier and more economical to install the complete assembly. With Husky, you get back on the road fast!

### HUSKY REPLACEMENT ELECTRIC BRAKE ASSEMBLY KITS

FOR AXLE TEK, DEXTER, FAYETTE, HAYES & ALKO ELECTRIC BRAKES

Reduce precious time and aggravation on difficult brake repairs by using Husky easy to install complete brake assembly kits. These **CSA certified** kits provide durability, and reliability in braking performance. These kits fit Axle Tek, Dexter, Fayette, and Hayes, with these flange patterns: 3" hole diameter x 4-holes x 4" bolt center on 7" and 10" brakes; 3.25" hole diameter x 5-holes x 3.88" bolt center on 12" brakes. All kits are individually boxed.

Description	EACH		PALLET	
	Part #		Part #	
<b>Electric Brake Assembly, 7" x 1-1/4", 600-2200# Axle Capacity</b>				
LH Complete	30789			
RH Complete	30788			
<b>Electric Brake Assembly, 10" x 2-1/4", 2300 -3500# Axle Capacity</b>				
LH Complete	30793		95116	
RH Complete	30794		95122	
<b>Electric Brake Assembly, 12" x 2", 4000-6000# Axle Capacity</b>				
LH Complete	30799			
RH Complete	30800			
<b>Electric Brake Assembly, 12" x 2" 7000# Axle Capacity</b>				
LH Complete	30797		95123	
RH Complete	30798		95124	

Pallet quantities: 10" x 2-1/4" = 156/pallet; 12" x 2" = 117/pallet.



Brakes manufactured by Axle Teknology for Husky are CSA Certified (CSA master contract #239634)

### HUSKY BRAKE ASSEMBLY KITS REPLACE:

- AXLE TEK
- ALKO
- ATWOOD
- DEXTER
- FAYETTE
- HAYES



### HUSKY REPLACEMENT HYDRAULIC BRAKE ASSEMBLY KITS

FOR AXLE TEK, ATWOOD, ALKO, DEXTER HYDRAULIC BRAKES

Easy installation and interchangeability are just two features that rate Husky Uni-servo hydraulic brake assemblies among the best in the industry. These assemblies interchange with most major brands of axles, without modifying the axle or mounting flange. These assemblies also interchange with Atwood, Axle Tek, and Dexter hydraulic brake assemblies. Hub Pattern: 3" x 4-holes on 10" brakes; 3.25" x 5-holes on 12" brakes. All kits are individually boxed.

Description	Part #
<b>Hydraulic Brake Assembly, 10" x 2.25" 3500# Rated Axle Capacity</b>	
LH Complete, Black Painted	30785
RH Complete, Black Painted	30784
<b>Hydraulic Brake Assembly, 12" x 2", 6000# Rated Axle Capacity</b>	
LH Complete, Black Painted	30786
RH Complete, Black Painted	30787

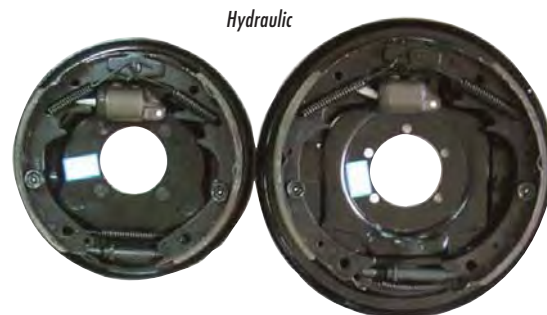

Manufactured for Husky by Axle Teknology.

# HUSKY BRAKE & AXLE PARTS

**TOWING  
& SAFETY**

**N**

In Section N:	Hitches	Hitch Accessories	Car Towing	Levels	Mirrors & Safety	Brake Controls	Towing Electrical	Brake & Wheel	Automotive
---------------	---------	-------------------	------------	--------	------------------	----------------	-------------------	---------------	------------



**REPLACES DEXTER & AXLE TEK**

**CSA Certified**

CSA Certified by Axle Technology  
(CSA master contract #239634)

## HUSKY QUALITY REPLACEMENT PARTS—AXLE TEK, DEXTER 7" x 1-1/4" ELECTRIC BRAKES

Order #	Mfr. #	Dexter #	Ref.	Qty./ Brake	Description
30789	#KB7E-01	K23-026-00		1	COMPLETE BRAKE ASSEMBLY LH
30788	#KB7E-02	K23-027-00		1	COMPLETE BRAKE ASSEMBLY RH
30816	#KB7E-05	K71-045-00	5 & 16	1	SHOE / LINING KIT
30827	#KBE-323-00	K71-323-00	14 & 15	1	ADJUSTING SCREW KIT
30817	#KB7E-06	K71-057-00	8, 11, & 12	1	MAGNET KIT
30824	#KBE-363-00	K71-363-00	3,6,11,& 15	1	SPRING KIT
30830	#KBE-321-00	5121	13	1	RETAINER CLIP PKG./10

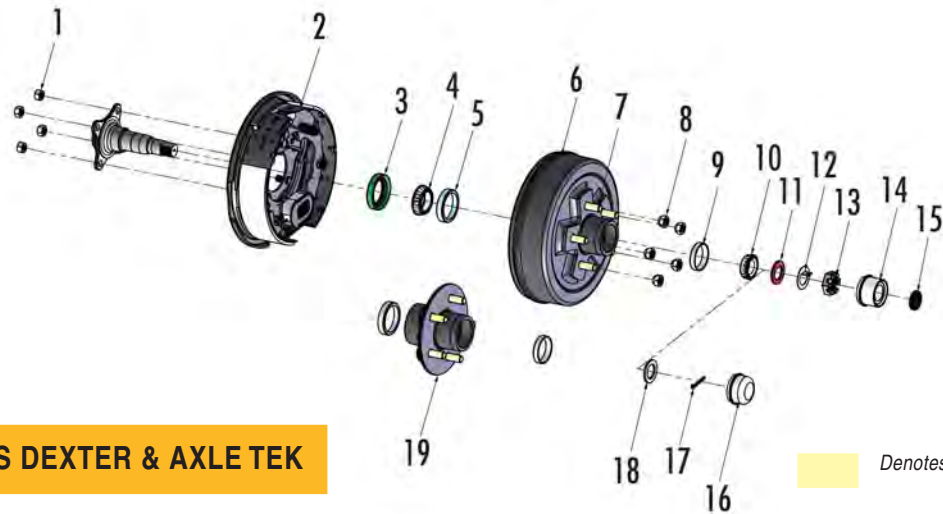

**REPLACES DEXTER & AXLE TEK**

Denotes Limited Supply

## HUSKY QUALITY REPLACEMENT PARTS—AXLE TEK, DEXTER 7" x 1-1/4" & 7" x 1-3/4" HUBS-DRUMS AND IDLER HUBS, ELEC/HYD

Order #	Mfr. #	Dexter #	Ref.	Qty./ Brake	Description
95912	#DL150-20		3		GREASE SEALS, 1-1/2" ID, SLEEVE OF 20
95904	#L-44649-10		4		BEARINGS L44649, SLEEVE OF 10
30812	#L44649/10	K71-306-00	4 & 5	1	BEARING CONE & CUP L44610 / L44649
30812	#L44649/10	K71-306-00	9 & 10	1	BEARING CONE & CUP L44610 / L44649
31502	#DC-200	K71-314-00	16	1	2" DUST CAP
30790	#H-440S2-07	008-091-05	19	1	IDLER HUB 4-4.40" BC STUDS
30792	#KBD-54522-17	008-257-05	6	1	HUB-DRUM 5.45" BC ELEC. 1-1/4"
30791	#H-150S2-07	008-258-05	19	1	IDLER HUB 5-4.50" BC

Manufactured for Husky by Axle Technology.

**HUSKY BRAKE & AXLE PARTS**

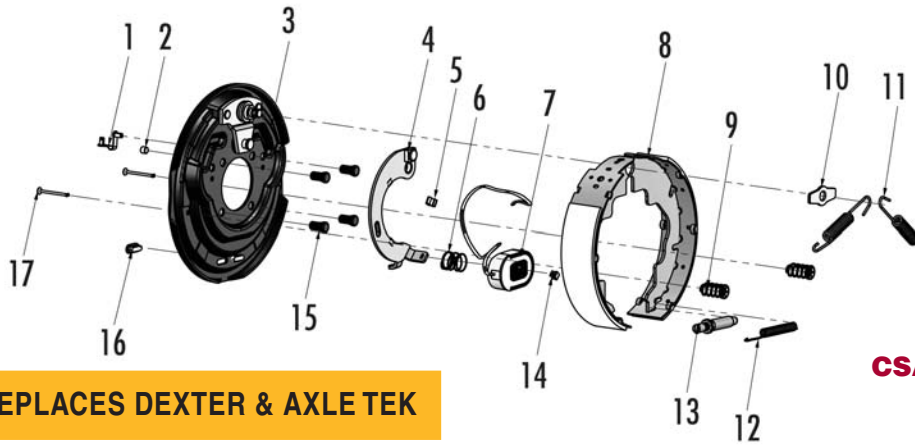

**REPLACES DEXTER & AXLE TEK**

**CSA Certified**

*CSA Certified by Axle Tekology  
(CSA master contract #239634)*

**HUSKY QUALITY REPLACEMENT PARTS—AXLE TEK, DEXTER  
10" x 2-1/4" ELECTRIC BRAKES**

Order #	Mfr. #	Dexter #	Ref.	Qty./Brake	Description
30793	#KB10E-01	K23-026-00		1	COMPLETE BRAKE ASSEMBLY LH
30794	#KB10E-02	K23-027-00		1	COMPLETE BRAKE ASSEMBLY RH
30821	#KB10E-05	K71-047-00	8, 9 & 17	1	SHOE / LINING KIT
30826	#KBE-324-00	K71-324-00	12 & 13	1	ADJUSTING SCREW KIT
30818	#KB10E-06	K71-104-00	5, 6, & 7	1	MAGNET KIT
30824	#KBE-363-00	K71-363-00	6,9,11, & 12	1	SPRING KIT
30825	#KBE-353-00	5353	9 & 17	1	HOLD-DOWN KIT (AXLE SET)
30830	#KBE-321-00	5121	14	1	RETAINER CLIP PKG./10

**DEXTER: 10" X 1-1/2" HUB-DRUM (OBSOLETE) USE 10" X 2-1/4" PICTURE**

31502	#DC-200	K71-314-00	16	1	2" DUST CAP
-------	---------	------------	----	---	-------------

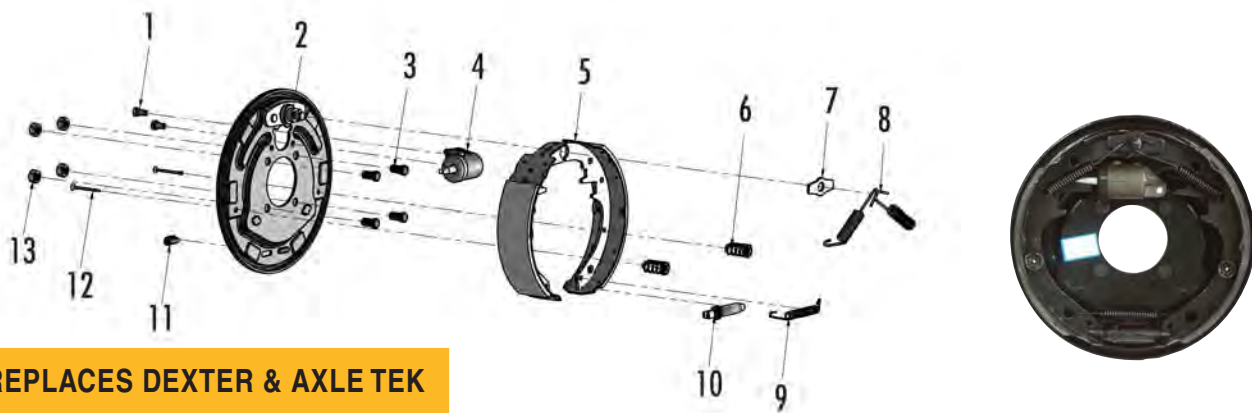

**REPLACES DEXTER & AXLE TEK**

**HUSKY QUALITY REPLACEMENT PARTS—AXLE TEK, DEXTER  
10" x 2-1/4" HYDRAULIC BRAKES**

Order #	Mfr. #	Dexter #	Ref.	Qty./Brake	Description
30785	#KB10H-01	K23-312-00		1	COMPLETE BRAKE ASSEMBLY LH UNI-SERVO
30784	#KB10H-02	K23-313-00		1	COMPLETE BRAKE ASSEMBLY RH UNI-SERVO
30822	#KB10H-05-2	K71-267-00	5 & 6	1	SHOE / LINING KIT (AXLE SET)

*Manufactured for Husky by Axle Tekology.*

# HUSKY BRAKE & AXLE PARTS

**TOWING  
& SAFETY**

**N**

In Section N:	Hitches	Hitch Accessories	Car Towing	Levels	Mirrors & Safety	Brake Controls	Towing Electrical	Brake & Wheel	Automotive
---------------	---------	-------------------	------------	--------	------------------	----------------	-------------------	---------------	------------

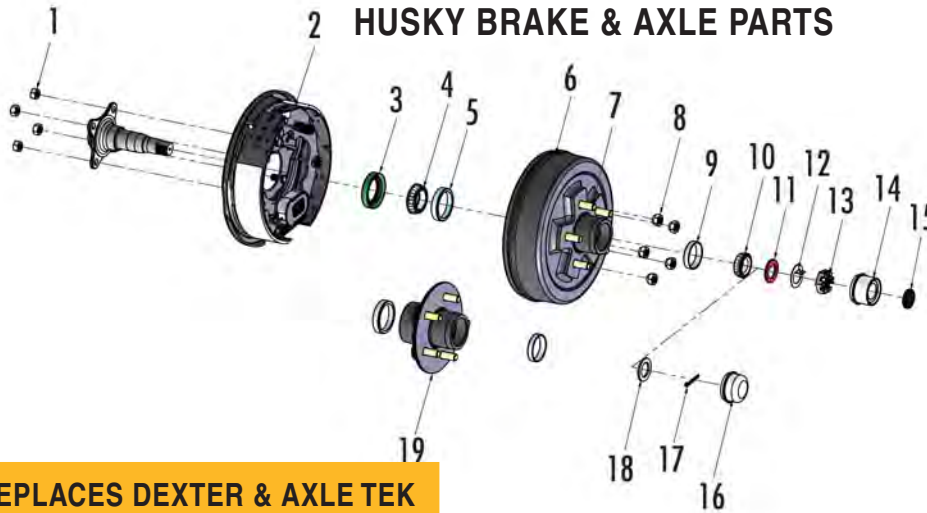

**REPLACES DEXTER & AXLE TEK**

*Denotes Limited Supply*

## HUSKY QUALITY REPLACEMENT PARTS—AXLE TEK, DEXTER 10" X 2-1/4" HUBS-DRUMS AND IDLER HUBS

Order #	Mfr. #	Dexter #	Ref.	Qty./ Brake	Description
<b>30828</b>	#DL-172-03	K71-303-00	3	1	GREASE SEAL STD. PKG/2
<b>95913</b>	#DL172-10		3		GREASE SEALS., 1-7/8" ID, SLEEVE OF 10
<b>30815</b>	#LM68149/11	K71-390-00	4 & 5	1	INNER BEARING CONE & CUP L6811 / L68149
<b>95906</b>	#L-68149-09		4		BEARINGS L68149, SLEEVE OF 9
<b>30812</b>	#L44649/10	K71-306-00	9 & 10	1	OUTER BEARING CONE & CUPL44610 / L44649
<b>95904</b>	#L-44649-10		10		BEARINGS L44649, SLEEVE OF 10
<b>31502</b>	#DC-200	K71-314-00	16	1	2" DUST CAP
<b>30795</b>	#H-545S2-07	008-219-04	19	1	IDLER HUB 5-4.50" BC
<b>30796</b>	#KBD-545-17	008-247-05	6	1	HUB-DRUM 5-4.50" BC ELEC/HYD
<b>31503</b>	#DC-200L		14	1	2" LUBED DUST CAP
<b>31510</b>	#DC-RP	K71-320-00	15	1	RUBBER LUBE PLUG FOR 1.18" CAP HOLE
<b>31815</b>	#CD-RP-2	K71-320-00	16	1	RUBBER LUBE PLUG FOR 1.18" CAP HOLE, PK/2

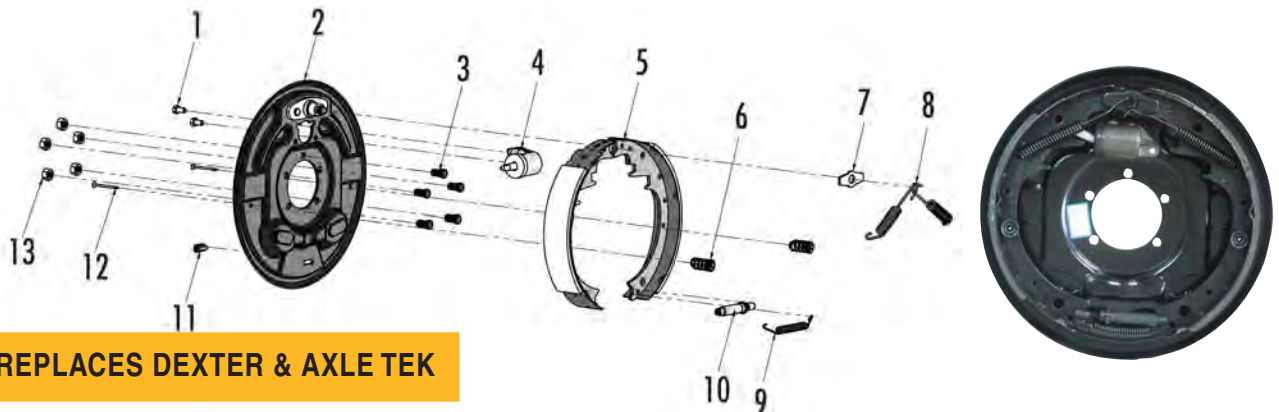

**REPLACES DEXTER & AXLE TEK**

## HUSKY QUALITY REPLACEMENT PARTS—AXLE TEK, DEXTER 12" x 2" HYDRAULIC BRAKES 7000#

Order #	Mfr. #	Dexter #	Ref.	Qty./ Brake	Description
<b>30786</b>	#KB12H-01	K23-338-00		1	COMPLETE BRAKE ASSEMBLY LH UNI-SERVO
<b>30787</b>	#KB12H-02	K23-339-00		1	COMPLETE BRAKE ASSEMBLY RH UNI-SERVO
<b>30823</b>	#KB12H-05-2	K71-269-00 & K71-270-00	5 & 6	1	SHOE / LINING KIT (AXLE SET)

*Manufactured for Husky by Axle Technology.*

**HUSKY BRAKE & AXLE PARTS**

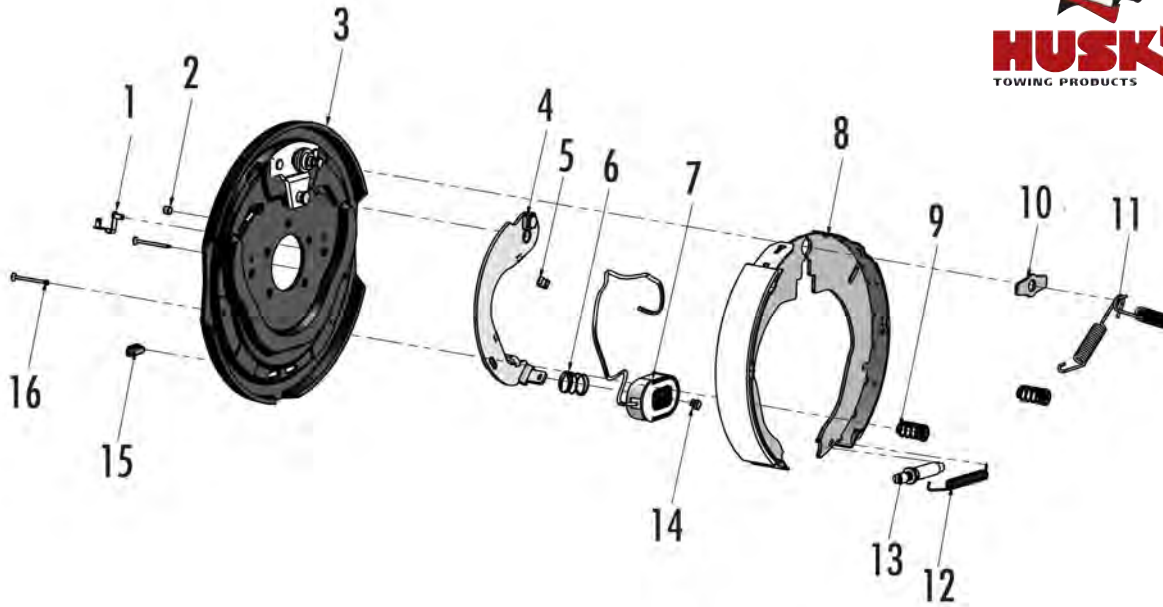

**REPLACES DEXTER & AXLE TEK**

**CSA Certified**

CSA Certified by Axle Technology  
(CSA master contract #239634)

**HUSKY QUALITY REPLACEMENT PARTS — AXLE TEK, DEXTER  
12" x 2" ELECTRIC BRAKES 5200#, 6000#, 7000#**

Order #	Mfr. #	Dexter #	Ref.	Qty./ Brake	Description
<b>5200# &amp; 6000#</b>					
30799	#KB12E-03	K23-105-00		1	COMPLETE BRAKE ASSEMBLY LH
30800	#KB12E-04	K23-106-00		1	COMPLETE BRAKE ASSEMBLY RH
30820	#KB12E-05	K71-048-00	8, 9 & 16	1	SHOE / LINING KIT
30826	#KBE-324-00	K71-324-00	12 & 13	1	ADJUSTING SCREW KIT
30819	#KB12E-06	K71-105-00	5, 6, & 7	1	MAGNET KIT
30824	#KBE-363-00	K71-363-00	6,9,11, & 12	1	SPRING KIT
30825	#KBE-353-00	5353	9 & 16	1	HOLD-DOWN KIT (AXLE SET)
30830	#KBE-321-00	5121	14	1	RETAINER CLIP PKG./10
<b>7000#</b>					
30797	#KB12E-01	K23-180-00		1	COMPLETE BRAKE ASSEMBLY LH
30798	#KB12E-02	K23-181-00		1	COMPLETE BRAKE ASSEMBLY RH
30820	#KB12E-05	K71-127-00	8, 9 & 16	1	SHOE / LINING KIT
30826	#KBE-324-00	K71-324-00	12 & 13	1	ADJUSTING SCREW KIT
30819	#KB12E-06	K71-125-00	5,6,&7	1	MAGNET KIT
30824	#KBE-363-00	K71-363-00	6,9,11,&12	1	SPRING KIT
30825	#KBE-353-00	5353	9 & 16	1	HOLD-DOWN KIT (AXLE SET)
30830	#KBE-321-00	5121	14	1	RETAINER CLIP PKG./10

*Manufactured for Husky by Axle Technology.*

# HUSKY BRAKE & AXLE PARTS

TOWING  
& SAFETY

N

In Section N:	Hitches	Hitch Accessories	Car Towing	Levels	Mirrors & Safety	Brake Controls	Towing Electrical	Brake & Wheel	Automotive
---------------	---------	-------------------	------------	--------	------------------	----------------	-------------------	---------------	------------



**REPLACES DEXTER & AXLE TEK**

## HUSKY QUALITY REPLACEMENT PARTS—AXLE TEK, DEXTER 12" x 2" HUBS-DRUMS AND IDLER HUBS, 8 ON 6.50 BC 6000# & 7000#

Order #	Mfr. #	Dexter #	Ref.	Qty./Brake	Description
30829	#DL-225-03	K71-305-00	4	1	GREASE SEAL STD. PKG/2
30813	#25580/20	K71-308-00	5 & 6	1	INNER BEARING CONE & CUP 25520 / 25580
95907	#25580-06		6		BEARINGS 25580, SLEEVE OF 6
30811	#15123/245	K71-309-00	10 & 11	1	OUTER BEARING CONE & CUP 15245 / 15123 6000# (5-SPOKE DEMOUNTABLE)
95908	#15123-08		11		BEARINGS 15123, SLEEVE OF 8
30808	#14125A/14276	K71-310-00	10 & 11	1	OUTER BEARING CONE & CUP 14276 / 14125A 7000# 8-BOLT
95909	#14125A-08		11		BEARINGS 14125A, SLEEVE OF 8
30802	#KBD-865-17	008-219-04	7	1	HUB-DRUM 8-6.50" BC 1/2" STUDS 7000#
30806	#KBD-865-16	008-219-13	7	1	HUB-DRUM 8-6.50" BC 1/2" STUDS 6000#
30803	#KBD-174-06	008-174-05	7A	1	HUB-DRUM DEMOUNTABLE 5-BOLT 9/16" STUDS
31505	#DC-250L		15	1	2-1/2" LUBED DUST CAP
31510	#DC-RP	K71-320-00	16		RUBBER LUBE PLUG FOR 1.18" CAP HOLE
31815	#DC-RP-2	K71-320-00	16		RUBBER LUBE PLUG FOR 1.18" CAP HOLE, 2/PK

Manufactured for Husky  
by Axle Technology.

Denotes Limited Supply

**REPLACES DEXTER & AXLE TEK**

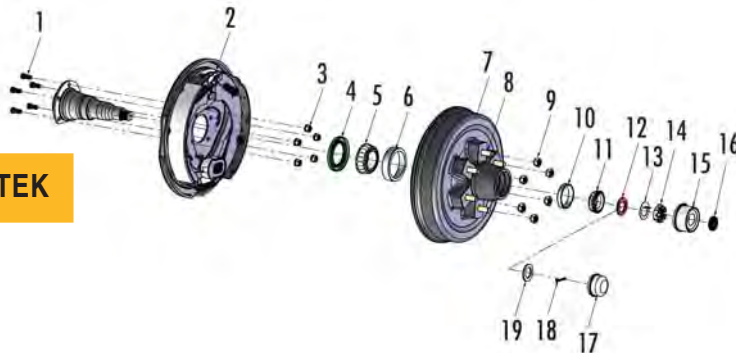

## AXLE TEK, DEXTER 12" x 2" HUBS-DRUMS AND IDLER HUBS, 6 ON 5.50 BC 5200# & 6000#

Order #	Mfr. #	Dexter #	Ref.	Qty./Brake	Description
30829	#DL-225-03	K71-305-00	4	1	GREASE SEAL STD., 2.25" I.D. (1998-current) PKG/2
95914	#DL225-10		4		GREASE SEALS DL225, 2.25" I.D. (1998-current) SLEEVE OF 10
31816	#DL-2125-2		4	1	GREASE SEAL DL2125, 2.125" I.D. (pre-1998) PKG/2
95922	#DL2125-10		4		GREASE SEALS DL2125, 2.125" I.D. (pre-1998) SLEEVE OF 10
30813	#25580/20	K71-308-00	5 & 6	1	INNER BEARING CONE & CUP 25520 / 25580
95907	#25580-06		5		BEARINGS 25580, SLEEVE OF 6
30814	#LM67048/10	K71-307-00	10 & 11	1	OUTER BEARING CONE & CUP LM67048 / LM67010 5200#
95905	#LM-67048		11		BEARINGS LM67048, SLEEVE OF 9
30811	#15123/245	K71-309-00	10 & 11	1	OUTER BEARING CONE & CUP 15123 / 15245 6000#
95908	#15123-08		11		BEARINGS 15123, SLEEVE OF 8
31504	#DC-250	K71-316-00	17	1	2-1/2" DUST CAP
30801	#KBD-655-16	008-201-02	7	1	HUB-DRUM 6-5.50" BC 1/2" STUDS 5200# LS
30804	#KBD-655-17	008-201-09	7	1	HUB-DRUM 6-5.50" BC 1/2" STUDS 6000# (requires #30811 bearing if used on 5200# axle)
31505	#DC-250L		15	1	2-1/2" LUBED DUST CAP
31510	#DC-RP	K71-320-00	16		RUBBER LUBE PLUG FOR 1.18" CAP HOLE
31815	#DC-RP-2	K71-320-00	16		RUBBER LUBE PLUG FOR 1.18" CAP HOLE, 2/PK

**HUSKY BRAKE & AXLE PARTS**

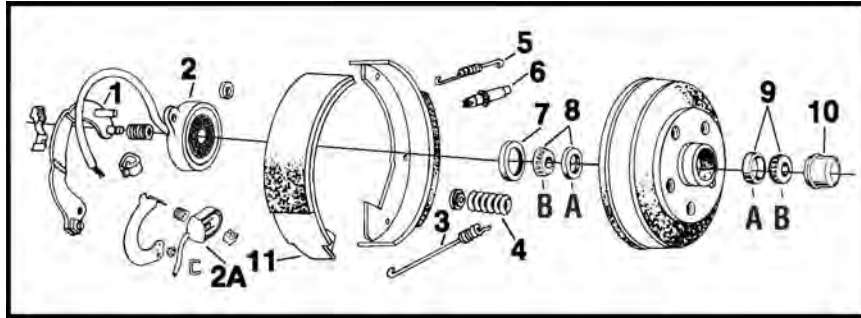

**REPLACES HAYES**

Denotes Limited Supply

**HUSKY QUALITY REPLACEMENT PARTS — HAYES**  
**10" x 1-5/8"**

Order #	Mfr. #	Ref.	Description
30818	#KB10E-06	2A	MAGNET KIT (AFTER MID 1987)
30826	#KBE-324-00	5 & 6	ADJUSTING SCREW KIT
30828	#DL-172-03	7	GREASE SEAL (AXLE SET)
95913	#DL172-10	7	GREASE SEALS DL172, SLEEVE OF 10
30814	#LM67048/10	8A+B	INNER BEARING SET
95905	#LM-67048	8B	BEARING ONLY LM-67048, SLEEVE OF 9
30812	#L44649/10	9A+B	OUTER BEARING SET
95904	#L-44649-10	9B	BEARING ONLY L-44649, SLEEVE OF 10
31502	#DC-200	10	2" DUST CAP

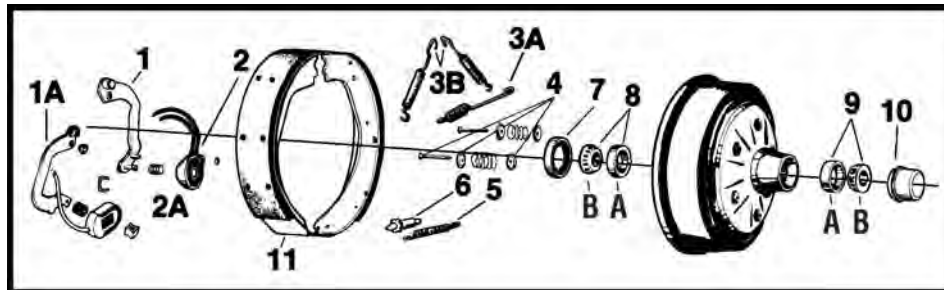

**REPLACES HAYES**

**HUSKY QUALITY REPLACEMENT PARTS — HAYES**  
**10" x 2-1/4"**

Order #	Mfr. #	Ref.	Description
30818	#KB10E-06	2A	MAGNET KIT (AFTER MID 1987)
30824	#KBE-363-00	3A & 3B	SPRING KIT
30825	#KBE-353-00	4	HOLD-DOWN KIT (AXLE SET)
30826	#KBE-324-00	5 & 6	ADJUSTING SCREW KIT
30828	#DL-172-03	7	GREASE SEAL (AXLE SET)
95913	#DL172-10	7	GREASE SEALS DL172, SLEEVE OF 10
30815	#LM68149/11	8A+B	INNER BEARING SET
95906	#L-68149-09	8B	BEARING ONLY 68149, SLEEVE OF 9
30812	#L44649/10	9A+B	OUTER BEARING SET
95904	#L-44649-10	9B	BEARING ONLY L-44649, SLEEVE OF 10
31502	#DC-200	10	2" DUST CAP

# HUSKY BRAKE & AXLE PARTS

**TOWING  
& SAFETY**

**N**

In Section N:	Hitches	Hitch Accessories	Car Towing	Levels	Mirrors & Safety	Brake Controls	Towing Electrical	Brake & Wheel	Automotive
---------------	---------	-------------------	------------	--------	------------------	----------------	-------------------	---------------	------------

## HUSKY BRAKE & AXLE PARTS

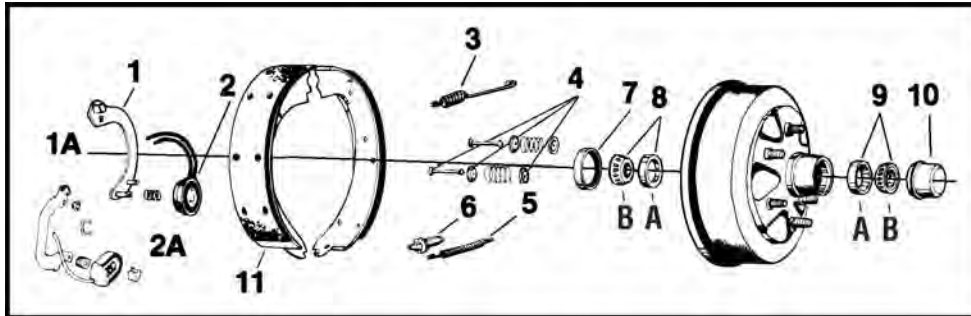

**REPLACES  
HAYES**

*Denotes Limited Supply*

### HUSKY QUALITY REPLACEMENT PARTS — HAYES 12" x 2"

Order #	Mfr. #	Ref.	Description
30819	#KB12E-06	2A	MAGNET KIT (AFTER MID 1987)
30824	#KBE-363-00	3	SPRING KIT
30825	#KBE-353-00	4	HOLD-DOWN KIT (AXLE SET)
30826	#KBE-324-00	5 & 6	ADJUSTING SCREW KIT
30829	#DL-225-03	7	GREASE SEAL (AXLE SET)
95914	#DL225-10	7	GREASE SEALS DL225, SLEEVE OF 10
30813	#25580/20	8A+B	INNER BEARING SET
95907	#25580-06	8B	BEARING ONLY 25580, SLEEVE OF 6
30814	#LM67048/10	9A+B	OUTER BEARING SET
95905	#LM-67048	9B	BEARING ONLY LM-67048, SLEEVE OF 9
31504	#DC-250	10	2-1/2" DUST CAP

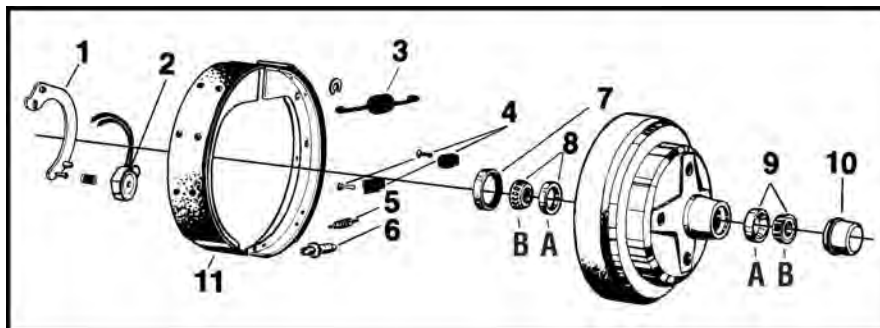

**REPLACES  
HAYES**

### HUSKY QUALITY REPLACEMENT PARTS — HAYES 12" x 2" CENTERLINE

Order #	Mfr. #	Ref.	Description
30825	#KBE-353-00	4	HOLD-DOWN KIT (AXLE SET)
30826	#KBE-324-00	5 & 6	ADJUSTING SCREW KIT
30829	#DL-225-03	7	GREASE SEAL (AXLE SET) 2.25" I.D.
95914	#DL225-10	7	GREASE SEALS DL225, 2.25" I.D., SLEEVE OF 10
31816	#DL-2125-2	7	GREASE SEAL (AXLE SET) 2.125" I.D.
95922	#DL-2125-10	7	GREASE SEALS DL2125, 2.125" I.D., SLEEVE OF 10
30813	#25580/20	8A+B	INNER BEARING SET
95907	#25580-06	8B	BEARING ONLY 25580, SLEEVE OF 6
30814	#LM67048/10	9A+B	OUTER BEARING SET
95905	#LM-67048	9B	BEARING ONLY LM-67048, SLEEVE OF 9
31504	#DC-250	10	2-1/2" DUST CAP



## HUSKY BRAKE &amp; AXLE PARTS

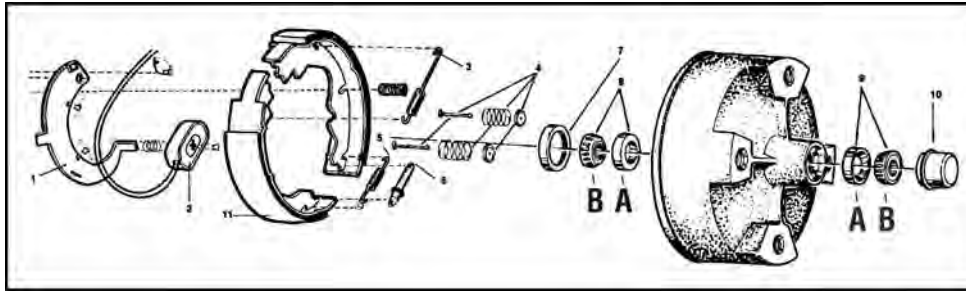

REPLACES AL-KO

Denotes Limited Supply

### HUSKY QUALITY REPLACEMENT PARTS — AL-KO

#### 10" x 2-1/4"

Order #	Mfr. #	Ref.	Description
30818	#KB10E-06	2	MAGNET KIT
30825	#KBE-353-00	4	HOLD-DOWN KIT (AXLE SET)
30826	#KBE-324-00	5 & 6	ADJUSTING SCREW KIT
30815	#LM68149/11	8A+B	INNER BEARING SET
95906	#L-68149-09	8B	BEARING ONLY 68149, SLEEVE OF 9
30812	#L44649/10	9A+B	OUTER BEARING SET
95904	#L-44649-10	9B	BEARING ONLY L-44649, SLEEVE OF 10
31502	#DC-200	10	2" DUST CAP

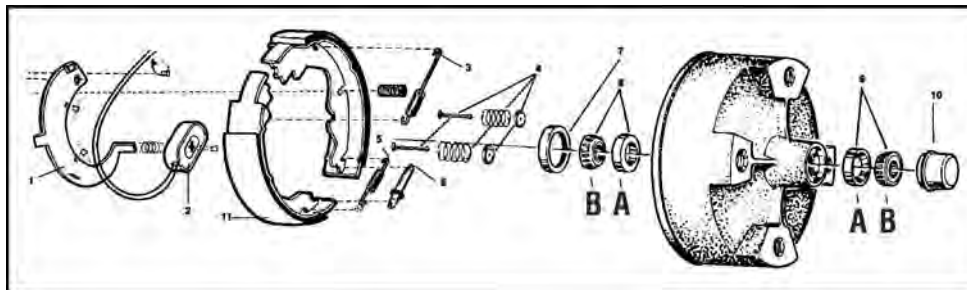

REPLACES AL-KO

### HUSKY QUALITY REPLACEMENT PARTS — AL-KO

#### 12" x 2"

Order #	Mfr. #	Ref.	Description
30819	#KB12E-06	2	MAGNET KIT 6 & 7K
30824	#KBE-363-00	3	SPRING KIT
30825	#KBE-353-00	4	HOLD-DOWN KIT (AXLE SET)
30826	#KBE-324-00	5 & 6	ADJUSTING SCREW KIT
30813	#25580/20	8A+B	INNER BEARING SET
95907	#25580-06	8B	BEARING ONLY 25580, SLEEVE OF 6
30814	#LM67048/10	9A+B	OUTER BEARING SET
95905	#LM-67048	9B	BEARING ONLY LM-67048, SLEEVE OF 9
31504	#DC-250	10	2-1/2" DUST CAP

# HUSKY BRAKE & AXLE PARTS

TOWING  
& SAFETY

N

In Section N:	Hitches	Hitch Accessories	Car Towing	Levels	Mirrors & Safety	Brake Controls	Towing Electrical	Brake & Wheel	Automotive
---------------	---------	-------------------	------------	--------	------------------	----------------	-------------------	---------------	------------

## HUSKY BRAKE & AXLE PARTS

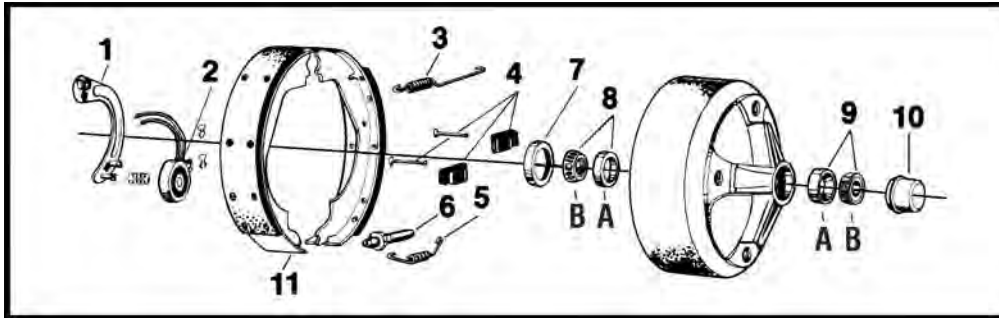

REPLACES  
FAYETTE

Denotes Limited Supply

### HUSKY QUALITY REPLACEMENT PARTS — FAYETTE 10" x 2-1/4"

Order #	Mfr. #	Ref.	Description
30825	#KBE-353-00	4	HOLD-DOWN KIT (AXLE SET)
30826	#KBE-324-00	5 & 6	ADJUSTING SCREW KIT
30828	#DL-172-03	7	GREASE SEALS (AXLE SET)
95913	#DL172-10	7	GREASE SEALS DL172, SLEEVE OF 10
30815	#LM68149/11	8A+B	INNER BEARING SET
95906	#L-68149-09	8B	BEARING ONLY 68149, SLEEVE OF 9
30812	#L44649/10	9A+B	OUTER BEARING SET
95904	#L-44649-10	9B	BEARING ONLY L-44649, SLEEVE OF 10
31502	#DC-200	10	2" DUSTCAP
30821	#KB10E-05	11	SHOE / LINING KIT

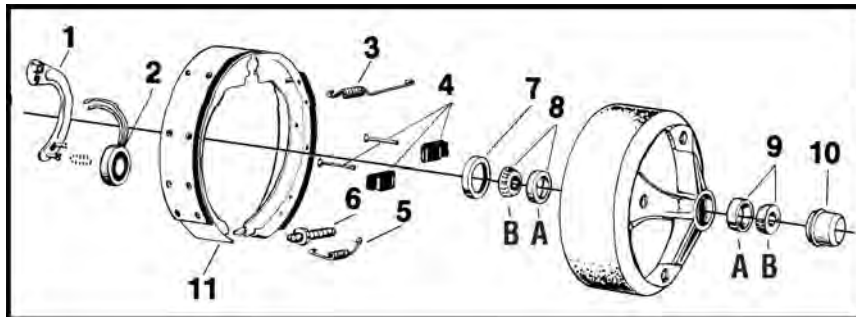

REPLACES  
FAYETTE

### HUSKY QUALITY REPLACEMENT PARTS — FAYETTE 12" x 2"

Order #	Mfr. #	Ref.	Description
30824	#KBE-363-00	3	SPRING KIT
30825	#KBE-353-00	4	HOLD-DOWN KIT (AXLE SET)
30826	#KBE-324-00	5 & 6	ADJUSTING SCREW KIT
30829	#DL-225-03	7	GREASE SEAL (AXLE SET) 2.25" I.D.
95914	#DL225-10	7	GREASE SEALS DL225, 2.25" I.D., SLEEVE OF 10
31816	#DL-2125-2	7	GREASE SEAL (AXLE SET) 2.125" I.D.
95922	#DL-2125-10	7	GREASE SEALS DL2125, 2.125" I.D., SLEEVE OF 10
30813	#25580/20	8A+B	INNER BEARING SET
95907	#25580-06	8B	BEARING ONLY 25580, SLEEVE OF 6
30814	#LM67048/10	9A+B	OUTER BEARING SET
95905	#LM-67048	9B	BEARING ONLY LM-67048, SLEEVE OF 9
31504	#DC-250	10	2-1/2" DUST CAP
30820	#KB12E-05	11	SHOE / LINING KIT

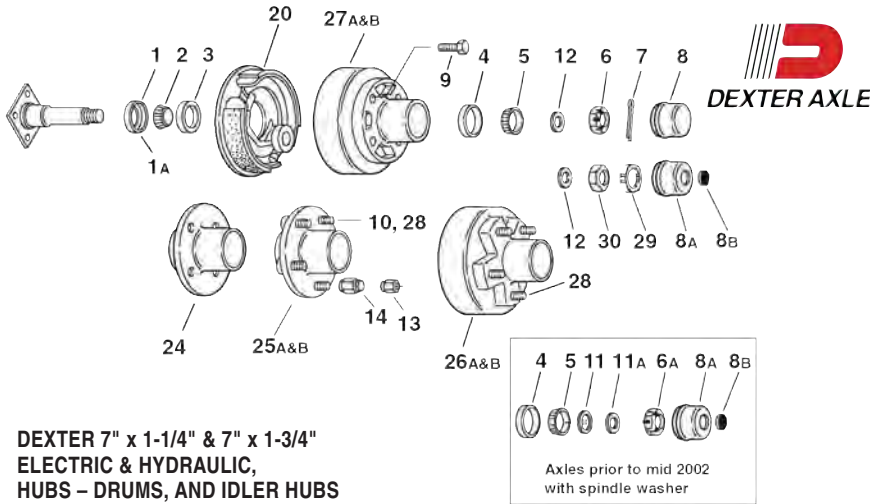

**DEXTER 7" x 1-1/4" & 7" x 1-3/4" ELECTRIC & HYDRAULIC, HUBS – DRUMS, AND IDLER HUBS**

Order #	Mfr. Part#	Ref.	Qty Per Brake	Description
<b>34231</b>	LS 008-091-05	n/s	1	Idler Hub 4.40" BC Studs
Bearings, Seals, Grease Caps				
<b>34314</b>	K71-301-00	1 & 1A	1	Grease Seal Std & E-Z Lube
Axles With E-Z Lube Prior to 2002 That Use Tang Washers, Use Kit (K71-622-00)				
<b>34232</b>	LS 008-258-05	25B	1	Idler Hub 5 - 4.50" BC

**DEXTER AXLE SAMPLE ILLUSTRATION 10" X 2 1/4" BRAKE SHOWN (545 "H" HUB GROUP)**

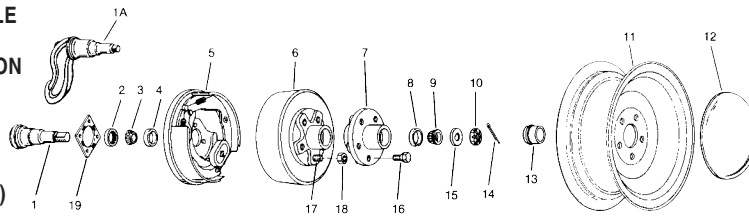

Hub Group		BTR	494 "H"	545 "H"	494 "A"	655
Size		7"	10" x 2 1/4"	10" x 2 1/4"	12" x 2"	12" x 2"
Maximum Capacity (lbs.)		2000	3500	3500	5200	5200
Order #	Mfr. #	Description	Ref			
<b>31502</b>	#DC-200	2" Dust Cap	13	●	●	●
<b>31474</b>	#007-040-00	Wheel Bolt	16	●	●	●

**DEXTER 12" x 2" ELECTRIC BRAKES 5200# CSA**

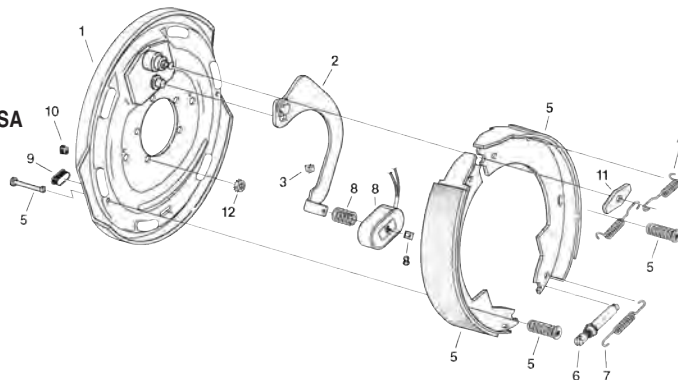

Order #	Mfr. Part#	Ref.	Qty Per Brake	Description
<b>32505</b>	K71-105-00	8	1	Magnet Assy, Spring & Retainer
<b>Dexter 12" x 2" Electric Brakes 6000# CSA Use 12" x 2" Brake Picture Above to Identify Parts</b>				
<b>32505</b>	K71-105-00	8	1	Magnet Assy, Spring & Retainer



**TIE DOWN ENGINEERING DRUM BRAKES**



- Aluminum Wheel Cylinder • Stainless Steel Springs • Brake Pads Are Bonded And Riveted With Bronze Rivets to Backing Plate • Superior Saltwater Performance Over Standard Drum Brakes • Free Backing

The **MOST** Corrosion-resistant drum brake **PERIOD!** The Galv-X system is composed of inorganic polymers which bonds metallic zinc flakes to the metal surface.

**56901** <sup>LS</sup> 10" Galv-X Drum Brake Assembly L & R #81097 1

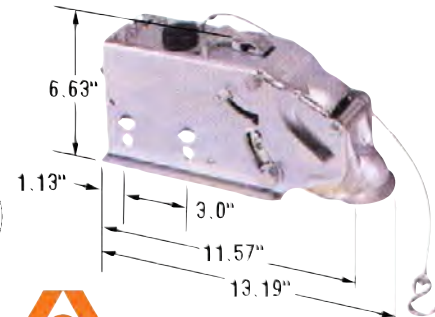

**ATWOOD SURGE BRAKE ACTUATORS**

The Atwood Brake System adds safety and convenience to trailer towing with benefits such as "in-car" hook-up, no hand controls or special car-to-trailer wiring. Recent improvements to increase volume and pressure, increased strength and flow control orifice which assures smoother operation. For a 2" ball, 6,000 lb. rated capacity, 900 lb. maximum tongue load. Class SAE IV.

Surge Brake Actuator, For 2" Ball:

**30697** Painted #82543 1

Surge Brake Actuator, Zinc Plated:

**70346** Zinc-Plated #84132 1

Replacement Kits:

**30241** <sup>LS Elkhart only</sup> Master Cylinder Rebuild Kit/Disc Brakes #85840 1

**34384** Master Cylinder Kit #85841 1

**79281** Cap Only #87478 1

In Section N:	Hitches	Hitch Accessories	Car Towing	Levels	Mirrors & Safety	Brake Controls	Towing Electrical	Brake & Wheel	Automotive
---------------	---------	-------------------	------------	--------	------------------	----------------	-------------------	---------------	------------

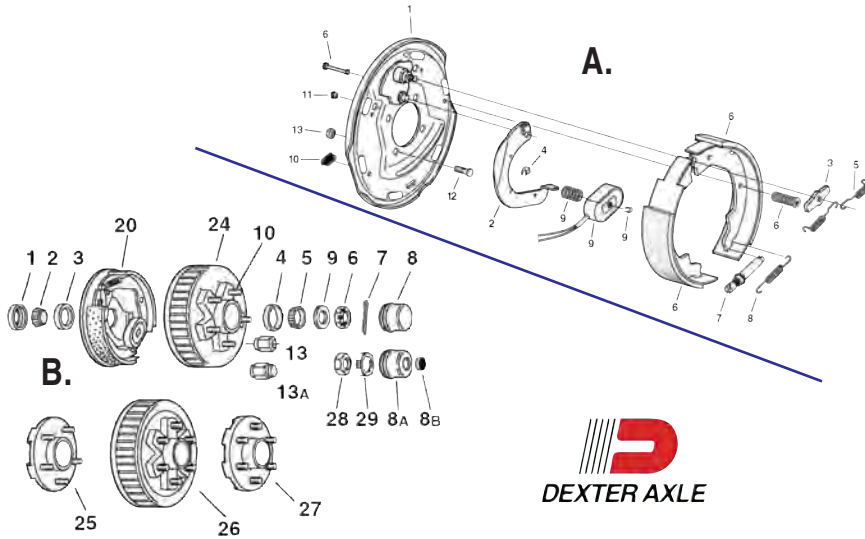

Order #	Mfr. Part#	Ref.	Qty Per Brake	Description
<b>A. DEXTER 10" x 2-1/4" ELECTRIC BRAKES</b>				
<b>32503</b>	K71-104-00	9	1	Magnet Assembly
<b>B. DEXTER 10" x 2-1/4" HUBS - DRUMS, AND IDLER HUBS</b>				
Seals, Bearings, Cups, Wheel Nuts, Grease Caps, and Spindle nuts				
<b>34307</b> LS	K71-300-00	13A	5 or 6	1/2-20, 60 Deg Capped Nut (6/Pk)
Axles Prior to Mid-2002				
<b>32162</b>	K71-322-00	9	1	D-Spindle Washer
<b>Dexter 10" x 1-1/2" Electric Brakes - Obsolete. Use Picture B, 10" x 2-1/4"</b>				
<b>32531</b> LS	K71-307-00	2	1	Inner Brg-Cup L67010/LM67048
<b>32162</b>	K71-322-00	9	1	D-Spindle Washer

**DEXTER 10" x 1-1/2" ELECTRIC BRAKES - OBSOLETE ONLY SERVICE PARTS**  
Use Sample Picture of 10" x 2-1/4" shown here to identify parts

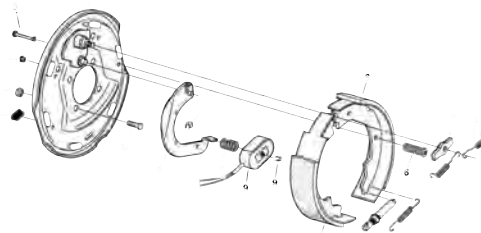

Order #	Mfr. Part#	Ref.	Qty Per Brake	Description
<b>34364</b> LS	K71-177-00	9	1	Magnet Assembly, 1-1/2" New



### TIE DOWN ENGINEERING HUB KITS

Factory pre-greased replacement wheel hub kit. Bearings and hub cavity 100% pre-greased. Grease seal and bearings are pre-assembled.

- 748030** 4-Stud Hub Kit (1250#), 1" x 1", with Lug Nuts #81060 4
- 748031** 5-Stud Hub Kit (1250#), 1" x 1", with Lug Nuts #81080 4
- 56895** 5-Stud Hub Kit (1350#), 1 1/16" x 1 1/16", with Lug Nuts #81085 4
- 748032** 5-Stud UHI Hub Kit (1750#), 1 1/16" x 1 3/8", with Lug Nuts #81090 4

### TIE DOWN ENGINEERING INNOVATIVE BRAKE ACTUATOR FOR DRUM BRAKE - 6600 LBS. CAPACITY

#### IMPORTANT FEATURES:

- Pre-loaded Dampener Unit** • No longer will you be required to "pump" the dampener first before bleeding the brakes. All TDE actuators now have a pre-loaded dampener.
- Quick Latch Coupler** • The coupler in the closed (tow) latch position will auto-latch onto the hitch ball when set on top of the hitch ball, with minimal weight. Incorrect latching and/or forgetting to properly close the latch mechanism is the #1 reason for trailer separation from the tow vehicle.
- Universal Latch Position** • All new coupler latches are latched in the "down" position.
- Cast Steel Latch Handle** • Can't break, looks great!
- Solenoid Plumbing Built Into The Master Cylinder.** This UNIQUE feature eliminates the following:
  - Removal of entire solenoid for servicing
  - Detachment of brake hose
  - Detachment of the actuator cover
  - Detachment of actuator unit from trailer tongue.
- Larger Fill Cap On Master Cylinder**
  - Common filler cap easier to maintain spare parts. Easy to remove, easier to add brake fluid.
- Standard Length Actuator Cover** • New housing covers the solenoid (when used) similar to the previous "3/4 extended" model.
- Additional Features:**
  - Cast steel ball clamp
  - Safety pin that locks the ball clamp, not the latch handle
  - Aluminum master cylinder
  - Coiled E-stop cable, PVC coated
  - Grease fittings on roller pins.

**50098** **NEW!** Brake Actuator Model 660 – Drum Brake #82401 1

**56902** LS Brake Actuator Model 660 – Surge Brake #86167 1



**DEXTER AXLE HUB COVERS**

For 3500 lb. axle capacity.

Hub Cover for 15" Wheel, 5 - 4.50 Bolt Circle:

**34320** Black #016-044-00 12

**34321** Chrome #K71-364-00 12

Hub Cover for 16" Wheel, 6- 5.50 Bolt Circle:

**34322** Chrome #K71-311-00 12



**TIE DOWN ENGINEERING PRECISION TAPERED ROLLER BEARINGS**

Each kit includes: 2 cones, 2 cups, seal, cotter pin and dust cap.

Bearings w/ Dust Cap:

**50238** 3/4" #81106 12

**50240** 1" #81111 12

**50242** 1-1/16" #81116 12

**50243** 1-1/4" #81126 12

Tapered Bearings w/ Dust Cap:

**50237** <sup>LS</sup> 1-1/16" x 3/4" #81121 1

**50245** <sup>LS</sup> 1-1/4" x 3/4" #81131 12

**50246** 1-3/8" x 1-1/16" #81141 12



**DUST CAPS**

Zinc-plated for corrosion protection. Pk/2.

**54885** Hub Dust Cap, Dia.: 1.98, 3/4" Outer Bearing LM11949 #81167 12

**BEARING BUDDY II — WITH BRA!**

The ultimate bearing protector with the added feature of "Auto Check: Visual Lubricant and Pressure Indicator." This updated version of Bearing Buddy has a spring loaded piston behind the Auto Check ring that pushes against the grease which generates pressure inside the hub to keep water out. If the lubricant is low, the blue Auto Check ring will recede until it is flush with the steel-retaining ring. Add a small amount of grease to move the blue ring outward about 1/8". It's that simple! Fits outer bearing cone numbers: L44643, L44649, and L44640.



**38505** Bearing Buddy II with Bra, Model 1980A #42201 60



**THE BEARING BUDDY BRA**

The Bearing Buddy Bra is specifically designed to keep grease off trailer wheels. Any attempt to overfill axle hubs with grease causes the Bearing Buddy automatic pressure relief feature to operate. If an excessive amount of grease escapes, it can be thrown on the wheels during trailering. The installation of the Bra over the Bearing Buddy eliminates this condition.

**38509** Bra for Bearing Buddy Models 42101, 42301, 07247, Pair #70019 g

**38508** Bra for Bearing Buddy Models 41201, 41101, Pair #70017 g

**38510** Bra for Bearing Buddy Models 43101, 2441, 2717, Pair #70023 g

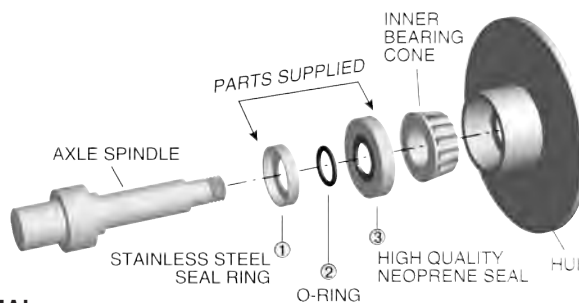

**SPINDO® SEAL**

For use with Bearing Buddy on trailer axles with brakes, or as a replacement system. A high-quality seal system designed to end grease leakage. Seals will last many years because they ride on a permanently smooth surface, constantly greased by the action of the Bearing Buddy. Pairs.

Order #	Model #	Use with Bearing Buddy Model No.	OR If Inner Bearing Bearing Cone No. Is:
<b>745443</b>	1	1980	L44643
<b>759262</b>	2	1980, 1968, 2562	LM48548; L68149
<b>759265</b>	5	1980	L44649
<b>38556</b>	LS 11	2441	25580



**CRC® BRAKLEEN® NON-CHLORINATED BRAKE PARTS CLEANER - 50 STATE FORMULA**

Removes brake fluid, grease, oil, and other contaminants quickly and effectively. Cleans & degreases brake parts, linings, calipers, drums and more! Extremely flammable. Applications: ABS, disc, drum brake cylinders, brake drums, brake linings, brake shoes, calipers, clutch discs, disc brake pads, discs. Safe for use on all brake systems including: springs & wedge brakes.

**44833** Brake Parts Cleaner - 50 State Formula, 14-oz. can *Not for sale in Canada* #05054 12

